



*jordan fishwick*

**DIDSBURY**  
School Lane



## School Lane, Didsbury, M20 6WL

Guide Price £275,000



### The Property

A traditional, two double bedroom terrace property enjoying an ideal location which is within a short stroll of the Metrolink and Didsbury Village, offering spacious living space over 1,000 sq ft. The competitive asking price does reflect the need for a programme of modernising, with the accommodation in outline comprising: Entrance lobby, spacious living room, fitted kitchen with access to rear, two generous bedrooms and bathroom with four piece suite. Outside, there is an enclosed paved garden at the rear. The property also benefits from gas central heating and double glazing. NO ONWARD CHAIN

### Directions

M20 6WL

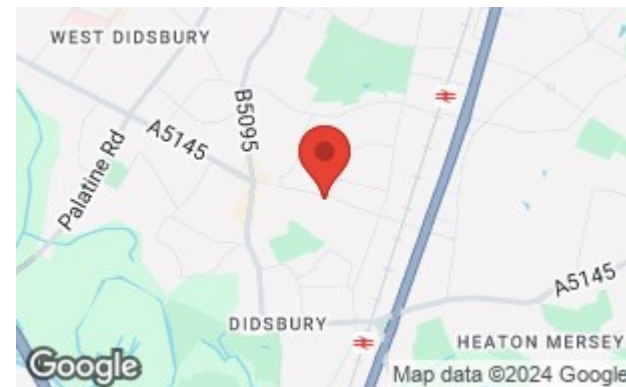

- Generous living space over 1,000 sq ft
- Traditional terrace property
- Two double bedrooms
- Living room over 22 ft
- Fitted kitchen & bathrom
- GCH & double glazing
- Front lobby
- Enclosed paved yard
- Close to Didsbury Village
- No onward chain

Postcode - M20 6WL

EPC Rating - C

Floor Area - 1023.00 sq ft

Local Authority - Manchester City Council

Council Tax - C



GROUND FLOOR  
566 sq.ft. (52.6 sq.m.) approx.

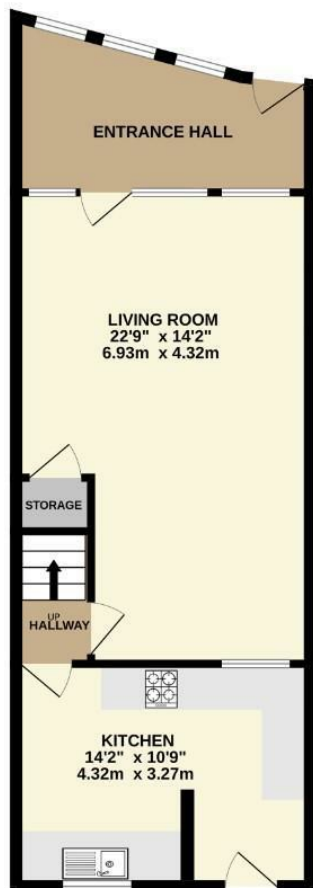

1ST FLOOR  
457 sq.ft. (42.4 sq.m.) approx.



TOTAL FLOOR AREA: 1023 sq.ft. (95.0 sq.m.) approx.  
Measurements are approximate. Not to scale. Illustrative purposes only.  
Made with Metropix ©2024



These particulars are believed to be accurate but they are not guaranteed and do not form a contract. Neither Jordan Fishwick nor the vendor or lessor accept any responsibility in respect of these particulars, which are not intended to be statements or representations of fact and any intending purchaser or lessee must satisfy himself by inspection or otherwise as to the correctness of each of the statements contained in these particulars. Any floorplans on this brochure are for illustrative purposes only and are not necessarily to scale.

Offices also at: Wilmslow, Macclesfield, Hale, Sale, Chorlton, Glossop, Manchester & Salford

757-759 Wilmslow Road, Didsbury Village, Manchester

0161 445 4480

didsbury@jordanfishwick.co.uk  
www.jordanfishwick.co.uk