



jordan fishwick

WILMSLOW
Newbury Court



Newbury Court, Wilmslow, SK9 5JD

£895 PCM



The Property

PART FURNISHED AVAILABLE NOW

A first floor apartment ideally located for local shops and within easy walking distance of Wilmslow town centre and the train station.

Having just been updated with a new kitchen having just been installed along with new flooring this apartment also benefits from off road parking and a pleasant sunny communal garden.

Communal entrance hall, private entrance hall with storage, lounge, fully fitted kitchen with electric hob and oven, fridge and washing machine. Double bedroom with mirrored wardrobes. Bathroom with shower.

Communal gardens. Electric heating

Contact Wilmslow 01625 536300. £895.00pcm

COUNCIL TAX A

EPC C

Directions

SK9 5JD



- FIRST FLOOR
- ONE BEDROOM APARTMENT
- MODERN FITTED KITCHEN
- ELECTRIC HEATING
- WALKING DISTANCE OF TOWN CENTRE AND TRAIN STATION
- COUNCIL TAX A
- EPC C

Postcode - SK9 5JD

EPC Rating - C

Floor Area - sq ft

Local Authority - Cheshire East Council

Council Tax - A



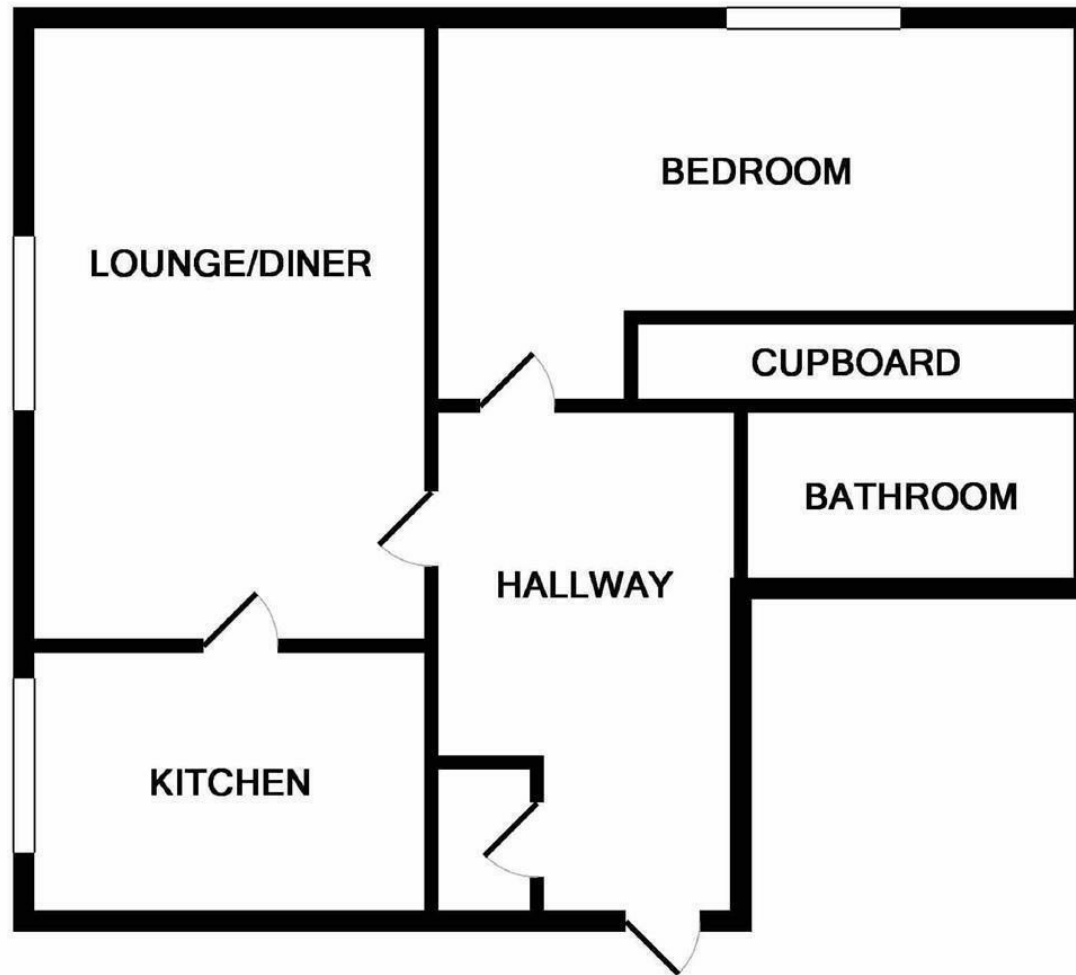

Measurements are approximate. Not to scale. Illustrative purposes only
Made with Metropix ©2019



These particulars are believed to be accurate but they are not guaranteed and do not form a contract. Neither Jordan Fishwick nor the vendor or lessor accept any responsibility in respect of these particulars, which are not intended to be statements or representations of fact and any intending purchaser or lessee must satisfy himself by inspection or otherwise as to the correctness of each of the statements contained in these particulars. Any floorplans on this brochure are for illustrative purposes only and are not necessarily to scale.

Offices at: Chorlton, Didsbury, Disley, Hale, Glossop, Macclesfield, Manchester Deansgate,
Manchester Whitworth Street, New Mills, Sale, Wilmslow and Withington

01625 536300

wilmslow@jordanfishwick.co.uk
www.jordanfishwick.co.uk