



jordan fishwick

FALLOWFIELD
Horton Road



Horton Road, Fallowfield, M14 7GD

Offers Over £180,000



The Property

A spacious, garden fronted 2 double bedroom terrace property IN NEED OF UPDATING, suitable for a number of buyers including first time buyer or professional couple, well placed for Manchester City centre with excellent transport links in a quiet location. The accommodation comprises: Entrance hall, lounge, separate dining room and kitchen. To the first floor: Master bedroom with twin windows to the front, additional double bedroom and bathroom. Electric heating is installed, although gas is supplied to the property and majority double glazing is installed. There is a courtyard garden to the rear of the property. Viewing is recommended. No chain.

Directions

M14 7GD

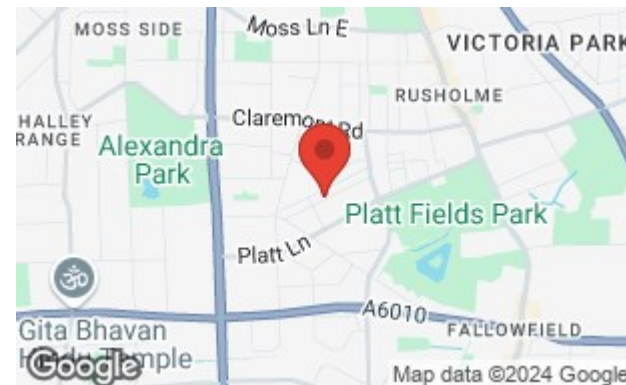

- A two bed garden fronted mid terrace property
- In need of updating
- Two reception rooms
- Enclosed courtyard to rear
- Majority double glazed
- Popular residential area
- No chain

Postcode - M14 7GD

EPC Rating - F

Floor Area - 713.00 sq ft

Local Authority - Manchester City Council

Council Tax - A



GROUND FLOOR
384 sq.ft. (35.6 sq.m.) approx.

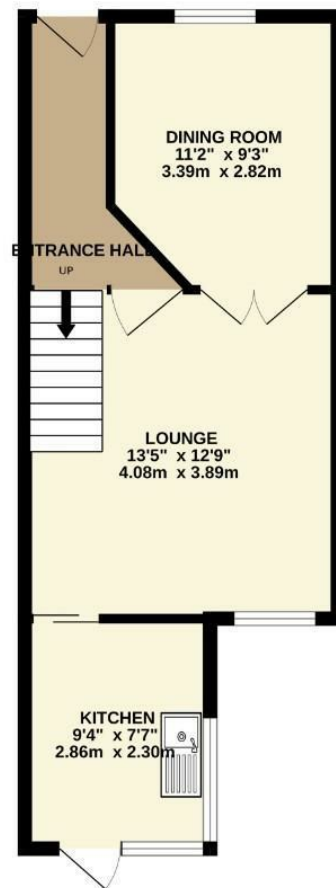

1ST FLOOR
330 sq.ft. (30.6 sq.m.) approx.

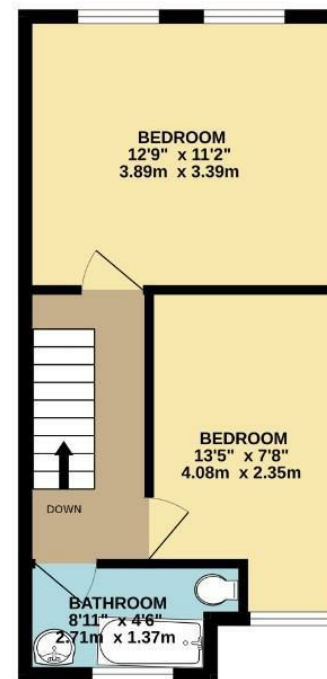

TOTAL FLOOR AREA: 713 sq.ft. (66.3 sq.m.) approx.
Measurements are approximate. Not to scale. Illustrative purposes only.
Made with Metropix ©2024



These particulars are believed to be accurate but they are not guaranteed and do not form a contract. Neither Jordan Fishwick nor the vendor or lessor accept any responsibility in respect of these particulars, which are not intended to be statements or representations of fact and any intending purchaser or lessee must satisfy himself by inspection or otherwise as to the correctness of each of the statements contained in these particulars. Any floorplans on this brochure are for illustrative purposes only and are not necessarily to scale.

Offices also at: Wilmslow, Macclesfield, Hale, Sale, Chorlton, Glossop, Manchester & Salford

757-759 Wilmslow Road, Didsbury Village, Manchester

0161 445 4480

didsbury@jordanfishwick.co.uk
www.jordanfishwick.co.uk