

Whilst every attempt has been made to ensure the accuracy of the floorplan contained here, measurements of doors, windows, rooms and other items are approximate and no responsibility is taken for any error, omission or mis-statement. This plan is for illustrative purposes only and should be used as such by any prospective purchaser. The services, systems and appliances shown have not been tested and no guarantee as to their operation or efficiency can be given. Made with Metropix, ©2024

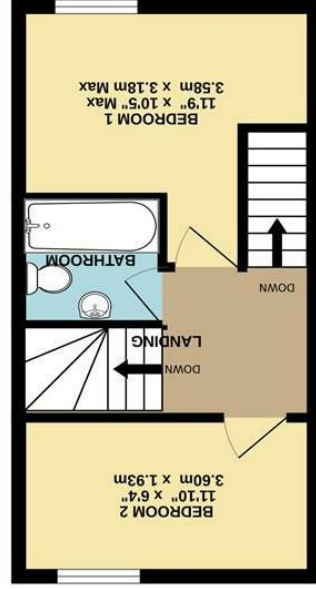

GROUND FLOOR



1ST FLOOR

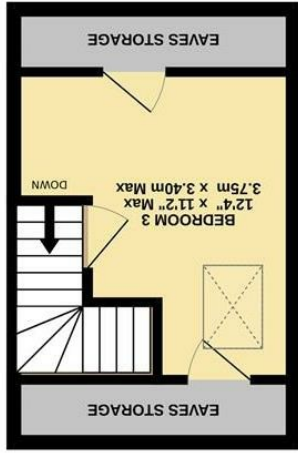

2ND FLOOR



147 Hayfield Road, Birch Vale,
High Peak, SK22 1DF

£260,000



The Property

A well presented three bedroom stone built mid-terrace property in the semi rural location of Birch Vale, with beautiful open aspect views to the rear. The property has been well maintained by the current owner and in brief comprises of: Front reception room with log burner, kitchen/diner with exposed brick featured wall and access to a utility area. To the first floor are two good sized double bedrooms with space for furnishings, whilst the loft conversion provides a third double bedroom and eaves storage on either side offering plenty of storage space. The property in recent years been improved by newly fitted PVC double glazing in 2018 and is also warmed by a gas central heating boiler. To the rear of the property is a small wooden decked area accessed off the utility room, this leads to a private and enclosed paved seating area where views of the beautiful open countryside can be truly appreciated.



- Three Bedroom Property
- Mid-Stone Terrace
- Over Three Floors
- Dining Kitchen
- Utility Room
- Open Aspect Rear Views
- Log Burning Stove
- Eaves Storage

Postcode - SK22 1DF
EPC Rating - D
Local Authority - High Peak Council
Council Tax - B

