



TO LET

Apt 12 Sandringham Court, 2a Maple Road West, Brooklands, Sale, M23 9QT
£1,100 Per Calendar Month pcm

- AVAILABLE LATE NOVEMBER
- 2 Bed Top Floor Apartment
- TWO DOUBLE BEDROOMS
- Part furnished
- Fully fitted kitchen
- Garage
- Tax Band C
- EPC Rating E
- Good location

THE PROPERTY

Available Late November, Jordan Fishwick are pleased to bring to the rental market A MODERN TWO DOUBLE BED APARTMENT, Top floor accommodation is accessed via a communal entrance hallway with intercom, a spacious entrance hall which leads to two double bedrooms, stylish bathroom suite with shower over the bath. Good size storage cupboard. A magnificent lounge diner leads out to balcony. A modern fully fitted kitchen with appliances. Garage TAX BAND C - EPC E

GROUND FLOOR
755 sq.ft. (70.1 sq.m.) approx.

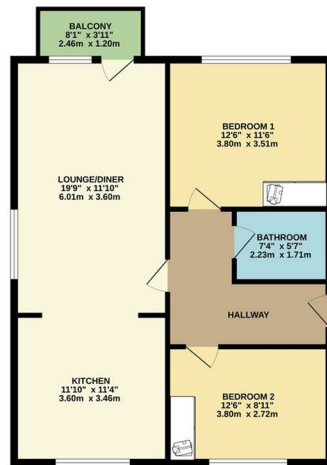

TOTAL FLOOR AREA: 755 sq.ft. (70.1 sq.m.) approx.
Measurements are approximate. Not to scale. Dependent on project size.
Made with SketchUp 2024

Energy Efficiency Rating

	Current	Potential
<i>Very energy efficient - lower running costs</i>		
(92 plus) A		
(81-91) B		
(69-80) C		76
(55-68) D		
(39-54) E	41	
(21-38) F		
(1-20) G		
<i>Not energy efficient - higher running costs</i>		
England & Wales	EU Directive 2002/91/EC	