

*Jordan* fishwick

19 SUMMERFIELD VILLAGE COURT RINGSTEAD  
Guide Price £192,500

## 19 SUMMERFIELD VILLAGE COURT RINGSTEAD DRIVE WILMSLOW SK9 2TG

Located within Summerfield Village Court this two double bedroom top floor (second floor) apartment is located a short drive away from Wilmslow centre. Wilmslow offers a wide range of shopping facilities, bars, restaurants, leisure centre and Wilmslow station which allows easy direct access to London Euston and Manchester City centre. The accommodation comprises a communal hallway and staircase leading to all floors and a private hallway with useful storage cupboard giving access to a further inner hallway. This inner hallway leads to the two double bedrooms, the large reception room and has a second large storage cupboard. The apartment is UPVC double glazed throughout and there is a generously proportioned living and dining room which is complemented by a bay window to the front aspect. Additionally there is a modern four-piece suite bathroom with bath and separate shower enclosure. The kitchen is fitted with modern matching wall and base mounted units with a practical breakfast bar. There is a modern gas combination boiler. Locally there are a wide choice of schools, alongside beautiful countryside. The property is well presented throughout with viewings essential to appreciate.



GROUND FLOOR

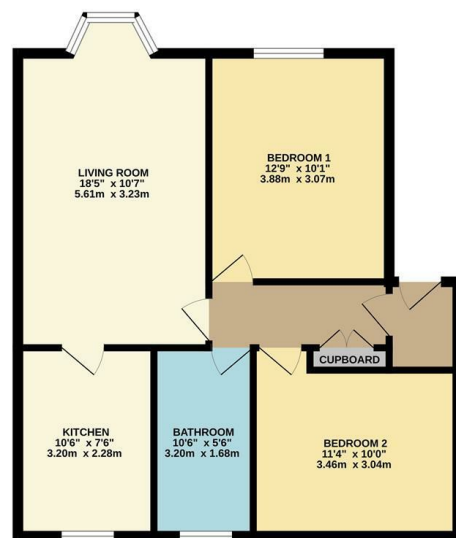

Measurements are approximate. Not to scale. Suitable purposes only. Made with Metric 0202



- Top Floor Apartment
- Two Bedrooms
- Modern Kitchen
- Modern gas combination boiler
- Modern bathroom
- Bath and Separate shower
- Residents parking

Energy Efficiency Rating		Environmental Impact (CO <sub>2</sub> ) Rating			
Very energy efficient - lower running costs	Current	Potential	Very environmentally friendly - lower CO <sub>2</sub> emissions	Current	Potential
(92 plus) A			(92 plus) A		
(81-91) B			(81-91) B		
(69-80) C			(69-80) C		
(55-68) D			(55-68) D		
(39-54) E			(39-54) E		
(21-38) F			(21-38) F		
(1-20) G			(1-20) G		
Not energy efficient - higher running costs			Not environmentally friendly - higher CO <sub>2</sub> emissions		
England & Wales	EU Directive 2002/91/EC	75	England & Wales	EU Directive 2002/91/EC	80