



*jordan fishwick*

5 Broomfield Close, SK9 2NL  
PCM £1,450 PCM





## Broomfield Close WILMSLOW

£1,450 PCM



### AVAILABLE NOW PART FURNISHED

Located on this quiet cul de sac and on the ever popular Summerfields Estate within walking distance of the town centre and train station, this three bedroom semi detached has just undergone a programme of refurbishment. With an enclosed rear garden and off road parking along with a modern kitchen and bathroom this property is an ideal choice for the professional couple or small family.

Entrance porch with storage, open plan lounge diner with breakfast bar, modern fitted kitchen with space for fridge and freezer, washing machine and dishwasher (appliances can be fitted if required) and door to enclosed rear garden with shed.

To the first floor two double bedrooms and single bedroom, bathroom with shower over bath. Off road parking, Gas central heating.

Contact Wilmslow 01625 536300 £1450.00pcm

COUNCIL TAX CV

EPC C







- SEMI DETACHED
- POPULAR LOCATION
- ENCLOSED REAR GARDEN
- OFF ROAD PARKING
- THREE BEDROOMS
- COUNCIL TAX C
- EPC C



Energy Efficiency Rating		
	Current	Potential
Very energy efficient - lower running costs		
(92 plus) <b>A</b>		
(81-91) <b>B</b>		<b>87</b>
(69-80) <b>C</b>	<b>72</b>	
(55-68) <b>D</b>		
(39-54) <b>E</b>		
(21-38) <b>F</b>		
(1-20) <b>G</b>		
Not energy efficient - higher running costs		
<b>England &amp; Wales</b>	EU Directive 2002/91/EC	



GROUND FLOOR

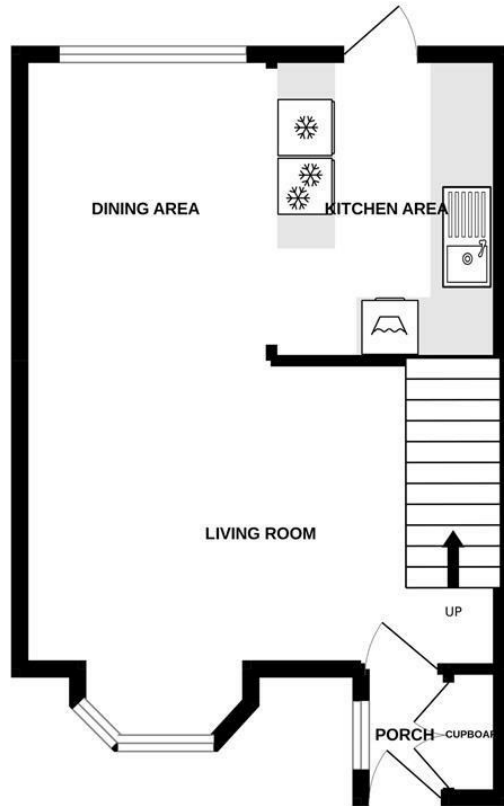

1ST FLOOR

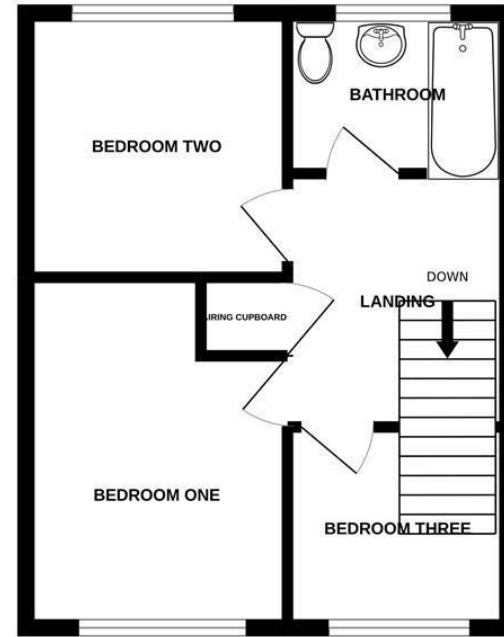

Measurements are approximate. Not to scale. Illustrative purposes only  
Made with Metropix ©2022



These particulars are believed to be accurate but they are not guaranteed and do not form a contract. Neither Jordan Fishwick nor the vendor or lessor accept any responsibility in respect of these particulars, which are not intended to be statements or representations of fact and any intending purchaser or lessee must satisfy himself by inspection or otherwise as to the correctness of each of the statements contained in these particulars. Any floorplans on this brochure are for illustrative purposes only and are not necessarily to scale.

Offices at: Chorlton, Didsbury, Disley, Hale, Glossop, Macclesfield, Manchester Deansgate, Manchester Whitworth Street, New Mills, Sale, Wilmslow and Withington

01625 536300

wilmslow@jordanfishwick.co.uk  
www.jordanfishwick.co.uk