



jordan fishwick

ALTRINCHAM
Bold Street



Bold Street, Altrincham, WA14 2ER

£1,650 PCM



The Property

*** AVAILABLE DECEMBER *** Bold Street, ALTRINCHAM - Beautifully presented 2 bedroom terrace on the ever popular B Streets. Ideally located within walking distance of both Hale and Altrincham with amenities on your doorstep including train line, metro link, shops, bars and restaurants. Modern paved entrance, immaculate interior with high quality fixtures and fittings throughout including fabulous plantation shutters. Feature tiling in the hallway, contemporary kitchen fitted with high spec integrated appliances. Hard wood flooring in the Lounge/Diner with a stunning feature fireplace and large storage room. Upstairs you find 2 double bedrooms with Hard wood flooring, modern bathroom with free standing roll top bath and separate walk in shower. Externally there is courtyard with modern paving. The property has a high spec security alarm and is available December. Part furnished. Please contact the Hale office to arrange viewing. 0161 929 9797 option 3.

Directions

WA14 2ER



- TERRACE
- TWO BEDROOMS
- CENTRAL LOCATION
- MODERN INTERIOR
- PERMIT PARKING
- COUNCIL TAX BAND C
- EPC RATING E

Postcode - WA14 2ER

EPC Rating - E

Floor Area - sq ft

Local Authority - TRAFFORD

Council Tax - C



GROUND FLOOR

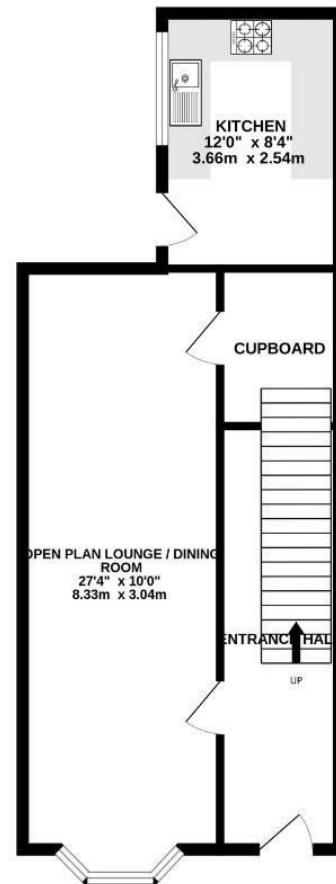

1ST FLOOR



Whilst every attempt has been made to ensure the accuracy of the floorplan contained here, measurements of doors, windows, rooms and any other items are approximate and no responsibility is taken for any error, omission or mis-statement. This plan is for illustrative purposes only and should be used as such by any prospective purchaser. The services, systems and appliances shown have not been tested and no guarantee as to their operability or efficiency can be given.
Made with Metropix ©2024



These particulars are believed to be accurate but they are not guaranteed and do not form a contract. Neither Jordan Fishwick nor the vendor or lessor accept any responsibility in respect of these particulars, which are not intended to be statements or representations of fact and any intending purchaser or lessee must satisfy himself by inspection or otherwise as to the correctness of each of the statements contained in these particulars. Any floorplans on this brochure are for illustrative purposes only and are not necessarily to scale.

Offices at: Chorlton, Didsbury, Disley, Hale, Glossop, Macclesfield, Manchester Deansgate, Manchester Whitworth Street, New Mills, Sale, Wilmslow and Withington

0161 929 9797

hale@jordanfishwick.co.uk
www.jordanfishwick.co.uk