



*Jordan fishwick*

1B Hesketh Avenue, M20 2QB  
£1,250 Per Calendar Month



**Hesketh Avenue Didsbury  
M20 2QB**

**£1,250 Per Calendar Month**



### The Property

\*\*\* AVAILABLE OCTOBER \*\*\* A well-presented two-bedroom top floor apartment situated in a convenient location in Didsbury Village. Only a short walk to the Metrolink and local bars & shops making it ideal for a single occupant, couple or professional sharers. The accommodation briefly comprises; communal entrance & staircase, private entrance hall, excellent sized lounge/dining room, modern kitchen with range of fitted appliances, two double bedrooms with the smaller room housing a wardrobe only and a modern bathroom with white suite. Available unfurnished. Contact Didsbury on 0161 434 5290 to arrange a viewing.

EPC Rating - C

- Available October
- Two Bedrooms
- Unfurnished
- Large Lounge / Dining
- Ideal for Couples or Sharers
- Great Location of Didsbury
- Close to all Amenities & Transport Links
- Parking
- Council Tax Band B
- EPC Rating C



Energy Efficiency Rating		
	Current	Potential
Very energy efficient - lower running costs		
(92 plus) <b>A</b>		
(81-91) <b>B</b>		
(69-80) <b>C</b>	<b>69</b>	<b>74</b>
(55-68) <b>D</b>		
(39-54) <b>E</b>		
(21-38) <b>F</b>		
(1-20) <b>G</b>		
Not energy efficient - higher running costs		
<b>England &amp; Wales</b>	EU Directive 2002/91/EC 	



GROUND FLOOR  
581 sq.ft. (54.0 sq.m.) approx.

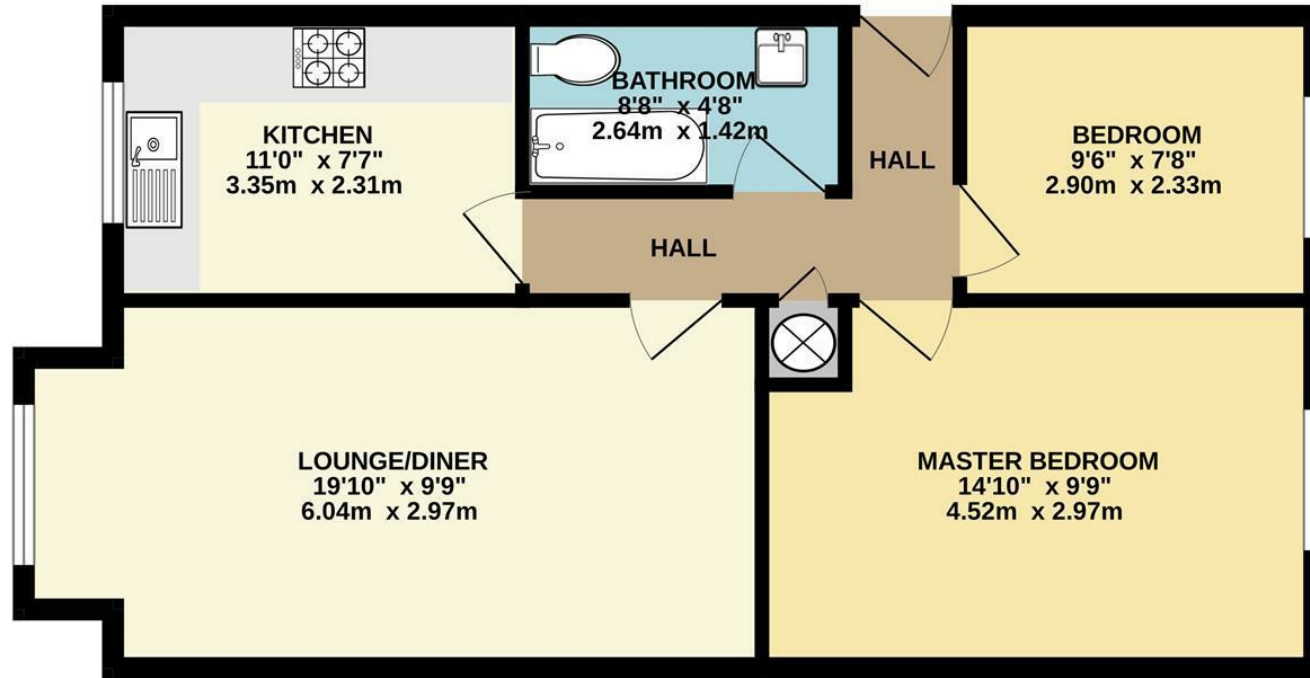

TOTAL FLOOR AREA : 581 sq.ft. (54.0 sq.m.) approx.  
Measurements are approximate. Not to scale. Illustrative purposes only  
Made with Metropix ©2024



These particulars are believed to be accurate but they are not guaranteed and do not form a contract. Neither Jordan Fishwick nor the vendor or lessor accept any responsibility in respect of these particulars, which are not intended to be statements or representations of fact and any intending purchaser or lessee must satisfy himself by inspection or otherwise as to the correctness of each of the statements contained in these particulars. Any floorplans on this brochure are for illustrative purposes only and are not necessarily to scale.

Offices at: Offices at Chorlton, Didsbury, Disley, Hale, Glossop, Macclesfield, Manchester Deansgate, Manchester Whitworth Street, New Mills, Sale, Wilmslow and Withington