



FOR SALE  
jordan fishwick  
01753 611111  
www.jordanfishwick.co.uk

jordan fishwick

# 18 Ridge Close, Hadfield, Glossop, Derbyshire, SK13 2EA

Standing in enclosed South Westerly facing gardens and enjoying a cul-de-sac position, this modernised, 1960's built, detached true bungalow is offered for sale with No Onward Chain. Briefly comprising an entrance hall, generous living room, a fitted kitchen with integrated appliances, two double bedrooms and refitted bathroom with separate shower. Front garden, driveway and attached garage. Energy Rating

## Offers In The Region Of £325,000

### Viewing arrangements

Viewing strictly by appointment through the agent

44 High Street West, Glossop, Derbyshire, SK13 8BH 01457 858888

### Directions

From our office proceed through the traffic lights, two roundabouts and along Dinting Vale. Continue through the next set of traffic lights and at the second set turn right into Shaw Lane. Follow the road round, turn left into Green Lane and left again into Lower Barn Road. Follow the road round to the left and turn left again into Ridge Close and the bungalow is on the right hand side.

### GROUND FLOOR

#### Entrance Hall

#### Living Room

16'11 x 12'7

#### Kitchen

10'8 x 9'0

#### Bedroom One

13'9 x 11'8

#### Bedroom Two

11'4 x 8'3 (plus door recess)

#### Bathroom

### OUTSIDE

#### Attached Garage

16'6 x 10'6

#### Gardens

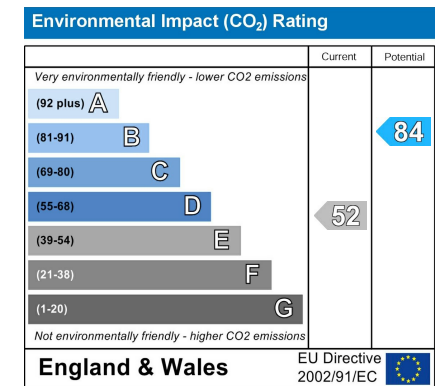
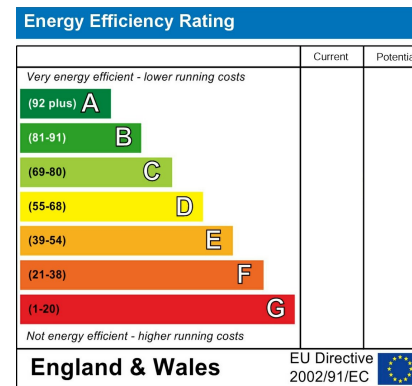



## Ground Floor

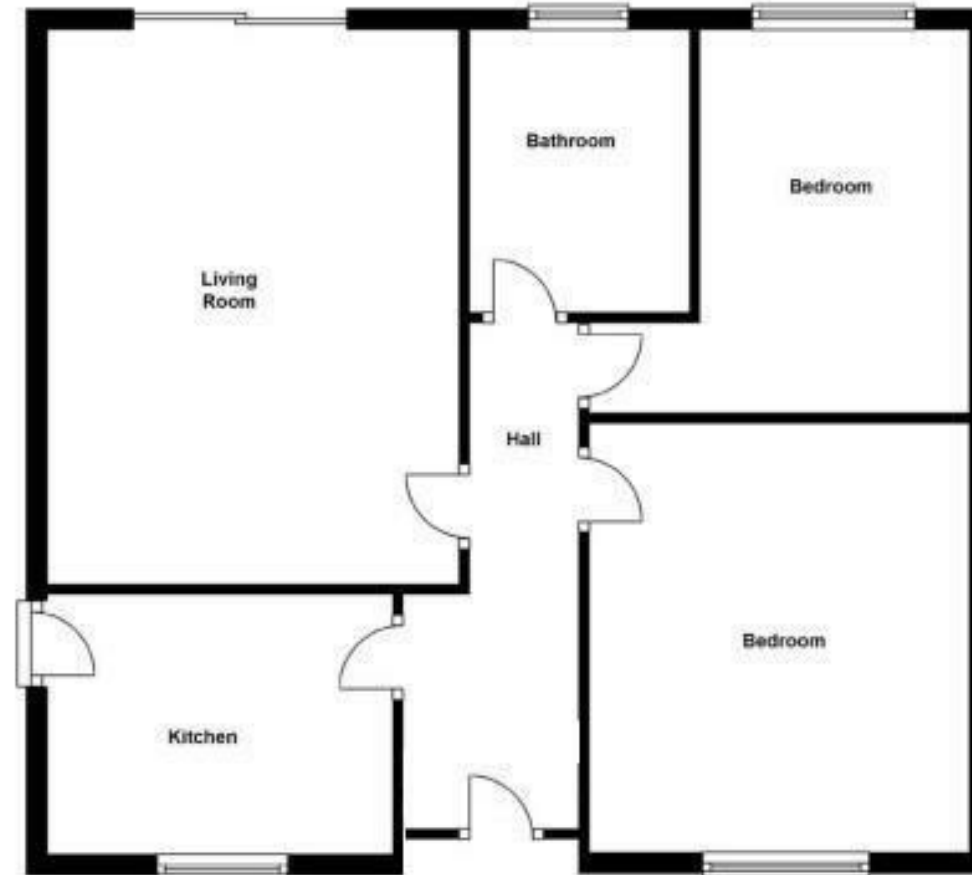

Whilst every attempt has been made to ensure the accuracy of this floor plan, all measurements of doors, windows, rooms and any other items are approximate and no responsibility is taken for any error, omission, or mis-statement. This plan is for illustrative purposes only and should only be used as such by any prospective purchaser/tenant  
Plan produced using PlanUp.



These particulars are believed to be accurate but they are not guaranteed and do not form a contract. Neither Jordan Fishwick nor the vendor or lessor accept any responsibility in respect of these particulars, which are not intended to be statements or representations of fact and any intending purchaser or lessee must satisfy himself by inspection or otherwise as to the correctness of each of the statements contained in these particulars. Any floorplans on this brochure are for illustrative purposes only and are not necessarily to scale.

Offices at: Chorlton, Didsbury, Disley, Hale, Glossop, Macclesfield, Manchester Deansgate, Manchester Whitworth Street, New Mills, Sale, Wilmslow and Withington

44 High Street West, Glossop, Derbyshire, SK13 8BH

01457 858888

[glossop@jordanfishwick.co.uk](mailto:glossop@jordanfishwick.co.uk)  
[www.jordanfishwick.co.uk](http://www.jordanfishwick.co.uk)

