



jordan fishwick

Laneside Road New Mills High Peak

Laneside Road New Mills High Peak SK22 4LX

Price £195,000



The Property

Situated on a popular residential road with easy access into open countryside and offering no onward chain a charming two bedroom property. Briefly comprising; entrance vestibule leading into living room with beamed ceiling and cast iron fireplace, dining kitchen with quarry tiled floor, to the first floor there are two bedrooms and bathroom with white suite. Externally there is a walled garden to the front and a pleasant rear garden with a good degree of privacy.



- Charming Two Bedroom mid Terrace Cottage
- Living Room with Beamed Ceiling and Cast Iron Fireplace
- Dining Kitchen with Quarry Tiled Floor
- White Bathroom Suite
- Pleasant Private Rear Garden
- Pvc Double Glazing and Valliant Central Heating Boiler
- No Onward Chain
- Lovely Rear Views Over Adjoining Countryside

Postcode SK22 4LX

EPC Rating C

Local Authority High Peak Borough Council

Council Tax B

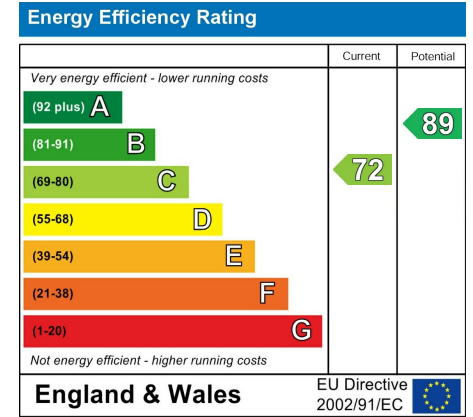

GROUND FLOOR

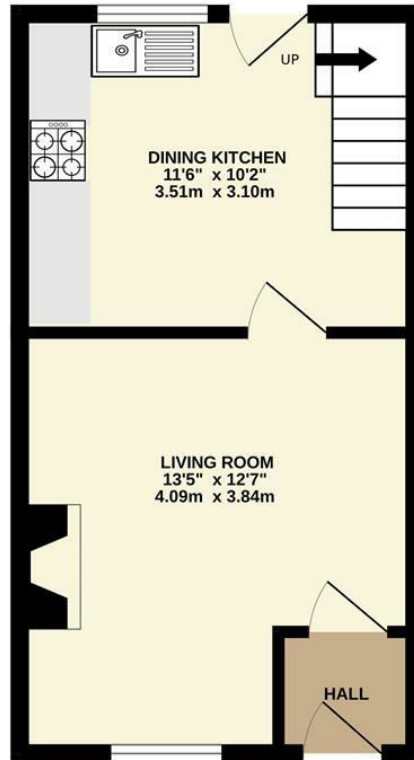

1ST FLOOR

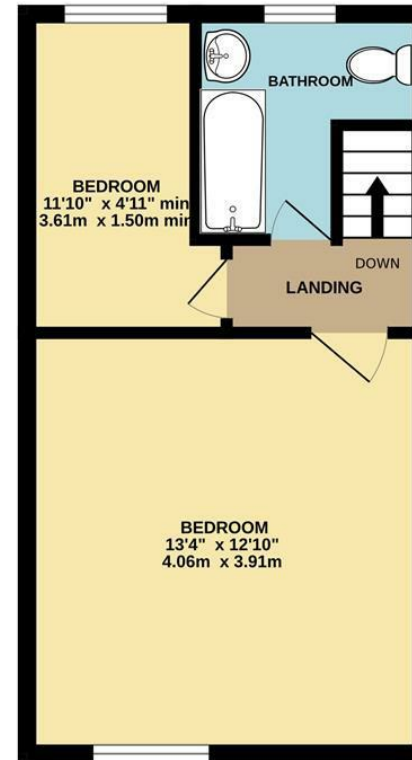

Whilst every attempt has been made to ensure the accuracy of the floorplan contained here, measurements of doors, windows, rooms and any other items are approximate and no responsibility is taken for any error, omission or mis-statement. This plan is for illustrative purposes only and should be used as such by any prospective purchaser. The services, systems and appliances shown have not been tested and no guarantee as to their operability or efficiency can be given.
Made with Metropix ©2024



These particulars are believed to be accurate but they are not guaranteed and do not form a contract. Neither Jordan Fishwick nor the vendor or lessor accept any responsibility in respect of these particulars, which are not intended to be statements or representations of fact and any intending purchaser or lessee must satisfy himself by inspection or otherwise as to the correctness of each of the statements contained in these particulars. Any floorplans on this brochure are for illustrative purposes only and are not necessarily to scale.

Offices at: Chorlton, Didsbury, Disley, Hale, Glossop, Macclesfield, Manchester Deansgate, Manchester Whitworth Street, New Mills, Sale, Wilmslow and Withington

2 Union Road, New Mills, High Peak, Derbyshire, SK22 3ES

01663 767878

newmills@jordanfishwick.co.uk

www.jordanfishwick.co.uk