



*jordan fishwick*

**CHESHIRE**  
Barford Drive



# Barford Drive, Cheshire, SK9 2GB

£1,350 PCM



## The Property

AVAILABLE NOW PART FURNISHED - VIEWING ESSENTIAL  
Situating on the ever popular Villas estate this two double bedroom mid mews has the benefit of two double bedrooms, off road parking and a pleasant enclosed rear garden. Being close to local shops and with the A34 only a short drive away this modern property is also within walking distance of Wilmslow town centre and the train station. Entrance porch, well proportioned open plan living/dining room, French style doors to the rear garden and a fitted kitchen. The first floor accommodation comprises stairs/landing, two double bedrooms and a shower room. To the front of the property there is a driveway which provides off road parking and to the rear there is an enclosed garden.  
Contact Wilmslow 01625 536300 £1350.00pcm  
COUNCIL TAX C  
EPC C

## Directions

SK9 2GB



- POPULAR LOCATION
- TWO BEDROOMS
- ENCLOSED REAR GARDEN
- WALKING DISTANCE OF WILMSLOW AND TRAIN STATION
- COUNCIL TAX C
- EPC C

Postcode - SK9 2GB

EPC Rating - C

Floor Area - sq ft

Local Authority - Cheshire East Council

Council Tax - C



GROUND FLOOR

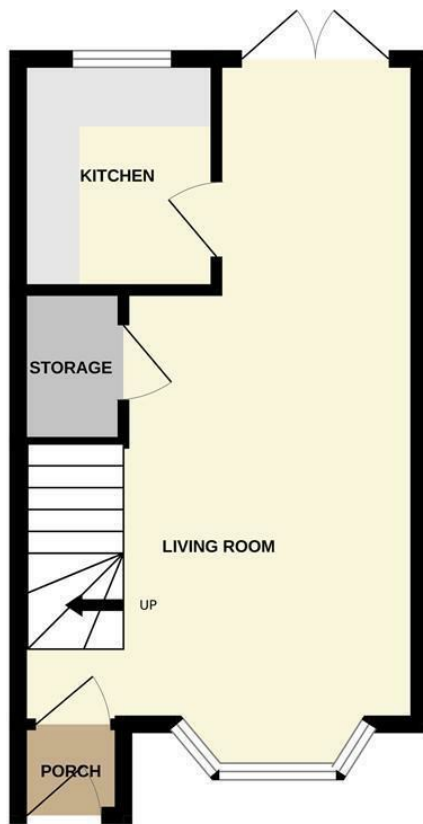

1ST FLOOR

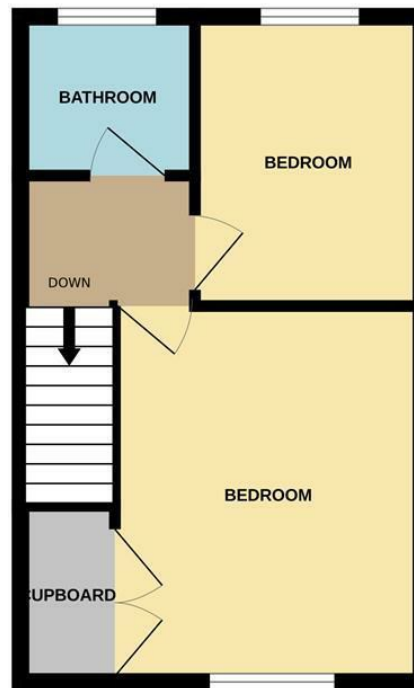

Measurements are approximate. Not to scale. Illustrative purposes only  
Made with MetroPix ©2023



These particulars are believed to be accurate but they are not guaranteed and do not form a contract. Neither Jordan Fishwick nor the vendor or lessor accept any responsibility in respect of these particulars, which are not intended to be statements or representations of fact and any intending purchaser or lessee must satisfy himself by inspection or otherwise as to the correctness of each of the statements contained in these particulars. Any floorplans on this brochure are for illustrative purposes only and are not necessarily to scale.

Offices at: Chorlton, Didsbury, Disley, Hale, Glossop, Macclesfield, Manchester Deansgate, Manchester Whitworth Street, New Mills, Sale, Wilmslow and Withington

01625 536300

wilmslow@jordanfishwick.co.uk  
www.jordanfishwick.co.uk