



*jordan fishwick*

Church Road New Mills High Peak



## Church Road New Mills High Peak SK22 4NJ

£299,950



### The Property

A charming property located on Church Road in the picturesque town of New Mills, High Peak. This end terrace house boasts original features, including an inglenook fireplace with a cosy wood-burning stove in the living room as well as a cast iron fireplace in the living room. Bursting with character including stripped polished floorboards and cornicing.

Beautifully presented interior that has been tastefully decorated throughout. The property offers not just one, but two reception rooms, providing ample space for entertaining or relaxing with family. Additionally, there is a large utility room, adding practicality to this lovely home.

With two spacious double bedrooms and a large loft room, there is plenty of room for a growing family or for guests to stay over. The stunning bathroom adds a touch of luxury to the property with separate walk in shower.

Outside, the property features enclosed rear gardens, one with lawn and established planting, the other with greenhouse and fruit trees. The location of this house provides a peaceful retreat from the hustle and bustle of city life, while still being conveniently located near local amenities.



- Stunning Property Full of Original Features
- Two Double Bedrooms Plus Large Loft Room
- Dining Room with Cast Iron Fireplace and Stripped Polished Floor
- Living Room with Inglenook Fireplace and Wood Burning Stove
- Large Utility/Garden Room
- Beautifully Presented Throughout
- Enclosed Rear Gardens

**Postcode** SK22 4NJ

**EPC Rating** D

**Local Authority** High Peak Borough

**Council Tax** C

Energy Efficiency Rating		Current	Potential
Very energy efficient - lower running costs			
(92 plus) A			
(81-91) B			82
(69-80) C		58	
(55-68) D			
(39-54) E			
(21-38) F			
(1-20) G			
Not energy efficient - higher running costs			
<b>England &amp; Wales</b>		EU Directive 2002/91/EC	



BASEMENT

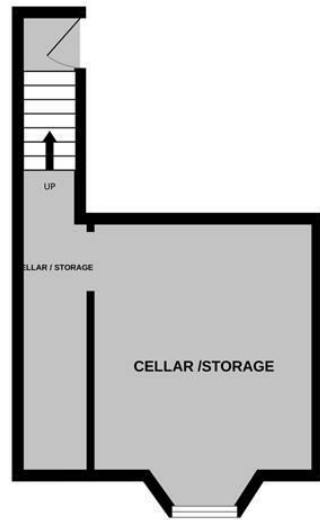

GROUND FLOOR

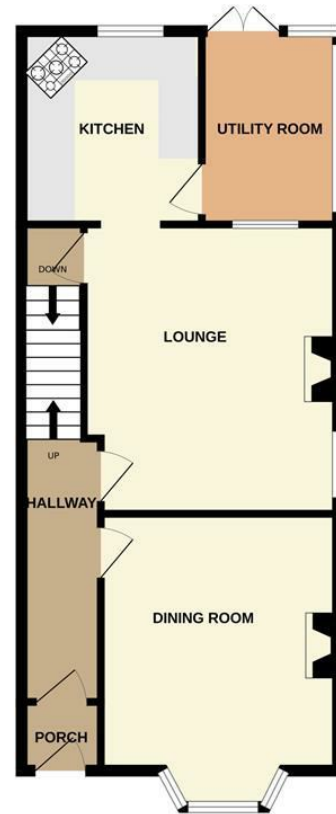

1ST FLOOR

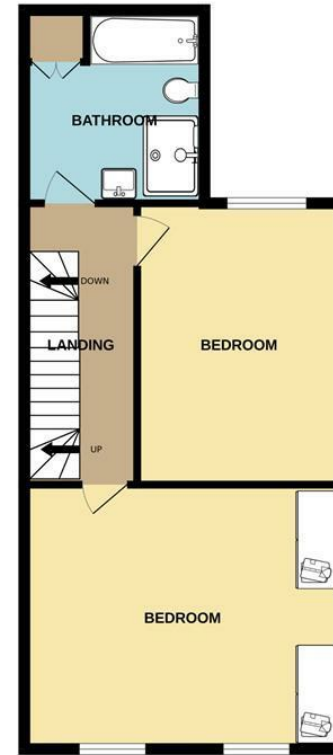

2ND FLOOR

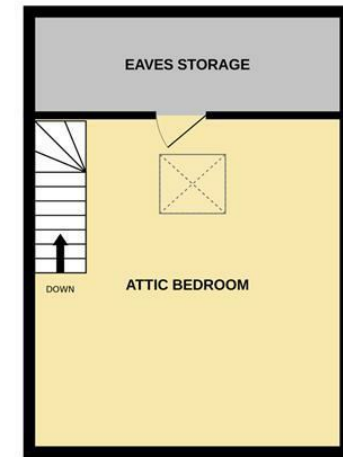

Whilst every attempt has been made to ensure the accuracy of the floorplan contained here, measurements of doors, windows, rooms and any other items are approximate and no responsibility is taken for any error, omission or mis-statement. This plan is for illustrative purposes only and should be used as such by any prospective purchaser. The services, systems and appliances shown have not been tested and no guarantee as to their operability or efficiency can be given.  
 Made with Metropix ©2024



These particulars are believed to be accurate but they are not guaranteed and do not form a contract. Neither Jordan Fishwick nor the vendor or lessor accept any responsibility in respect of these particulars, which are not intended to be statements or representations of fact and any intending purchaser or lessee must satisfy himself by inspection or otherwise as to the correctness of each of the statements contained in these particulars. Any floorplans on this brochure are for illustrative purposes only and are not necessarily to scale.

Offices at: Chorlton, Didsbury, Disley, Hale, Glossop, Macclesfield, Manchester Deansgate, Manchester Whitworth Street, New Mills, Sale, Wilmslow and Withington

2 Union Road, New Mills, High Peak, Derbyshire, SK22 3ES

01663 767878

[newmills@jordanfishwick.co.uk](mailto:newmills@jordanfishwick.co.uk)

[www.jordanfishwick.co.uk](http://www.jordanfishwick.co.uk)