



*jordan fishwick*

37 Chamberlain Drive, SK9 2SN  
PCM £900 PCM



# Chamberlain Drive Wilmslow

£900 PCM



FURNISHED AVAILABLE EARLY SEPTEMBER

\*\*\*\*\* COMPETITIVELY PRICED \*\*\*\* 6 MONTH LET ONLY \*\*\*\*\*

This first floor two double bedroom apartment was constructed via Jones Homes and is part of the later phases of build which produced a contemporary finish which must be viewed in order to fully appreciate.

Within easy walking distance of local shops and with the A34, Manchester International Airport and the motorway networks only a short drive away this spacious apartment is ideal for the single professional or couple.

Communal entrance hallway, entrance vestibule, private entrance hallway with storage, spacious light and airy living room, contemporary breakfast kitchen with gas hob and electric oven, fridge freezer and washing machine, two double bedrooms with fitted wardrobes and a three piece white bathroom suite.

The apartment also benefits from allocated parking and gas central heating.

Contact 01625 536300 £900.00pcm

COUNCIL TAX C

EPC B



- FIRST FLOOR APARTMENT
- TWO DOUBLE BEDROOMS
- HIGHLY POPULAR LOCATION
- AVAILABLE ON A SHORT TERM LET
- ALLOCATED PARKING
- WALKING DISTANCE OF LOCAL SHOPS
- COUNCIL TAX C
- EPC B



| Energy Efficiency Rating                    |                            |           |
|---|----------------------------|-----------|
|   | Current                    | Potential |
| Very energy efficient - lower running costs |                            |           |
| (92 plus) <b>A</b>                          |                            |           |
| (81-91) <b>B</b>                            | <b>82</b>                  | <b>83</b> |
| (69-80) <b>C</b>                            |                            |           |
| (55-68) <b>D</b>                            |                            |           |
| (39-54) <b>E</b>                            |                            |           |
| (21-38) <b>F</b>                            |                            |           |
| (1-20) <b>G</b>                             |                            |           |
| Not energy efficient - higher running costs |                            |           |
| <b>England &amp; Wales</b>                  | EU Directive<br>2002/91/EC |           |

## GROUND FLOOR

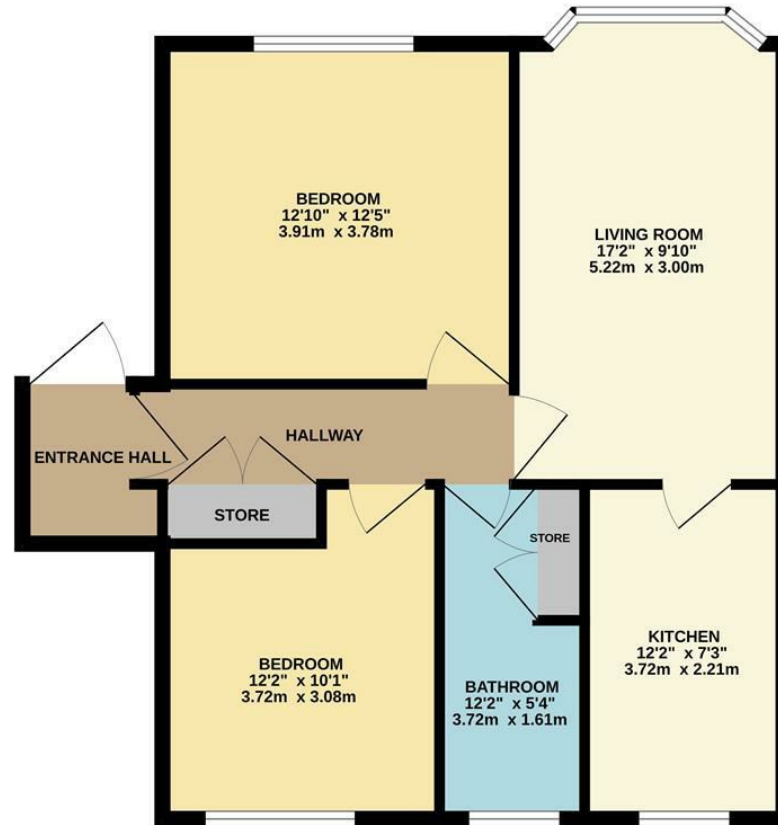

Measurements are approximate. Not to scale. Illustrative purposes only.  
Made with Metropix ©2024



These particulars are believed to be accurate but they are not guaranteed and do not form a contract. Neither Jordan Fishwick nor the vendor or lessor accept any responsibility in respect of these particulars, which are not intended to be statements or representations of fact and any intending purchaser or lessee must satisfy himself by inspection or otherwise as to the correctness of each of the statements contained in these particulars. Any floorplans on this brochure are for illustrative purposes only and are not necessarily to scale.

Offices at: Chorlton, Didsbury, Disley, Hale, Glossop, Macclesfield, Manchester Deansgate, Manchester Whitworth Street, New Mills, Sale, Wilmslow and Withington

01625 536300

wilmslow@jordanfishwick.co.uk  
www.jordanfishwick.co.uk