



1 Assisi Gardens, Manchester, M12 5AS

Welcome to Assisi Gardens, Manchester - a charming semi-detached house with great potential! This property boasts a living room, open plan kitchen diner, 3 bedrooms, and a bathroom, providing ample space for a comfortable living experience for the whole family. Situated in a cul-de-sac location, this house offers gated parking for 2 vehicles, a valuable asset in a bustling city like Manchester. While the property is in need of modernisation, this presents an exciting opportunity for you to put your personal touch on the space and create the home of your dreams. There is a large wrap around garden, perfect for them after work BBQS!

With good transport links nearby, commuting to work or exploring the vibrant city of Manchester is a breeze. Additionally, the proximity to Gorton Monastery adds a touch of history and culture to the neighbourhood, perfect for those who appreciate architectural beauty.

Price £240,000

Viewing arrangements

Viewing strictly by appointment through the agent
245 Deansgate, Manchester, M3 4EN 0161 833 9499 opt 3

Porch

Living Room

14'9" x 12'10"

Laminate flooring. Ceiling light. Electric fire. Under stairs storage. Radiator.

Kitchen/Diner

15'8" x 9'2"

Range of wall and base units with worktops over. Sink with mixer tap. Cooker with hob and extractor over. Space for fridge/freezer, washing machine and dryer. Combi boiler. Access to garden. Radiator.

Bedroom One

14'0" x 8'11"

Fitted carpet. Ceiling. Radiator. Telephone point.

Bedroom Two

10'1" x 8'2"

Fitted carpet. Ceiling. Radiator.

Bedroom Three

9'3" x 6'6"

Fitted carpet. Ceiling. Radiator.

Bathroom

Bath with electric shower over. Low level W/C. Sink with 2 tap holes. Radiator. Vinyl flooring.

Externally

Driveway to the rear. Wrap around gardens.

Additional Info

Freehold.

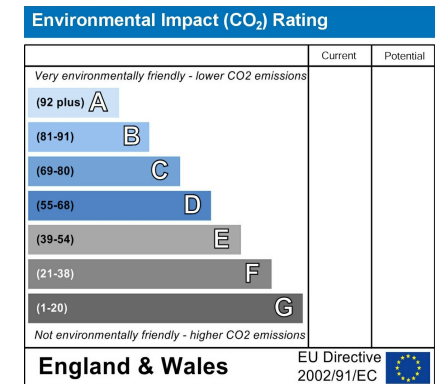
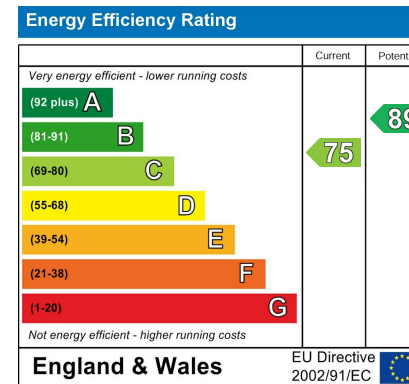



GROUND FLOOR

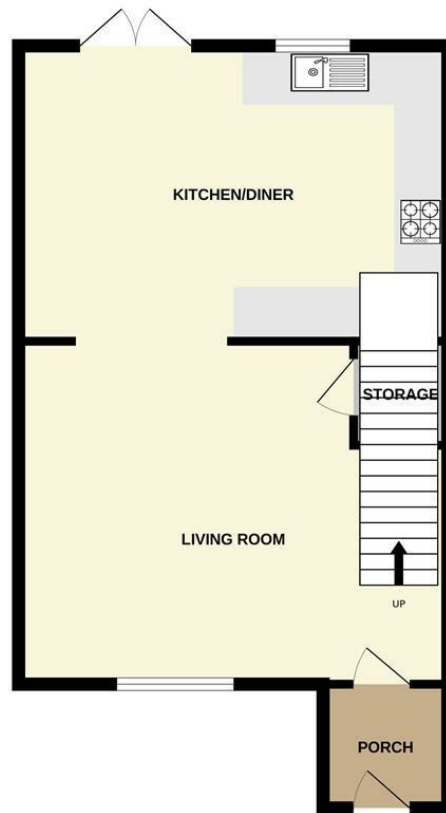

1ST FLOOR



Measurements are approximate. Not to scale. Illustrative purposes only.
Made with Metropix ©2024



These particulars are believed to be accurate but they are not guaranteed and do not form a contract. Neither Jordan Fishwick nor the vendor or lessor accept any responsibility in respect of these particulars, which are not intended to be statements or representations of fact and any intending purchaser or lessee must satisfy himself by inspection or otherwise as to the correctness of each of the statements contained in these particulars. Any floorplans on this brochure are for illustrative purposes only and are not necessarily to scale.

Offices at: Chorlton, Didsbury, Disley, Hale, Glossop, Macclesfield, Manchester Deansgate, Manchester Whitworth Street, New Mills, Sale, Wilmslow and Withington

245 Deansgate, Manchester, M3 4EN

0161 833 9499 opt 3

manchester@jordanfishwick.co.uk

www.jordanfishwick.co.uk

