



jordan fishwick

Low Leighton Road New Mills High Peak



Low Leighton Road New Mills High Peak SK22 4JF

£255,000



The Property

Welcome to this charming property located on Low Leighton Road in the picturesque area of New Mills, High Peak. Set back off the road by a walled frontage, this delightful house boasts two reception rooms, a dining kitchen, two bedrooms, and bathroom spread over three floors, offering ample space for comfortable living.

As you step inside, you'll be greeted by beautifully presented tasteful decor that adds a touch of elegance to the home. The lower ground floor features a dining kitchen with an Aga stove, and provides easy access to the private rear garden overlooking adjoining farmland.

The property also includes two reception rooms, ideal for entertaining guests or simply relaxing with your loved ones. Situated in a popular and convenient location, you'll have easy access to local amenities, schools, and transport links, making this home a perfect choice for those seeking both comfort and convenience.

Don't miss out on the opportunity to make this lovely house your new home. Contact us today to arrange a viewing and experience the charm of Low Leighton Road for yourself.



- Immaculately Presented Over Three Floors
- Two Reception Rooms
- Lower Ground Floor Dining Kitchen with AGA and Beamed Ceiling
- Two Double Bedrooms
- Stunning Private Rear Garden Adjoining Farmland
- No Onward Chain
- Convenient Location for New Mills Centre
- Modern White Bathroom Suite

Postcode SK22 4JF

EPC Rating D

Local Authority High Peak

Council Tax B

Energy Efficiency Rating		Current	Potential
Very energy efficient - lower running costs			
(92 plus)	A		
(81-91)	B		85
(69-80)	C	64	
(55-68)	D		
(39-54)	E		
(21-38)	F		
(1-20)	G		
Not energy efficient - higher running costs			
England & Wales			EU Directive 2002/91/EC



LOWER GROUND FLOOR

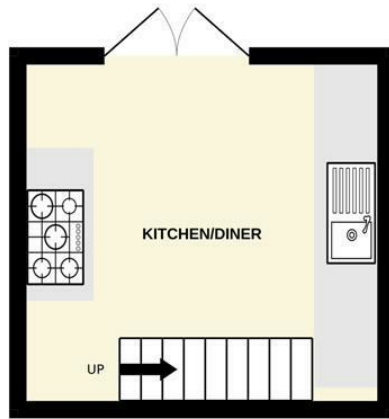

GROUND FLOOR

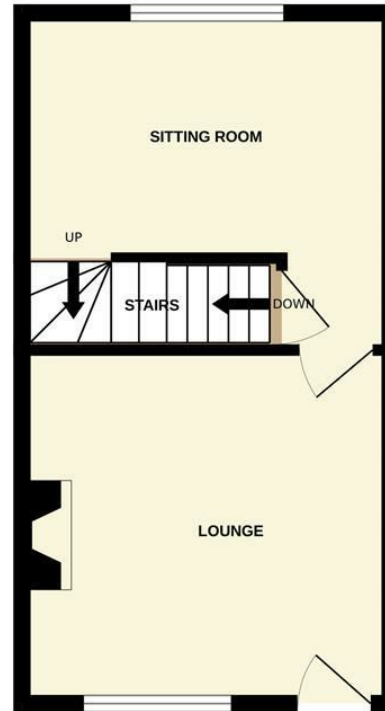

1ST FLOOR



Whilst every attempt has been made to ensure the accuracy of the floorplan contained here, measurements of doors, windows, rooms and any other items are approximate and no responsibility is taken for any error, omission or mis-statement. This plan is for illustrative purposes only and should be used as such by any prospective purchaser. The services, systems and appliances shown have not been tested and no guarantee as to their operability or efficiency can be given.
Made with Metropix ©2024



These particulars are believed to be accurate but they are not guaranteed and do not form a contract. Neither Jordan Fishwick nor the vendor or lessor accept any responsibility in respect of these particulars, which are not intended to be statements or representations of fact and any intending purchaser or lessee must satisfy himself by inspection or otherwise as to the correctness of each of the statements contained in these particulars. Any floorplans on this brochure are for illustrative purposes only and are not necessarily to scale.

Offices at: Chorlton, Didsbury, Disley, Hale, Glossop, Macclesfield, Manchester Deansgate, Manchester Whitworth Street, New Mills, Sale, Wilmslow and Withington

2 Union Road, New Mills, High Peak, Derbyshire, SK22 3ES

01663 767878

newmills@jordanfishwick.co.uk

www.jordanfishwick.co.uk