



jordan fishwick

ALTRINCHAM
Wellington Road



Wellington Road, Altrincham, WA15 7RD

£1,295 PCM



The Property

*** AVAILABLE NOW *** This two bedroom first floor modern apartment is situated in an extremely desirable location, close to Wellington Secondary School and Sixth Form. The property boasts well proportioned accommodation throughout. The popular development is set back from the road within attractive communal grounds. Internally there is lift and stair access to all floors. In brief the accommodation comprises: private entrance hallway, lounge diner and kitchen area, two good size bedrooms, one with ensuite and a white three piece family bathroom. Externally there is an allocated car parking space, with further visitor parking also provided. Offered on an unfurnished basis. Call now to view - 0161 929 9797

Directions

WA15 7RD



Postcode - WA15 7RD

EPC Rating - B

Floor Area - 733.00 sq ft

Local Authority - TRAFFORD

Council Tax - D



GROUND FLOOR
732 sq.ft. (68.0 sq.m.) approx.

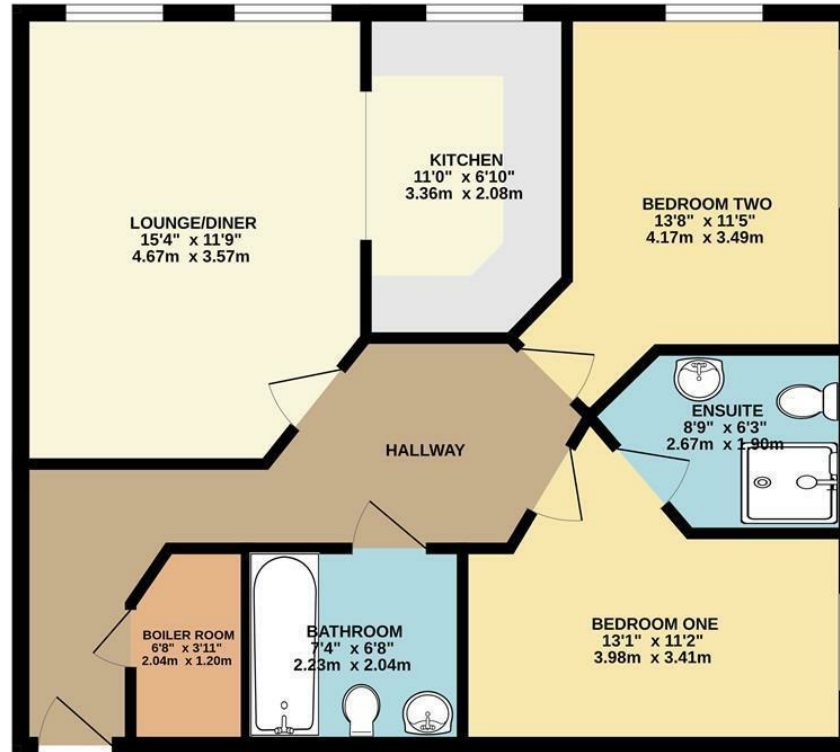

2 BED FIRST FLOOR

TOTAL FLOOR AREA: 732 sq.ft. (68.0 sq.m.) approx.

Whilst every attempt has been made to ensure the accuracy of the floorplan contained herein, measurements of doors, windows, rooms and any other items are approximate and no responsibility is taken for any error, omission or mis-statement. This plan is for illustrative purposes only and should be used as such by any prospective purchaser. The services, systems and appliances shown have not been tested and no guarantee as to their operability or efficiency can be given.
Made with Metropix 5.0024



These particulars are believed to be accurate but they are not guaranteed and do not form a contract. Neither Jordan Fishwick nor the vendor or lessor accept any responsibility in respect of these particulars, which are not intended to be statements or representations of fact and any intending purchaser or lessee must satisfy himself by inspection or otherwise as to the correctness of each of the statements contained in these particulars. Any floorplans on this brochure are for illustrative purposes only and are not necessarily to scale.

Offices at: Chorlton, Didsbury, Disley, Hale, Glossop, Macclesfield, Manchester Deansgate, Manchester Whitworth Street, New Mills, Sale, Wilmslow and Withington

0161 929 9797

hale@jordanfishwick.co.uk
www.jordanfishwick.co.uk