

These particulars are believed to be accurate but they are not guaranteed and do not form a contract. Neither Jordan Fishwick nor the vendor or lessor accept any responsibility in respect of these particulars, which are not intended to be statements or representations of fact and any intending purchaser or lessee must satisfy himself by inspection or otherwise as to the correctness of each of the statements contained in these particulars. Any floorplans on this brochure are for illustrative purposes only and are not necessarily to scale.

Whilst every attempt has been made to ensure the accuracy of the floorplan contained here, measurements of doors, windows, rooms and any other items are approximate and no responsibility is taken for any error, omission or mis-statement. This plan is for illustrative purposes only and should be used as such by any prospective purchaser. The services, systems and appliances shown have not been tested and no guarantee as to their operability or efficiency can be given.  
Made with Mapbox ©2024

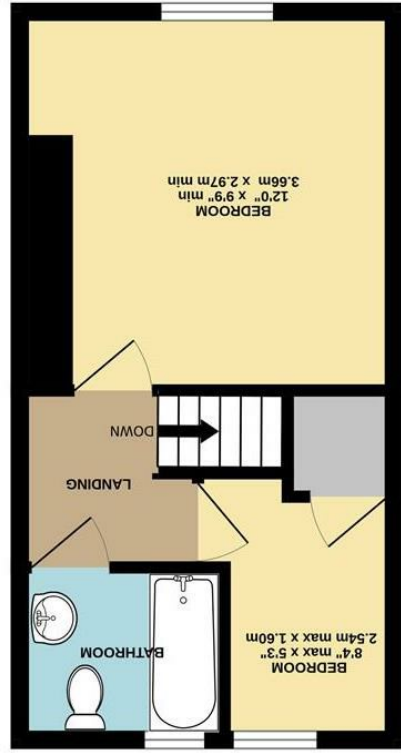

1ST FLOOR

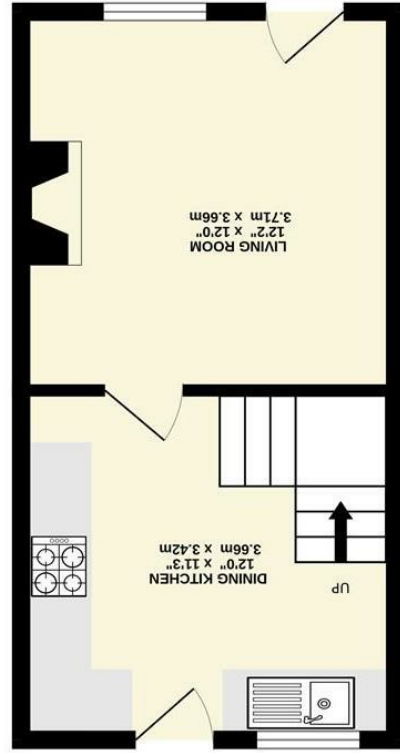

GROUND FLOOR





43 Macclesfield Road, Whaley Bridge, High Peak, SK23 7DG

£189,950



### The Property

Set back from the road behind a walled frontage, a bijou stone built end of terrace. Well presented throughout and offered for sale with no chain. Pvc double glazing, gas central heating and comprising: living room, dining kitchen, two first floor bedrooms and a bathroom. Private rear paved garden and ideal for first time buyers or those looking for a buy to let. Popular location in Whaley Bridge. Viewing recommended



- Stone Built End Of Terrace
- Two Bedrooms
- Walled Frontage
- Pvc Double Glazing
- No Chain
- Popular Location
- Ideal Buy To Let or First Time Buy
- Enclosed Private Rear Garden
- Gas Central Heating

Postcode - SK23 7DG  
EPC Rating - D  
Local Authority - High Peak  
Council Tax - B

