



jordan fishwick

APT 2 SYCAMORE COURT CARRINGTON LANE SALE M33 5UN
Per Calendar Month £975 Per Calendar

.. ..

APT 2 SYCAMORE COURT CARRINGTON LANE SALE M33 5UN

AVAILABLE NOW

Well presented two bedroom ground floor apartment situated with a convenient location of Sale with easy access to the M60 motorway link. Situated in a modern development with fitted kitchen appliances and double doors leading out to the communal garden area. Modern fitted bathroom. Electric heating. Communal grounds and gardens. Allocated parking together with additional visitor parking. Council Tax Band B. EPC Rating D.

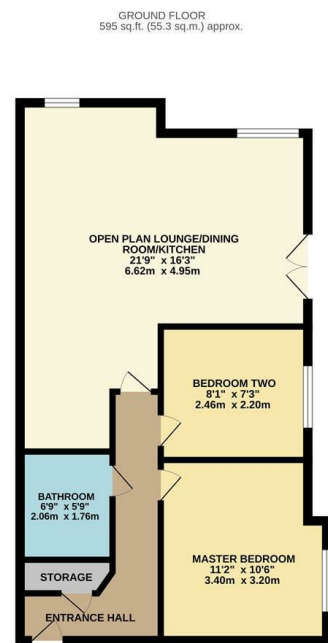

TOTAL FLOOR AREA: 595 sq. ft. (55.3 sq.m.) approx.
Measurements are approximate. Not to scale. Not for professional purposes only.
Based on floor plan only.



- Available Now
- Two Bed Ground Floor Apartment
- Communal Entrance with Intercom
- Kitchen with Dishwasher, Cooker and Fridge Freezer
- Communal Grounds And Gardens
- Allocated Parking
- Additional Visitor Parking
- Council Tax Band B
- EPC Rating D

Energy Efficiency Rating		Environmental Impact (CO ₂) Rating			
Very energy efficient - lower running costs	Current	Potential	Very environmentally friendly - lower CO ₂ emissions	Current	Potential
(92 plus) A			(92 plus) A		
(81-91) B			(81-91) B		
(69-80) C			(69-80) C		
(55-68) D		58	(55-68) D		
(39-54) E			(39-54) E		
(21-38) F			(21-38) F		
(1-20) G			(1-20) G		
Not energy efficient - higher running costs			Not environmentally friendly - higher CO ₂ emissions		
England & Wales		EU Directive 2002/91/EC	England & Wales		EU Directive 2002/91/EC