

**This property is fully booked
for viewings**

jordan fishwick

jordan fishwick

6 Calverley Close, Wilmslow, SK9 2GS
PCM £1,100 PCM



Calverley Close Cheshire SK9 2GS

£1,100 PCM



PART FURNISHED AVAILABLE MID AUGUST

Located on this popular estate within walking distance of Wilmslow town centre and the train station is this extremely attractive two double bedroom mid mews.

Being only a short drive to Manchester International Airport and with a South facing garden this property is ideal for the young professional or couple.

Entrance porch, lounge through diner with under stairs storage and patio doors to sunny rear garden with patio, modern fitted kitchen with gas hob and electric oven fridge and washer dryer. To the first floor two good sized double bedrooms both with fitted wardrobes, bathroom with shower over bath. GARDENING INCLUDED VIEWING HIGHLY RECOMMENDED

Contact Wilmslow 01625 536300 £1100.00pcm

COUNCIL TAX C

EPC C



- TWO DOUBLE BEDROOMS
- POPULAR LOCATION
- WALKING DISTANCE OF WILMSLOW
- SUNNY REAR GARDEN
- OFF ROAD PARKING
- COUNCIL TAX C
- EPC C



Energy Efficiency Rating		
	Current	Potential
Very energy efficient - lower running costs		
(92 plus) A		
(81-91) B		
(69-80) C	71	73
(55-68) D		
(39-54) E		
(21-38) F		
(1-20) G		
Not energy efficient - higher running costs		
England & Wales	EU Directive 2002/91/EC 	



GROUND FLOOR

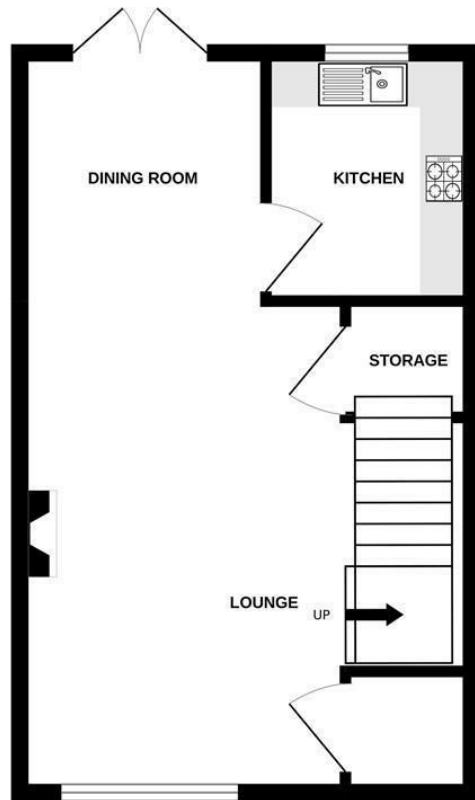

1ST FLOOR



Measurements are approximate. Not to scale. Illustrative purposes only.
Made with Metropix ©2023



These particulars are believed to be accurate but they are not guaranteed and do not form a contract. Neither Jordan Fishwick nor the vendor or lessor accept any responsibility in respect of these particulars, which are not intended to be statements or representations of fact and any intending purchaser or lessee must satisfy himself by inspection or otherwise as to the correctness of each of the statements contained in these particulars. Any floorplans on this brochure are for illustrative purposes only and are not necessarily to scale.

Offices at: Chorlton, Didsbury, Disley, Hale, Glossop, Macclesfield, Manchester Deansgate, Manchester Whitworth Street, New Mills, Sale, Wilmslow and Withington

01625 536300

wilmslow@jordanfishwick.co.uk
www.jordanfishwick.co.uk