



*Jordan fishwick*

Apt 151 The Edge, Clowes Street, M3 5NE  
£1,350 Per Calendar Month





## The Edge Salford M3 5NE

£1,350 Per Calendar Month



### The Property

Available Mid December. A stunning apartment in this highly sought after building on the banks of the River Irwell. This high-specification apartment comprises of an entrance hallway with a useful utility cupboard, spacious living area with floor to ceiling glazing and doors to a decked balcony, good-quality kitchen with a range of integrated appliances, master bedroom with a stylish ensuite shower room, second double bedroom and an amazing master bathroom. Furnished. Secure parking. Council Tax Band E. EPC Rating B.

**\*VIDEO/ PHOTO OFFERS NOT ACCEPTED - PLEASE BOOK AN IN PERSON VIEWING\***

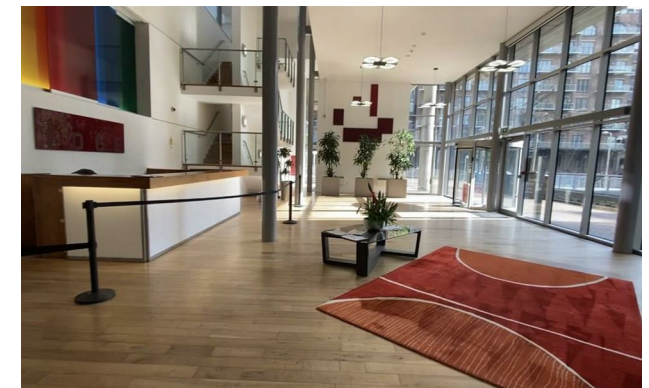



- Available Mid December
- Stunning Apartment
- Two Double Bedrooms
- Furnished
- Parking Included
- Council Tax Band E
- Close to City Centre



Energy Efficiency Rating		
	Current	Potential
Very energy efficient - lower running costs		
(92 plus) <b>A</b>		
(81-91) <b>B</b>	<b>86</b>	<b>88</b>
(69-80) <b>C</b>		
(55-68) <b>D</b>		
(39-54) <b>E</b>		
(21-38) <b>F</b>		
(1-20) <b>G</b>		
Not energy efficient - higher running costs		
<b>England &amp; Wales</b>	EU Directive 2002/91/EC 	





These particulars are believed to be accurate but they are not guaranteed and do not form a contract. Neither Jordan Fishwick nor the vendor or lessor accept any responsibility in respect of these particulars, which are not intended to be statements or representations of fact and any intending purchaser or lessee must satisfy himself by inspection or otherwise as to the correctness of each of the statements contained in these particulars. Any floorplans on this brochure are for illustrative purposes only and are not necessarily to scale.

Offices at: Offices at Chorlton, Didsbury, Disley, Hale, Glossop, Macclesfield, Manchester Deansgate, Manchester Whitworth Street, New Mills, Sale, Wilmslow and Withington