

These particulars are believed to be accurate but they are not guaranteed and do not form a contract. Neither Jordan Fishwick nor the vendor or lessor accept any responsibility in respect of these particulars, which are not intended to be statements or representations of fact and any intending purchaser or lessee must satisfy himself by inspection or otherwise as to the correctness of each of the statements contained in these particulars. Any floorplans on this brochure are for illustrative purposes only and are not necessarily to scale.

Whilst every attempt has been made to ensure the accuracy of the floorplan contained here, measurements of doors, windows, rooms and other items are approximate and no responsibility is taken for any error, omission or mis-statement. This plan is for illustrative purposes only and should be used as such by any prospective purchaser. The services, systems and appliances shown have not been tested and no guarantee as to their operability or efficiency can be given. Made with Metropix ©2023

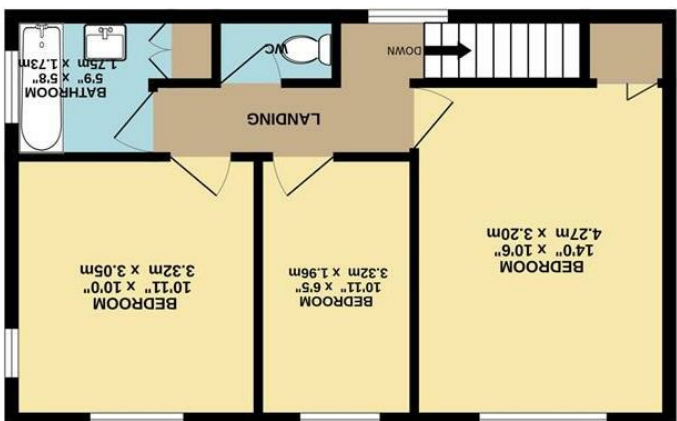

GROUND FLOOR



1ST FLOOR



54 Buxton Old Road, Disley,  
Stockport, SK12 2BW

£380,000



### The Property

Set back from the road and occupying a prime position within a convenient, sought after location in Disley, an extended three bedroom semi-detached home. Beautiful presented and extended by the current owners, this mature property has to be seen. Off road parking for multiple cars, private established gardens, pvc double glazing and gas central heating. Comprising: entrance porch, hall, living room, dining room, conservatory, re-fitted breakfast kitchen with Quartz worktops, rear porch, wc, utility room, three first floor bedrooms, bathrooms and wc. Viewing essential.



- Mature Semi-Detached Home
- Sought After Location
- Set Back From The Road
- Convenient For Disley Village
- Three Bedrooms
- Extended Accommodation
- Living Room, Dining Room and Conservatory
- Private Gardens
- Off Road Parking

Postcode - SK12 2BW  
EPC Rating -  
Local Authority - Cheshire East  
Council Tax - C

