



*Jordan fishwick*

Bank End Cottages Furness Vale High Peak





## Bank End Cottages Furness Vale High Peak SK23 7PY

£335,000



### The Property

Set back from the road and enjoying a secluded wooded backdrop, a delightful and lovingly refurbished stone built detached property. Beautifully presented throughout with a wealth of original features on show, this gorgeous, two bedroom bijou home is sure to appeal. Consisting: entrance porch, hall, living room, re-fitted dining kitchen, utility, luxury bathroom, vaulted cellar and two first floor bedrooms. Dual aspect wood burning stove, gas central heating and pvc double glazing. Off road parking, a garage, private cottage gardens with raised beds and a useful wooden garden cabin. Viewing essential.





- Charming Detached Home
- Set back from the road
- Two bedrooms
- Private cottage gardens with wooden cabin
- Parking and a Garage
- Beautifully Presented Throughout
- Convenient Location
- Wealth of Character features
- Dual Aspect Wood burning stove
- Luxurious contemporary bathroom

**Postcode** SK23 7PY

**EPC Rating**

**Local Authority** High Peak

**Council Tax**

A

Energy Efficiency Rating		Current	Potential
Very energy efficient - lower running costs			
(92 plus)	A		
(81-91)	B		
(69-80)	C		
(55-68)	D		
(39-54)	E		
(21-38)	F		
(1-20)	G		
Not energy efficient - higher running costs			
<b>England &amp; Wales</b>		EU Directive 2002/91/EC 	





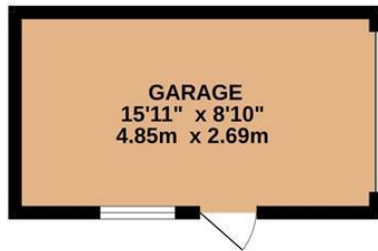

GROUND FLOOR

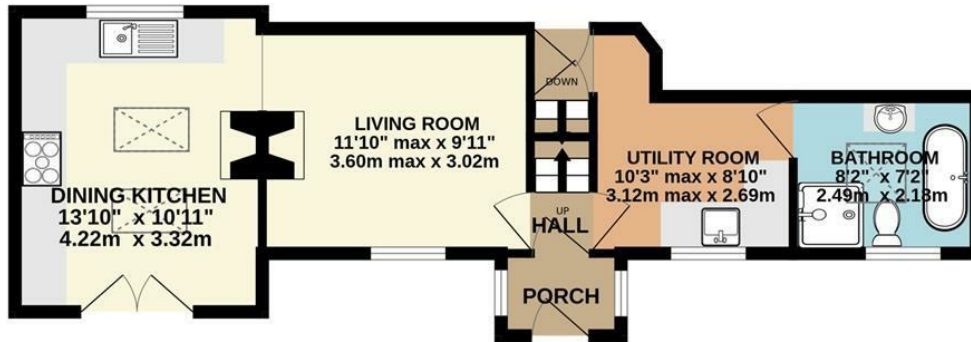

1ST FLOOR

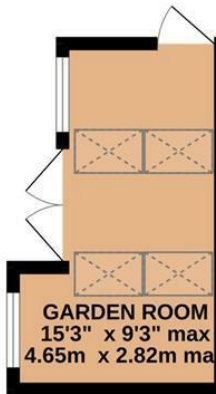
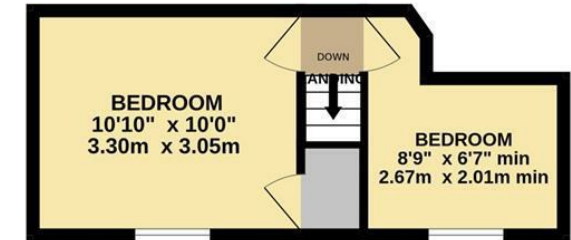

Whilst every attempt has been made to ensure the accuracy of the floorplan contained here, measurements of doors, windows, rooms and any other items are approximate and no responsibility is taken for any error, omission or mis-statement. This plan is for illustrative purposes only and should be used as such by any prospective purchaser. The services, systems and appliances shown have not been tested and no guarantee as to their operability or efficiency can be given.  
 Made with Metropix ©2024



These particulars are believed to be accurate but they are not guaranteed and do not form a contract. Neither Jordan Fishwick nor the vendor or lessor accept any responsibility in respect of these particulars, which are not intended to be statements or representations of fact and any intending purchaser or lessee must satisfy himself by inspection or otherwise as to the correctness of each of the statements contained in these particulars. Any floorplans on this brochure are for illustrative purposes only and are not necessarily to scale.

Offices at: Chorlton, Didsbury, Disley, Hale, Glossop, Macclesfield, Manchester Deansgate, Manchester Whitworth Street, New Mills, Sale, Wilmslow and Withington

14 Market Street, Disley, Cheshire, SK12 2AA

01663 76 78 78

disley@jordanfishwick.co.uk

www.jordanfishwick.co.uk