



*jordan fishwick*

CHESHIRE  
Hawthorn Street



## Hawthorn Street, Cheshire, SK9 5EJ

£1,300 PCM



### The Property

AVAILABLE NOW PART FURNISHED - VIEWING RECOMMENDED

Deceptively spacious two double bedroom mid terrace located in the heart of Wilmslow within easy walking distance of the train station and Wilmslow town centre.

Benefitting from off road parking to the front and rear the property briefly comprises entrance hall, lounge with feature fireplace, dining room/second lounge with open fire and door through to fitted kitchen with gas hob and electric oven, fridge freezer and dishwasher, garden room leading to patio and two good sized storage outhouses one with washing machine and dryer, fridge and freezer.

To the first floor two spacious double bedrooms bathroom with separate shower cubicle.

Low maintenance rear garden with patio and shed.

Contact Wilmslow 01625 536300 £1300.00pcm

COUNCIL TAX C

EPC D

### Directions

SK9 5EJ



- TWO BEDROOMS
- CENTRAL LOCATION
- OFF ROAD PARKING
- TWO RECEPTION ROOMS
- ENCLOSED REAR GARDEN
- COUNCIL TAX C
- EPC E

Postcode - SK9 5EJ

EPC Rating - E

Floor Area - sq ft

Local Authority - Cheshire East Council

Council Tax - C



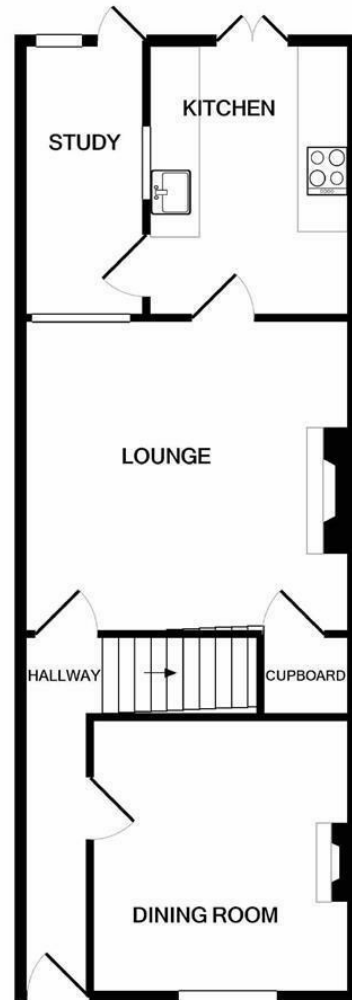

GROUND FLOOR

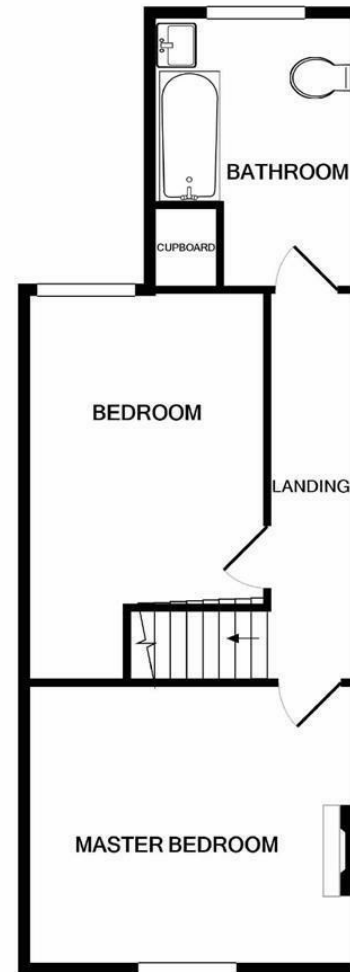

1ST FLOOR

Measurements are approximate. Not to scale. Illustrative purposes only  
 Made with Metropix ©2020



These particulars are believed to be accurate but they are not guaranteed and do not form a contract. Neither Jordan Fishwick nor the vendor or lessor accept any responsibility in respect of these particulars, which are not intended to be statements or representations of fact and any intending purchaser or lessee must satisfy himself by inspection or otherwise as to the correctness of each of the statements contained in these particulars. Any floorplans on this brochure are for illustrative purposes only and are not necessarily to scale.

Offices at: Chorlton, Didsbury, Disley, Hale, Glossop, Macclesfield, Manchester Deansgate, Manchester Whitworth Street, New Mills, Sale, Wilmslow and Withington

01625 536300

wilmslow@jordanfishwick.co.uk  
 www.jordanfishwick.co.uk