



*jordan fishwick*

128 Manchester Road, SK9 2LE  
PCM £895 PCM



## Manchester Road WILMSLOW

£895 PCM



**PART FURNISHED AVAILABLE EARLY NOVEMBER - VIEWING HIGHLY RECOMMENDED**

Located to the North of Wilmslow Town Centre this extremely spacious one bedroom apartment is sure to attract a lot of interest

Within easy reach of the A34 and Manchester International Airport and offered with 1 parking space

Communal entrance hall with stairs to landing and private entrance hall with storage containing freezer, excellent sized lounge diner, good sized double bedroom with fitted wardrobes, bathroom with shower over bath, modern fitted kitchen with gas hob and electric oven, washing machine and fridge,

Contact Wilmslow 01625 536300 £895.00pcm





- FIRST FLOOR APARTMENT
- EASY REACH OF WILMSLOW AND HANDFORTH
- GAS CENTRAL HEATING
- DOUBLE GLAZING
- OFF ROAD PARKING
- COUNCIL TAX B



Energy Efficiency Rating		
	Current	Potential
Very energy efficient - lower running costs		
(92 plus) <b>A</b>		
(81-91) <b>B</b>		
(69-80) <b>C</b>		<b>77</b>
(55-68) <b>D</b>	<b>66</b>	
(39-54) <b>E</b>		
(21-38) <b>F</b>		
(1-20) <b>G</b>		
Not energy efficient - higher running costs		
<b>England &amp; Wales</b>	EU Directive 2002/91/EC 	



GROUND FLOOR

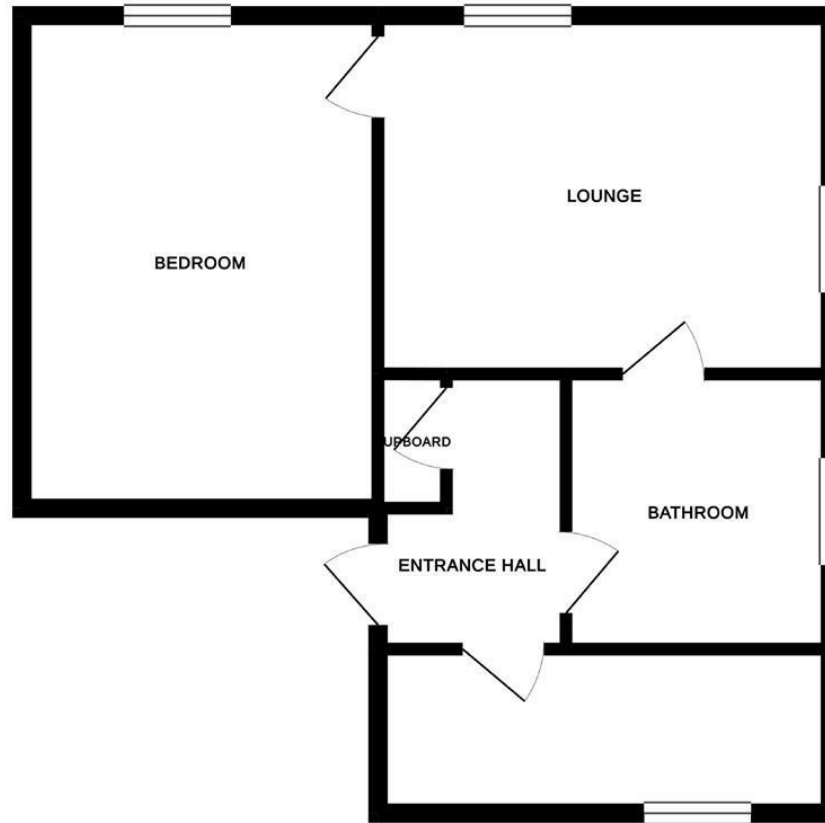

Whilst every attempt has been made to ensure the accuracy of the floorplan contained here, measurements of doors, windows, rooms and any other items are approximate and no responsibility is taken for any error, omission or mis-statement. This plan is for illustrative purposes only and should be used as such by any prospective purchaser. The services, systems and appliances shown have not been tested and no guarantee as to their operability or efficiency can be given.  
Made with Metropix ©2019



These particulars are believed to be accurate but they are not guaranteed and do not form a contract. Neither Jordan Fishwick nor the vendor or lessor accept any responsibility in respect of these particulars, which are not intended to be statements or representations of fact and any intending purchaser or lessee must satisfy himself by inspection or otherwise as to the correctness of each of the statements contained in these particulars. Any floorplans on this brochure are for illustrative purposes only and are not necessarily to scale.

Offices at: Chorlton, Didsbury, Disley, Hale, Glossop, Macclesfield, Manchester Deansgate, Manchester Whitworth Street, New Mills, Sale, Wilmslow and Withington

01625 536300

wilmslow@jordanfishwick.co.uk  
www.jordanfishwick.co.uk