



*jordan fishwick*



# 117 Yewtree Lane, Manchester, M23 0EE

Three bedroom semi-detached property occupying a large plot with spacious frontage. With great potential for a buyer to add their own stamp! Situated in close proximity to motorway links, Metrolink, Wythenshawe Hospital and Park. The property briefly comprises: entrance hall, fitted kitchen, downstairs WC and bathroom, dual aspect lounge, access to the extension which offers a sitting room/further bedroom and wet room. To the first floor are three double bedrooms. Externally, there are front/rear gardens and large driveway. Freehold. Council Tax Band B. EPC Rating D.

## £270,000

### Viewing arrangements

Viewing strictly by appointment through the agent

95-97 School Road, Sale, Cheshire, M33 7XA 0161 962 2828

#### Kitchen

6'10" x 10'9"

Fitted with modern wall and base level units incorporating integrated: eye level double oven, gas hob with extractor hood. Space for washing machine. UPVC window to the side aspect, UPVC door to the garden, radiator, tiled flooring.

#### Lounge

10'9" x 15'8"

Dual aspect reception room with laminate flooring, ceiling lighting, radiator and access to the extension.

#### Sitting Room/Bedroom

9'10" x 8'2"

Originally constructed to be used as a bedroom, this versatile room has potential for various uses. UPVC window and door to the garden, carpeted flooring, ceiling light point and radiator.

#### Wet Room

9'10" x 5'10"

Wet room fitted with low level WC, wall mounted wash basin and electric shower.

#### Bathroom

4'7" x 5'6"

Fitted with wash basin and bath with thermostatic mains shower above. Obscured UPVC window to the front aspect, ceiling lighting and chrome towel radiator.

#### WC

4'11" x 2'3"

Fitted with low level WC. Obscured UPVC window to the front aspect.

#### First Floor

##### Master Bedroom

9'10" x 15'8"

Double bedroom with dual aspect UPVC windows to the front and rear. Radiator, ceiling light point and carpeted flooring.

##### Bedroom Two

7'10" x 10'9"

Double bedroom with UPVC window to the front. Radiator, ceiling light point and laminate flooring.

### Bedroom Three

10'9" x 7'2"

Double bedroom with UPVC window to the rear. Radiator, ceiling light point and laminate flooring.



Energy Efficiency Rating		Current	Potential
<i>Very energy efficient - lower running costs</i>			
(92 plus) A			81
(81-91) B			
(69-80) C		68	
(55-68) D			
(39-54) E			
(21-38) F			
(1-20) G			
<i>Not energy efficient - higher running costs</i>			
England & Wales		EU Directive 2002/91/EC	

Environmental Impact (CO <sub>2</sub> ) Rating		Current	Potential
<i>Very environmentally friendly - lower CO<sub>2</sub> emissions</i>			
(92 plus) A			
(81-91) B			
(69-80) C			
(55-68) D			
(39-54) E			
(21-38) F			
(1-20) G			
<i>Not environmentally friendly - higher CO<sub>2</sub> emissions</i>			
England & Wales		EU Directive 2002/91/EC	







GROUND FLOOR  
508 sq.ft. (47.2 sq.m.) approx.



1ST FLOOR  
370 sq.ft. (34.3 sq.m.) approx.

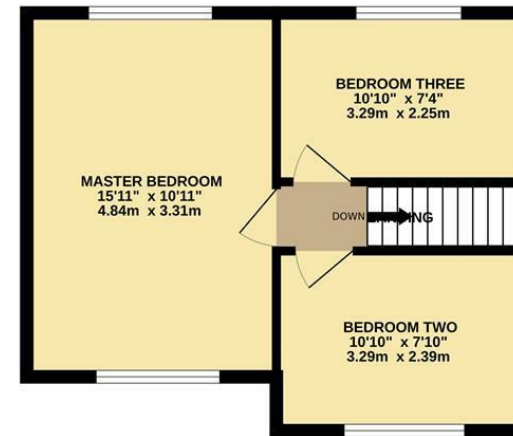

TOTAL FLOOR AREA : 878 sq.ft. (81.6 sq.m.) approx.  
Measurements are approximate. Not to scale. Illustrative purposes only  
Made with Metropix ©2024



These particulars are believed to be accurate but they are not guaranteed and do not form a contract. Neither Jordan Fishwick nor the vendor or lessor accept any responsibility in respect of these particulars, which are not intended to be statements or representations of fact and any intending purchaser or lessee must satisfy himself by inspection or otherwise as to the correctness of each of the statements contained in these particulars. Any floorplans on this brochure are for illustrative purposes only and are not necessarily to scale.

Offices at: Chorlton, Didsbury, Disley, Hale, Glossop, Macclesfield, Manchester Deansgate, Manchester Whitworth Street, New Mills, Sale, Wilmslow and Withington

95-97 School Road, Sale, Cheshire, M33 7XA

0161 962 2828

sale@jordanfishwick.co.uk  
www.jordanfishwick.co.uk

