



jordan fishwick

New Street New Mills High Peak

New Street New Mills High Peak SK22 4PD

£255,000



The Property

Superbly presented and occupying a convenient position for New Mills centre and railway stations, a charming stone built, three bedroom end of terrace. Boasting a large, enclosed south westerly garden with decked patio, this lovely family/starter home will appeal to many types of buyers. Pvc double glazing, gas central heating and comprising: entrance hall, living room, dining kitchen with French doors, three first floor bedrooms and a bathroom with white suite. Viewing highly recommended.



- Three Bedrooms
- Fine Rear Views
- Large Enclosed Garden With Deck
- Spacious Living Room
- French Doors opening to the Garden
- Well Presented Throughout
- Pvc Double Glazing and Gas Central Heating
- Convenient Position For New Mills Centre

Postcode SK22 4PD

EPC Rating D

Local Authority High Peak

Council Tax B

Energy Efficiency Rating		Current	Potential
Very energy efficient - lower running costs			
(92 plus) A			89
(81-91) B			
(69-80) C		68	
(55-68) D			
(39-54) E			
(21-38) F			
(1-20) G			
Not energy efficient - higher running costs			
England & Wales		EU Directive 2002/91/EC 	



GROUND FLOOR



1ST FLOOR

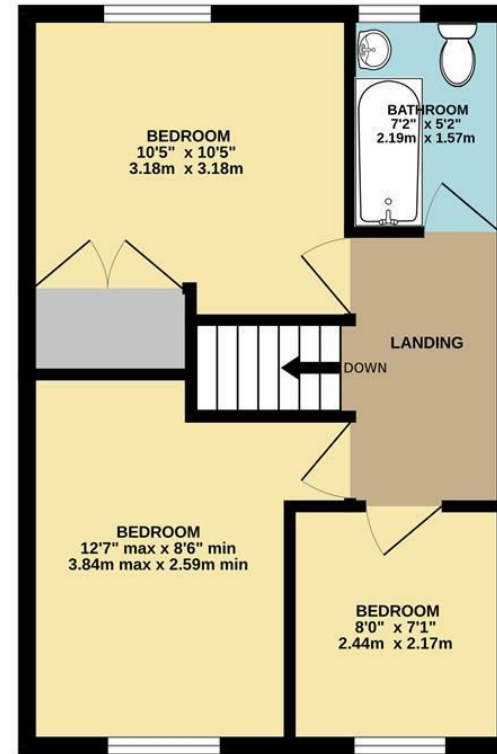

Whilst every attempt has been made to ensure the accuracy of the floorplan contained here, measurements of doors, windows, rooms and any other items are approximate and no responsibility is taken for any error, omission or mis-statement. This plan is for illustrative purposes only and should be used as such by any prospective purchaser. The services, systems and appliances shown have not been tested and no guarantee as to their operability or efficiency can be given.
Made with Metropix ©2024



These particulars are believed to be accurate but they are not guaranteed and do not form a contract. Neither Jordan Fishwick nor the vendor or lessor accept any responsibility in respect of these particulars, which are not intended to be statements or representations of fact and any intending purchaser or lessee must satisfy himself by inspection or otherwise as to the correctness of each of the statements contained in these particulars. Any floorplans on this brochure are for illustrative purposes only and are not necessarily to scale.

Offices at: Chorlton, Didsbury, Disley, Hale, Glossop, Macclesfield, Manchester Deansgate, Manchester Whitworth Street, New Mills, Sale, Wilmslow and Withington

2 Union Road, New Mills, High Peak, Derbyshire, SK22 3ES

01663 767878

newmills@jordanfishwick.co.uk

www.jordanfishwick.co.uk