



jordanfishwick

26-28 Whitelow Road
Chorlton



**26-28 Whitelow Road
Chorlton M21 9HQ**
£1,100 Per Calendar Month



The Property

*** AVAILABLE NOW *** A superbly presented lower ground floor apartment situated in a popular development in Chorlton, close to Chorlton Green, Beech road and Transport links. The accommodation offers; secure entrance into the communal area, interior hallway, good sized open plan lounge, dining area & modern kitchen, master double bedroom, second bedroom, modern main bathroom. Externally there are maintained communal gardens, secure off-road parking and secure bicycle storage lockers with availability to store two bikes. Unfurnished.

***** To arrange a viewing please call 0161 393 7539 *****

Directions

- Council Tax Band B - EPC C
- 2 Bedrooms
- Secure off road parking & Bike Storage
- Popular Development
- Close to Chorlton Green & Beech Road
- Communal Gardens & private terrace
- Available Now

Postcode - M21 9HQ
EPC Rating - C
Floor Area - sq ft
Local Authority - Manchester
Council Tax - B



GROUND FLOOR

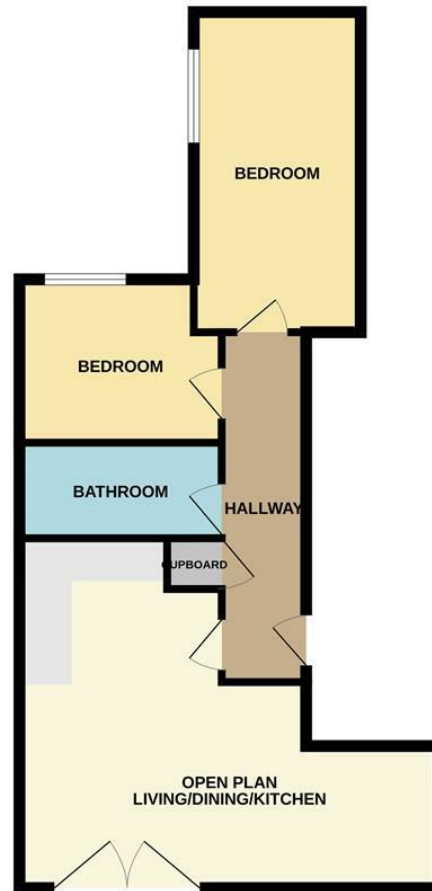

Whilst every attempt has been made to ensure the accuracy of the floorplan contained here, measurements of doors, windows, rooms and any other items are approximate and no responsibility is taken for any error, omission or mis-statement. This plan is for illustrative purposes only and should be used as such by any prospective purchaser. The services, systems and appliances shown have not been tested and no guarantee as to their operability or efficiency can be given.
Made with Metropix ©2024



These particulars are believed to be accurate but they are not guaranteed and do not form a contract. Neither Jordan Fishwick nor the vendor or lessor accept any responsibility in respect of these particulars, which are not intended to be statements or representations of fact and any intending purchaser or lessee must satisfy himself by inspection or otherwise as to the correctness of each of the statements contained in these particulars. Any floorplans on this brochure are for illustrative purposes only and are not necessarily to scale.

Offices at: Offices at Chorlton, Didsbury, Disley, Hale, Glossop, Macclesfield, Manchester Deansgate, Manchester Whitworth Street, New Mills, Sale, Wilmslow and Withington

410-412 Barlow Moor Road, Chorlton, Manchester, M21
8AD

www.jordanfishwick.co.uk