

These particulars are believed to be accurate but they are not guaranteed and do not form a contract. Neither Jordan Fishwick nor the vendor or lessor accept any responsibility in respect of these particulars, which are not intended to be statements or representations of fact and any intending purchaser or lessee must satisfy himself by inspection or otherwise as to the correctness of each of the statements contained in these particulars. Any floorplans on this brochure are for illustrative purposes only and are not necessarily to scale.

2 Union Road, New Mills, High Peak, Derbyshire, SK22 3ES

Whilst every attempt has been made to ensure the accuracy of the floorplan contained here, measurements of doors, windows, rooms and other items are approximate and no responsibility is taken for any error, omission or mis-statement. This plan is for illustrative purposes only and should be used as such by any prospective purchaser. The services, systems and appliances shown have not been tested and no guarantee as to their operability or efficiency can be given.
Made with Metropix ©2024



GROUND FLOOR

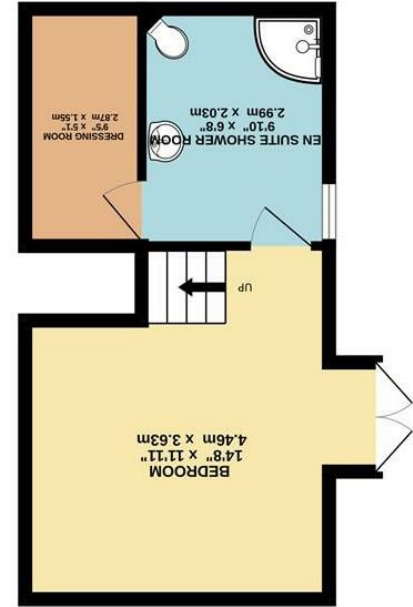

LOWER GROUND FLOOR



6 Fishers Bridge, Hayfield, High Peak, SK22 2JZ

£425,000



The Property

Welcome to this charming, stone built detached bungalow located in the heart of Hayfield. This delightful offers high quality, spacious accommodation with enclosed gardens adjoining the brook. Re-furbished in recent years with a versatile layout that suits many types of buyer. Upon entering the porch, double doors open to a 31ft open plan living dining kitchen, perfect for relaxing or entertaining. A good sized separate living room, double bedroom and bathroom complete the ground floor. With stairs down to the lower ground floor where there is a generous bedroom suite with shower and dressing room. One of the standout features of this bungalow is its suitability for one-level living and convenient position of all Hayfield Village amenities. The ample driveway parking and garage further add to the convenience and practicality of this property, ensuring that parking will never be an issue for residents or visitors. Whether you are looking to downsize, seeking a peaceful retreat in a village setting, or simply appreciate the charm of a detached stone property, this bungalow in Fishers Bridge offers a unique opportunity to embrace a relaxed lifestyle in a beautiful location. Don't miss out on the chance to make this property your own.



- Refurbished Interior
- Convenient Position For Hayfield Village
- Stone Detached Bungalow
- Adjoining a brook
- Ample Off Road Parking
- Energy Rating: E Council Tax: D
- Riverside Garden
- 31FT Living Dining Kitchen
- No Chain

Postcode - SK22 2JZ
EPC Rating - E
Local Authority - High Peak
Council Tax - D

