



jordan fishwick

41 Brackenwood Mews, Wilmslow, SK9
PCM £725 PCM



Brackenwood Mews Cheshire

£725 PCM



AVAILABLE EARLY JUNE FURNISHED - VIEWING ESSENTIAL

This refurbished studio apartment is presented in IMMACULATE order.

With a modern fitted kitchen and bathroom this studio apartment is ideal for the single professional. Located on the first floor in an extremely well maintained block on this popular estate and being within walking distance of Wilmslow town centre and with excellent access to the A34, Manchester International Airport and the motorway networks.

Communal entrance hall, private entrance hall, open plan lounge dining bedroom area, modern redesigned kitchen with electric hob and oven, washing machine and fridge freezer, attractive modern bathroom with walk in shower.

Off road parking, fully double glazed. Quiet location. Gas central heating.

Contact Wilmslow 01625 536300 £725.00pcm

EPC D

COUNCIL TAX A



- STUDIO APARTMENT
- GAS CENTRAL HEATING
- MODERN KITCHEN AND BATHROOM
- FULLY DOUBLE GLAZED
- COUNCIL TAX A
- EPC D



Energy Efficiency Rating		
	Current	Potential
Very energy efficient - lower running costs		
(92 plus) A		
(81-91) B		
(69-80) C		74
(55-68) D	68	
(39-54) E		
(21-38) F		
(1-20) G		
Not energy efficient - higher running costs		
England & Wales	EU Directive 2002/91/EC 	

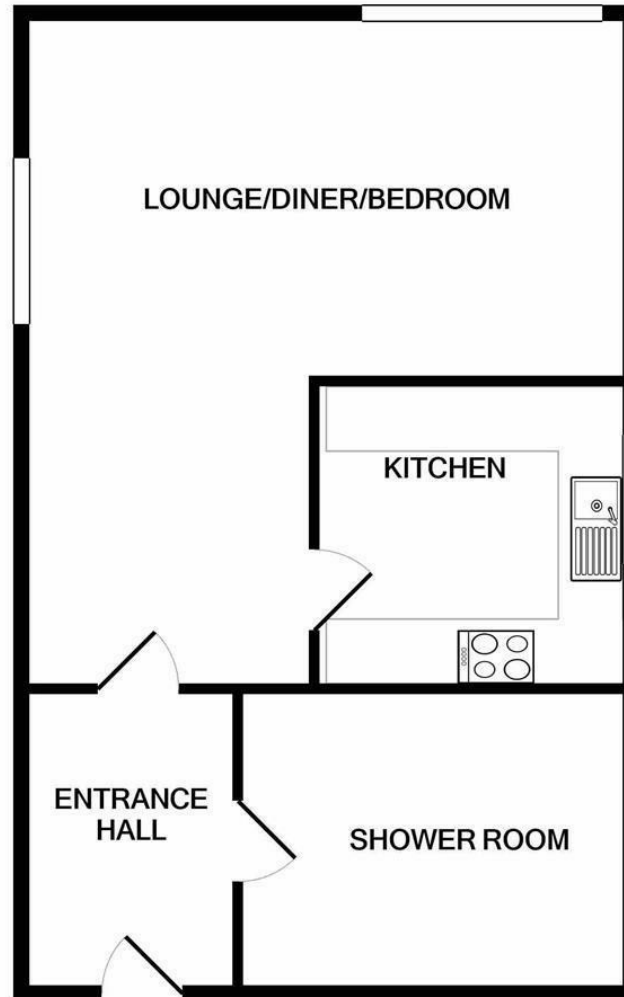

Measurements are approximate. Not to scale. Illustrative purposes only
Made with Metropix ©2022



These particulars are believed to be accurate but they are not guaranteed and do not form a contract. Neither Jordan Fishwick nor the vendor or lessor accept any responsibility in respect of these particulars, which are not intended to be statements or representations of fact and any intending purchaser or lessee must satisfy himself by inspection or otherwise as to the correctness of each of the statements contained in these particulars. Any floorplans on this brochure are for illustrative purposes only and are not necessarily to scale.

Offices at: Chorlton, Didsbury, Disley, Hale, Glossop, Macclesfield, Manchester Deansgate, Manchester Whitworth Street, New Mills, Sale, Wilmslow and Withington

01625 536300

wilmslow@jordanfishwick.co.uk
www.jordanfishwick.co.uk