



jordan fishwick

44 Roe Street, SK11 6XD
PCM £695 PCM

Roe Street Macclesfield SK11 6XD

£695 PCM



AVAILABLE NOW UNFURNISHED- VIEWING RECOMMENDED

Being only a short stroll from Macclesfield Town Centre and the train station is this delightful mid terrace.

Presented in excellent order and with a spacious interior this one bedroom property is ideal for the single professional or couple.

Lounge, dining kitchen with gas hob and electric oven and door to small shared yard.

To the first floor double bedroom and bathroom with shower over bath.

No parking but permit parking available at Churchill Way car park.

Contact Macclesfield 01625 502222 £695.00pcm

Council tax A

EPC D

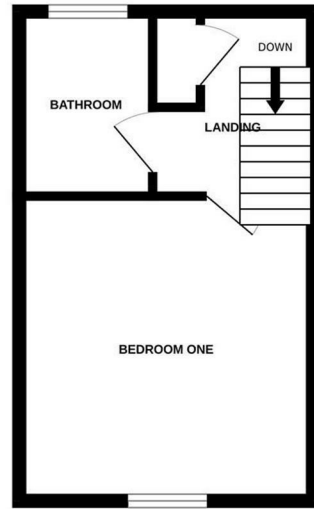
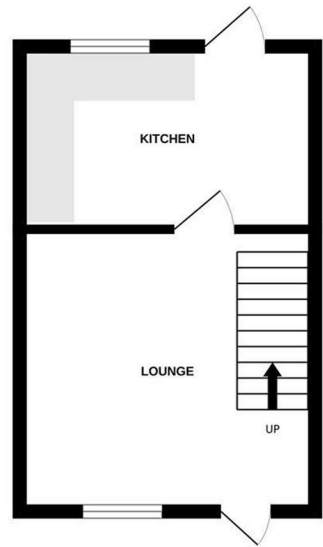

- ONE BEDROOM
- CENTRAL LOCATION
- WELL PRESENTED
- WALKING DISTANCE OF TRAIN STATION
- COUNCIL TAX A
- EPC D



Energy Efficiency Rating		
	Current	Potential
<i>Very energy efficient - lower running costs</i>		
(92 plus) A		89
(81-91) B		
(69-80) C		
(55-68) D	63	
(39-54) E		
(21-38) F		
(1-20) G		
<i>Not energy efficient - higher running costs</i>		
England & Wales		EU Directive 2002/91/EC 

GROUND FLOOR

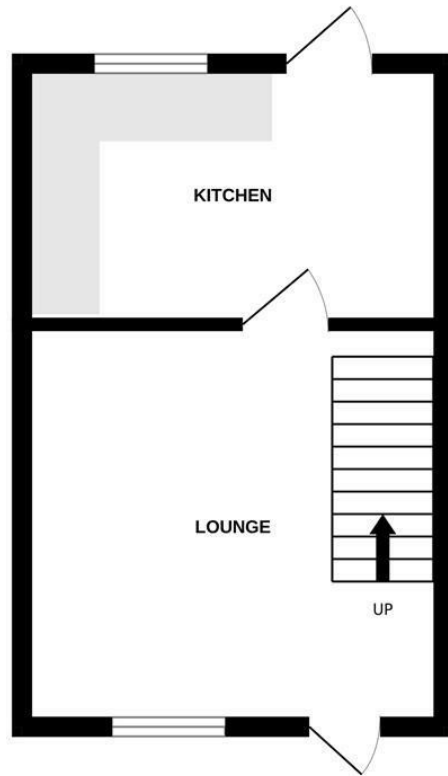

1ST FLOOR

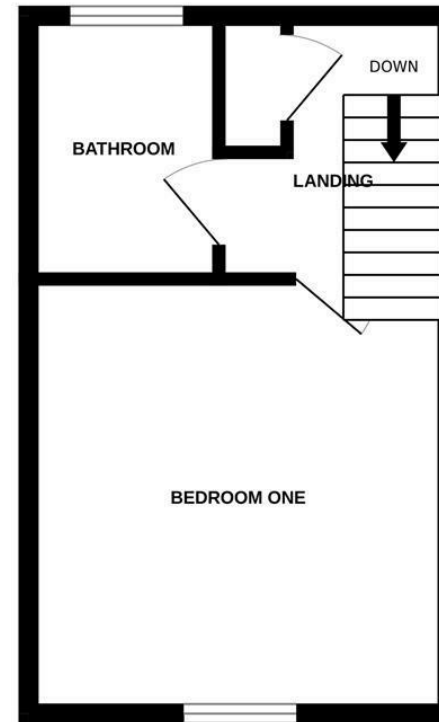

Measurements are approximate. Not to scale. Illustrative purposes only
Made with Metropix ©2024



These particulars are believed to be accurate but they are not guaranteed and do not form a contract. Neither Jordan Fishwick nor the vendor or lessor accept any responsibility in respect of these particulars, which are not intended to be statements or representations of fact and any intending purchaser or lessee must satisfy himself by inspection or otherwise as to the correctness of each of the statements contained in these particulars. Any floorplans on this brochure are for illustrative purposes only and are not necessarily to scale.

Offices at: Chorlton, Didsbury, Disley, Hale, Glossop, Macclesfield, Manchester Deansgate, Manchester Whitworth Street, New Mills, Sale, Wilmslow and Withington

84-86 Waters Green, Macclesfield, SK11 6LH

01625 502222

macc@jordanfishwick.co.uk

www.jordanfishwick.co.uk