



Jordan fishwick

Rosey Bank Buxworth High Peak

Rosey Bank Buxworth High Peak SK23 7NR

£375,000



The Property

Occupying an enviable semi-rural position in ever popular Buxworth and offering superb open rear views over countryside, a superbly presented three double bedroom cottage of character. Deceptive, high quality accommodation arranged over four floors and guaranteed to impress, this delightful home has to be viewed. Large detached garage with workshop, low maintenance southerly facing garden and comprising: entrance hall, living room and sitting room, lower ground floor breakfast kitchen, two first floor double bedrooms, spacious bathroom with freestanding bath and separate shower, second floor attic bedroom. Wood burning stoves, gas central heating and double glazing. A real gem of a property!



- Superb Character Residence
- Arranged Over FOUR Floors
- Stunning Views
- Semi-Rural Location
- Three Double Bedrooms
- Luxury Kitchen and Bathroom
- Large Detached Garage Plus Workshop Area
- Versatile High Quality Accommodation

Postcode SK23 7NR

EPC Rating C

Local Authority High Peak

Council Tax B

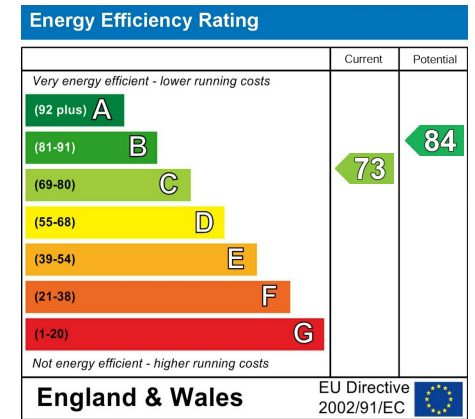

OUTSIDE

LOWER GROUND FLOOR

GROUND FLOOR

1ST FLOOR

2ND FLOOR

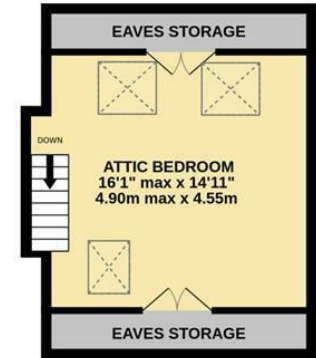
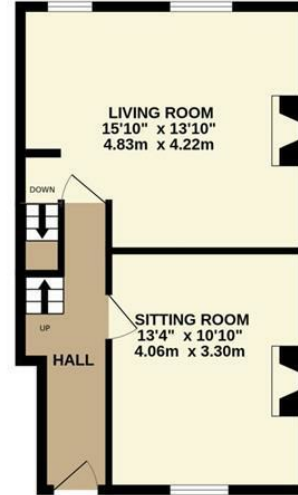
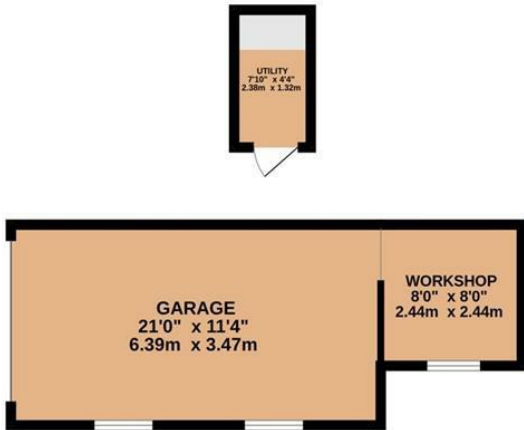

Whilst every attempt has been made to ensure the accuracy of the floorplan contained here, measurements of doors, windows, rooms and any other items are approximate and no responsibility is taken for any error, omission or mis-statement. This plan is for illustrative purposes only and should be used as such by any prospective purchaser. The services, systems and appliances shown have not been tested and no guarantee as to their operability or efficiency can be given.

Made with Metropix ©2023



These particulars are believed to be accurate but they are not guaranteed and do not form a contract. Neither Jordan Fishwick nor the vendor or lessor accept any responsibility in respect of these particulars, which are not intended to be statements or representations of fact and any intending purchaser or lessee must satisfy himself by inspection or otherwise as to the correctness of each of the statements contained in these particulars. Any floorplans on this brochure are for illustrative purposes only and are not necessarily to scale.

Offices at: Chorlton, Didsbury, Disley, Hale, Glossop, Macclesfield, Manchester Deansgate, Manchester Whitworth Street, New Mills, Sale, Wilmslow and Withington

14 Market Street, Disley, Cheshire, SK12 2AA

01663 76 78 78

disley@jordanfishwick.co.uk

www.jordanfishwick.co.uk