

**This property is fully booked  
for viewings**

*jordan fishwick*

*jordan fishwick*

40 Brackenwood Mews, Wilmslow, SK9  
PCM £695 PCM



## Brackenwood Mews Cheshire

£695 PCM



### AVAILABLE EARLY JUNE FURNISHED

First floor converted studio apartment with separate bedroom located on this popular development within walking distance of local shops and within easy reach of the A34. Tastefully decorated throughout, and with ample parking to the rear make this studio apartment ideal for the single professional.

Communal entrance hall, private entrance hall, bathroom with shower cubicle, lounge/dining room, modern fitted kitchen with gas hob and electric oven, fridge and washing machine, separate bedroom area.

Communal gardens. Off road parking. Gas central heating. Fully double glazed

Contact Wilmslow 01625 536300 £695.00pcm

EPC C

COUNCIL TAX A





- STUDIO APARTMENT
- SEPARATE BEDROOM AREA
- FIRST FLOOR
- OFF ROAD PARKING
- COMMUNAL GARDENS
- POPULAR LOCATION
- COUNCIL TAX A



Energy Efficiency Rating		
	Current	Potential
Very energy efficient - lower running costs		
(92 plus) <b>A</b>		
(81-91) <b>B</b>		<b>84</b>
(69-80) <b>C</b>	<b>76</b>	
(55-68) <b>D</b>		
(39-54) <b>E</b>		
(21-38) <b>F</b>		
(1-20) <b>G</b>		
Not energy efficient - higher running costs		
<b>England &amp; Wales</b>	EU Directive 2002/91/EC	

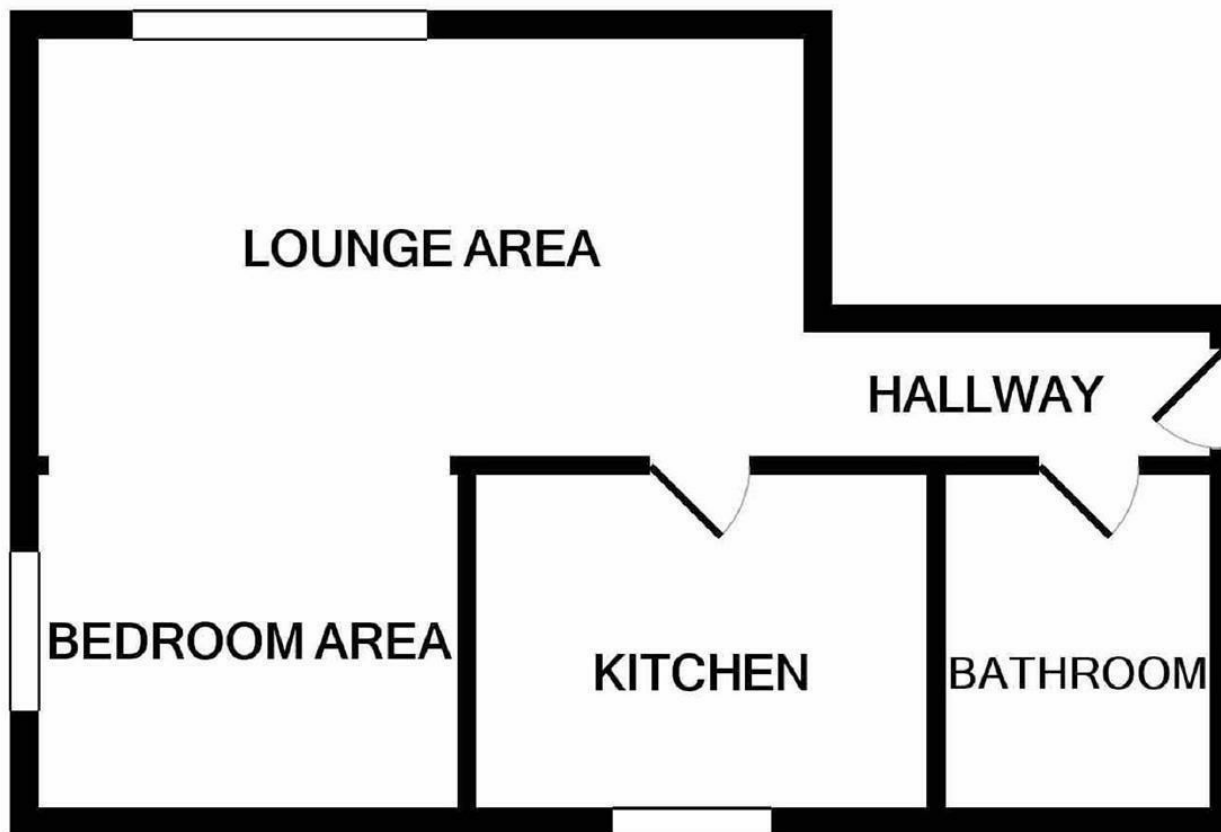

Measurements are approximate. Not to scale. Illustrative purposes only  
Made with Metropix ©2019



These particulars are believed to be accurate but they are not guaranteed and do not form a contract. Neither Jordan Fishwick nor the vendor or lessor accept any responsibility in respect of these particulars, which are not intended to be statements or representations of fact and any intending purchaser or lessee must satisfy himself by inspection or otherwise as to the correctness of each of the statements contained in these particulars. Any floorplans on this brochure are for illustrative purposes only and are not necessarily to scale.

Offices at: Chorlton, Didsbury, Disley, Hale, Glossop, Macclesfield, Manchester Deansgate, Manchester Whitworth Street, New Mills, Sale, Wilmslow and Withington

01625 536300

wilmslow@jordanfishwick.co.uk  
www.jordanfishwick.co.uk