



Jordan fishwick

11 Summerfield Village Court, Ringstead
£1,000 PCM



Summerfield Village Court Wilmslow SK9 2TG

£1,000 PCM

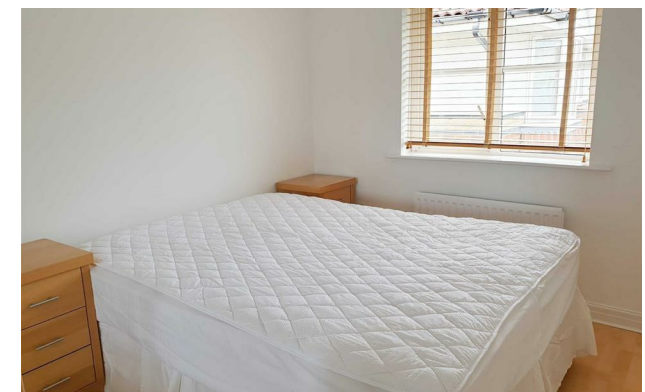

The Property

FULLY FURNISHED AVAILABLE MID JUNE

This IMMACULATE two bedroom second floor apartment and is situated within an extremely popular location, close to local shops and the A34 along with being only a short drive to Manchester International Airport.

Having just undergone a full redecoration and bathroom upgrade this two bedroom apartment is ideal for a single professional or couple. Communal entrance hallway, private entrance hall, bay fronted living room/dining room, fitted kitchen with dishwasher, washing machine, fridge and electric cooker, two bedrooms and a white three piece bathroom suite. The apartment block sits within attractive communal gardens and benefits from allocated parking.

Contact Wilmslow 01625 536300 £1000.00pcm

EPC D

COUNCIL TAX C

- TWO BEDROOMS
- POPULAR LOCATION
- CLOSE TO LOCAL SHOPS
- ALLOCATED PARKING
- IMMACULATE THROUGHOUT
- COUNCIL TAX C



Energy Efficiency Rating		
	Current	Potential
Very energy efficient - lower running costs		
(92 plus) A		
(81-91) B		
(69-80) C		76
(55-68) D	66	
(39-54) E		
(21-38) F		
(1-20) G		
Not energy efficient - higher running costs		
England & Wales	EU Directive 2002/91/EC 	



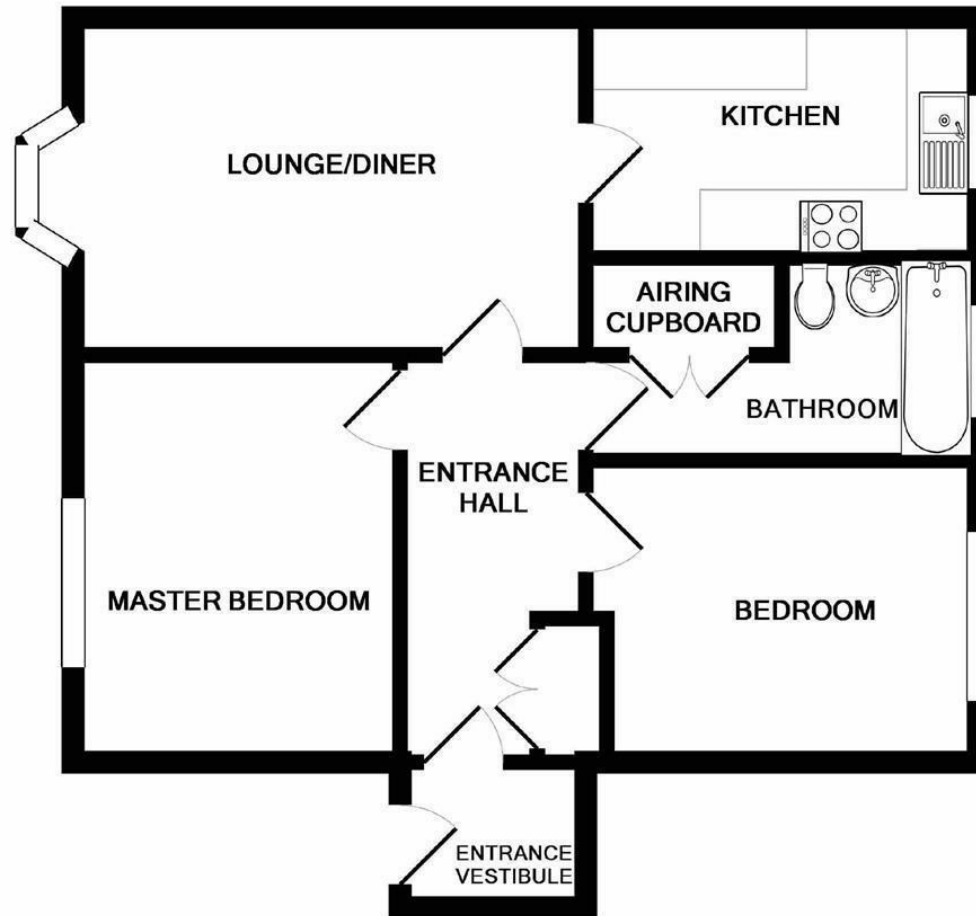

Whilst every attempt has been made to ensure the accuracy of the floor plan contained here, measurements of doors, windows, rooms and any other items are approximate and no responsibility is taken for any error, omission, or mis-statement. This plan is for illustrative purposes only and should be used as such by any prospective purchaser. The services, systems and appliances shown have not been tested and no guarantee as to their operability or efficiency can be given
 Made with Metropix ©2019



These particulars are believed to be accurate but they are not guaranteed and do not form a contract. Neither Jordan Fishwick nor the vendor or lessor accept any responsibility in respect of these particulars, which are not intended to be statements or representations of fact and any intending purchaser or lessee must satisfy himself by inspection or otherwise as to the correctness of each of the statements contained in these particulars. Any floorplans on this brochure are for illustrative purposes only and are not necessarily to scale.

Offices at: Offices at Chorlton, Didsbury, Disley, Hale, Glossop, Macclesfield, Manchester Deansgate, Manchester Whitworth Street, New Mills, Sale, Wilmslow and Withington