



jordan fishwick

47 Eastgate, SK10 1GD
PCM £1,200 PCM



Eastgate Macclesfield SK10 1GD

£1,200 PCM



AVAILABLE NOW PART FURNISHED - PRESENTED IN SHOWROOM CONDITION!

Located within a most desirable and sought after area close to Macclesfield canal and countryside but within easy walking distance of the town centre and train station is this stylish two bedroom property.

Having just undergone a full refurbishment this mid mews is presented in **IMMACULATE CONDITION** and is an ideal home for a small family or the single professional or couple.

Entrance porch, lounge, downstairs cloakroom, newly fitted modern kitchen with doors to landscaped rear garden.

To the first floor there are two well proportioned bedrooms and a newly fitted bathroom with shower over bath

A driveway to the front provides off road parking for 2 cars and the south facing enclosed rear garden with patio area provides an excellent area to sit and relax with friends and family.

Contact Macclesfield 01625 502222 £1200.00pcm

EPC C

COUNCIL TAX C



- FULLY REFURBISHED
- WALKING DISTANCE OF TOWN CENTRE AND TRAIN STATION
- TWO BEDROOMS
- ENCLOSED REAR GARDEN
- OFF ROAD PARKING
- EPC RATING C
- COUNCIL TAX C



Energy Efficiency Rating		
	Current	Potential
Very energy efficient - lower running costs		
(92 plus) A		
(81-91) B		84
(69-80) C	71	
(55-68) D		
(39-54) E		
(21-38) F		
(1-20) G		
Not energy efficient - higher running costs		
England & Wales	EU Directive 2002/91/EC	



GROUND FLOOR

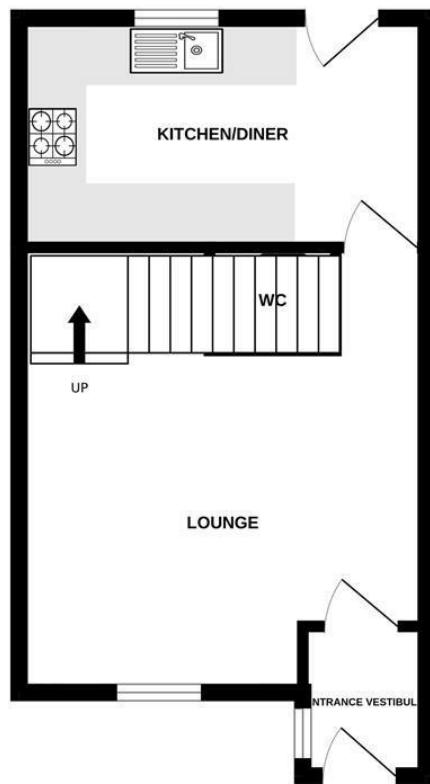

1ST FLOOR

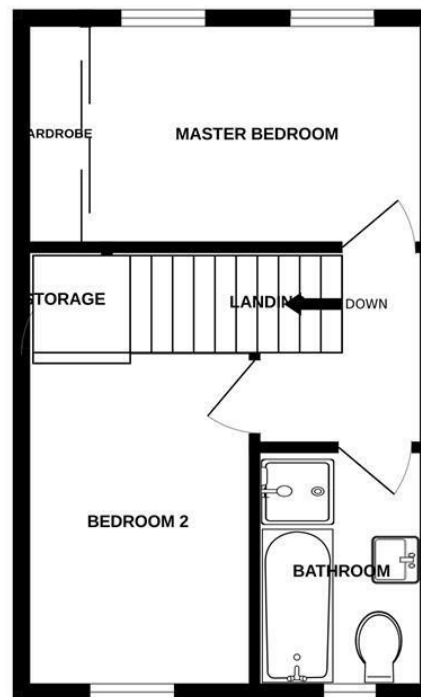

Measurements are approximate. Not to scale. Illustrative purposes only.
Made with Metropix ©2024



These particulars are believed to be accurate but they are not guaranteed and do not form a contract. Neither Jordan Fishwick nor the vendor or lessor accept any responsibility in respect of these particulars, which are not intended to be statements or representations of fact and any intending purchaser or lessee must satisfy himself by inspection or otherwise as to the correctness of each of the statements contained in these particulars. Any floorplans on this brochure are for illustrative purposes only and are not necessarily to scale.

Offices at: Chorlton, Didsbury, Disley, Hale, Glossop, Macclesfield, Manchester Deansgate, Manchester Whitworth Street, New Mills, Sale, Wilmslow and Withington

84-86 Waters Green, Macclesfield, SK11 6LH
01625 502222

mac@jordanfishwick.co.uk
www.jordanfishwick.co.uk