



jordan fishwick

Jacksons Edge Road Disley Stockport



Jacksons Edge Road Disley Stockport SK12 2JL

£650,000



The Property

Covering the entire first and second floor of a stunning period property in the heart of Disley Village, with its very own ground floor entrance hall, a truly unique and substantial executive four double bedroom home. Spacious, well presented accommodation set back from the road within private grounds offering views over Disley from the southerly facing balcony. Over 2700 square feet of accommodation arranged over three floors, this wonderful, character property is to be offered for sale for the first time in many years. Full of charm and comprising: ground floor private entrance hall, 27ft first floor hall, bay fronted living room, separate dining room with balcony, fitted kitchen, wc, two large double bedrooms and bathroom on the first floor, second floor store, laundry/utility, master bedroom with en-suite and a fourth 22ft bedroom. Boasting a long private driveway with mature, well stocked gardens and a detached double garage. No Chain



- Stunning Unique Property
- Four Double Bedroom Duplex Apartment
- Central Disley Village Location
- Set Back From The Road Within Mature Grounds
- Long Driveway and Detached Double Garage
- Full of Character
- Balcony with Fabulous Views
- No Chain
- Over 27000 Sq Ft of Accommodation

Postcode SK12 2JL

EPC Rating C

Local Authority Cheshire East

Council Tax E

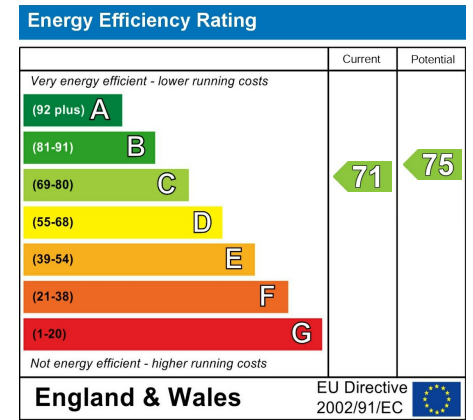



GROUND FLOOR

1ST FLOOR

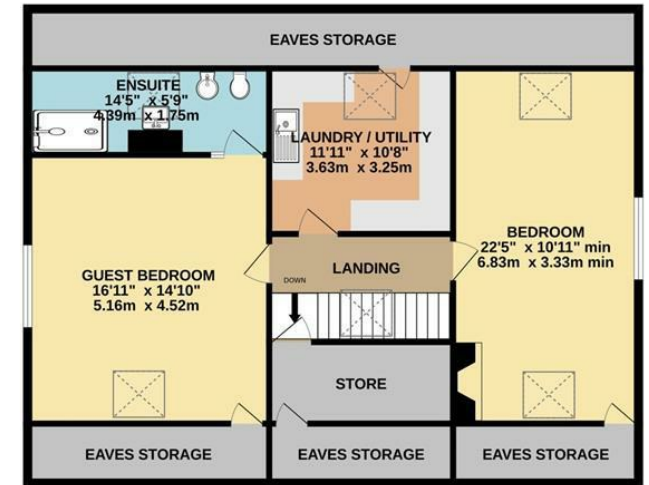

2ND FLOOR

Whilst every attempt has been made to ensure the accuracy of the floorplan contained here, measurements of doors, windows, rooms and any other items are approximate and no responsibility is taken for any error, omission or mis-statement. This plan is for illustrative purposes only and should be used as such by any prospective purchaser. The services, systems and appliances shown have not been tested and no guarantee as to their operability or efficiency can be given.
 Made with Metropix ©2024



These particulars are believed to be accurate but they are not guaranteed and do not form a contract. Neither Jordan Fishwick nor the vendor or lessor accept any responsibility in respect of these particulars, which are not intended to be statements or representations of fact and any intending purchaser or lessee must satisfy himself by inspection or otherwise as to the correctness of each of the statements contained in these particulars. Any floorplans on this brochure are for illustrative purposes only and are not necessarily to scale.

Offices at: Chorlton, Didsbury, Disley, Hale, Glossop, Macclesfield, Manchester Deansgate, Manchester Whitworth Street, New Mills, Sale, Wilmslow and Withington

14 Market Street, Disley, Cheshire, SK12 2AA

01663 76 78 78

disley@jordanfishwick.co.uk

www.jordanfishwick.co.uk