



TO LET  
jordan fishwick  
lettings  
01825 536300

*jordan fishwick*

1 Newbury Court, Lindfield Estate South,  
PCM £875 PCM

# Newbury Court Wilmslow SK9 5JD

£875 PCM



## AVAILABLE MID JUNE PART FURNISHED - SOUTH WILMSLOW LOCATION

A spacious ground floor apartment in an established residential area within walking distance of Wilmslow Town Centre and the train station.

Benefitting from off road parking and communal gardens and within easy reach of the train station this one bedroom apartment is always a popular choice.

Communal entrance hall, private entrance hall with storage, lounge with feature fireplace (decorative purposes only) and window overlooking communal gardens, modern fitted kitchen with electric cooker, washing machine, fridge with freezer box and microwave, double bedroom with fitted wardrobes and bathroom with shower over bath.

Communal gardens. Off road parking. Electric heating

Contact Wilmslow 01625 536300 £875.00pcm

EPC E

COUNCIL TAX B



- GROUND FLOOR APARTMENT
- ONE DOUBLE BEDROOM
- SOUTH WILMSLOW LOCATION
- WALKING DISTANCE OF TOWN CENTRE AND TRAIN STATION
- COMMUNAL GARDENS
- OFF ROAD PARKING
- COUNCIL TAX B



Energy Efficiency Rating		
	Current	Potential
Very energy efficient - lower running costs		
(92 plus) <b>A</b>		
(81-91) <b>B</b>		
(69-80) <b>C</b>		
(55-68) <b>D</b>		
(39-54) <b>E</b>		
(21-38) <b>F</b>		
(1-20) <b>G</b>		
Not energy efficient - higher running costs		
	54	65
<b>England &amp; Wales</b>		EU Directive 2002/91/EC 

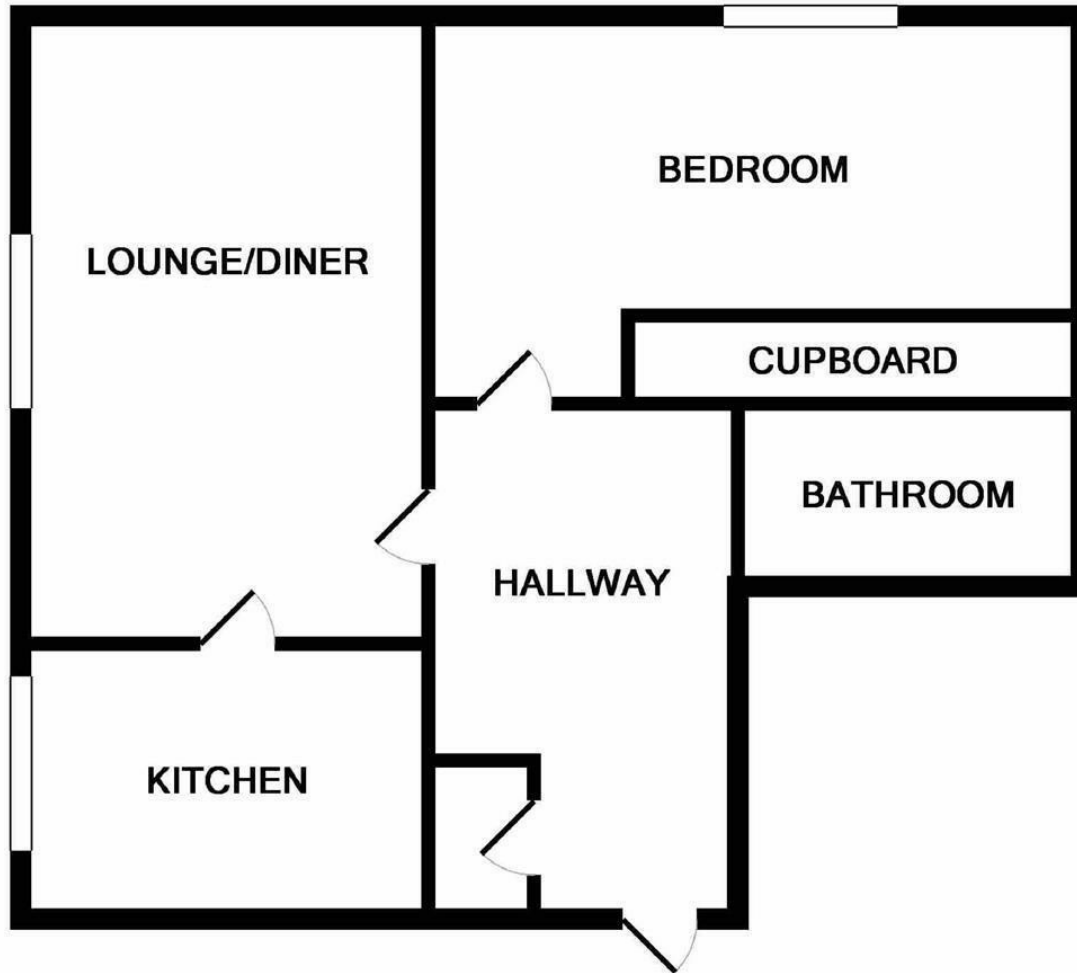

Measurements are approximate. Not to scale. Illustrative purposes only  
Made with Metropix ©2019



These particulars are believed to be accurate but they are not guaranteed and do not form a contract. Neither Jordan Fishwick nor the vendor or lessor accept any responsibility in respect of these particulars, which are not intended to be statements or representations of fact and any intending purchaser or lessee must satisfy himself by inspection or otherwise as to the correctness of each of the statements contained in these particulars. Any floorplans on this brochure are for illustrative purposes only and are not necessarily to scale.

Offices at: Chorlton, Didsbury, Disley, Hale, Glossop, Macclesfield, Manchester Deansgate, Manchester Whitworth Street, New Mills, Sale, Wilmslow and Withington

01625 536300

wilmslow@jordanfishwick.co.uk  
www.jordanfishwick.co.uk