



Jordan fishwick

24 Barford Drive, Wilmslow, SK9 2GB
£1,200 PCM



Barford Drive Cheshire SK9 2GB

£1,200 PCM



The Property

WILMSLOW - PART FURNISHED AVAILABLE END MAY - VIEWING HIGHLY RECOMMENDED

Refurbished and attractive end mews situated on this popular estate close to local shops, the A34 and with good access to the airport and motorway networks.

Comprises of entrance porch, lounge with feature fireplace, dining kitchen with dishwasher gas hob and electric oven washer dryer and doors to rear garden, large double bedroom and small double bedroom with fitted wardrobes modern fitted bathroom with shower over bath.

Garden and driveway providing off road parking for up to 2 cars to the front and private enclosed lawned garden to the rear.

Contact Wilmslow 01625 536300 £1200.00pcm

EPC D

COUNCIL TAX C

- TWO BEDROOMS
- ENCLOSED REAR GARDEN
- POPULAR ESTATE
- CLOSE TO LOCAL SHOPS
- EASY ACCESS TO A34
- COUNCIL TAX C

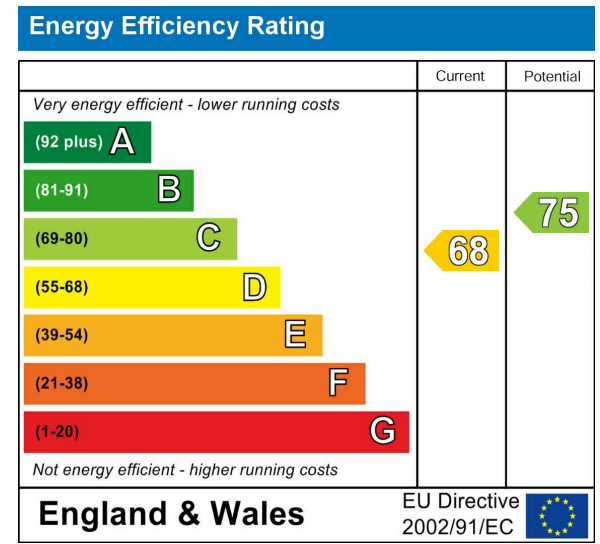

GROUND FLOOR

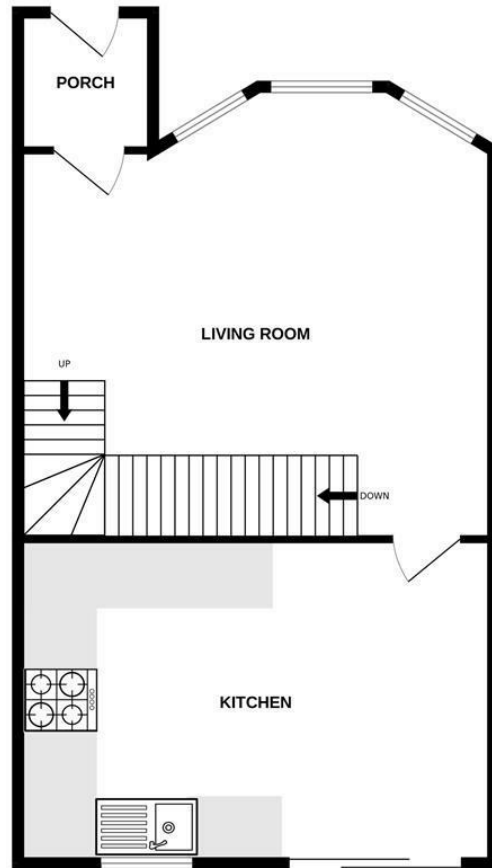

1ST FLOOR

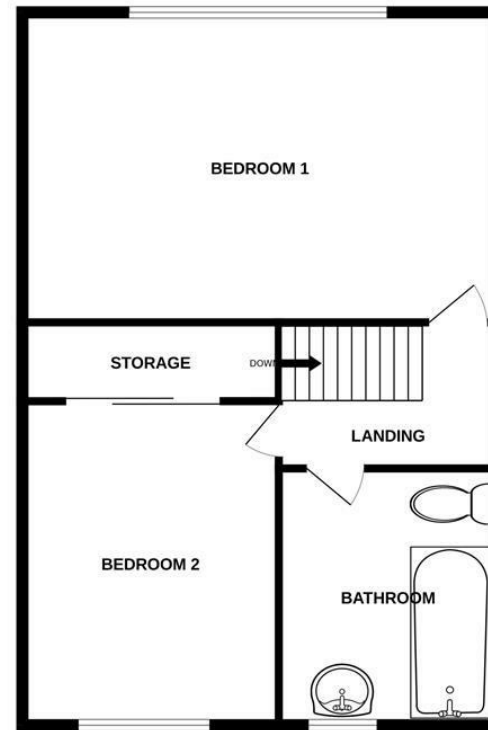

Measurements are approximate. Not to scale. Illustrative purposes only
Made with Metropix ©2024



These particulars are believed to be accurate but they are not guaranteed and do not form a contract. Neither Jordan Fishwick nor the vendor or lessor accept any responsibility in respect of these particulars, which are not intended to be statements or representations of fact and any intending purchaser or lessee must satisfy himself by inspection or otherwise as to the correctness of each of the statements contained in these particulars. Any floorplans on this brochure are for illustrative purposes only and are not necessarily to scale.

Offices at: Offices at Chorlton, Didsbury, Disley, Hale, Glossop, Macclesfield, Manchester Deansgate, Manchester Whitworth Street, New Mills, Sale, Wilmslow and Withington