



Jordan fishwick

DIDSBURY
Spath Road



Spath Road, Didsbury, M20 2QT

Offers Over £950,000



The Property

A unique, four bedroomed, individually designed, detached bungalow located on one of DIDSBURY'S FINEST TREE LINED ROADS, being within a SHORT STROLL of the villages of BOTH DIDSBURY & WEST DIDSBURY, set within large grounds there is redevelopment potential subject to planning approval, or an opportunity to purchase one of only a handful of bungalows in Didsbury. The accommodation comprises to the ground floor: Reception hallway, light and spacious living area with floor to ceiling windows, family/tv room, galley kitchen opening to a magnificent glass conservatory measuring 32ft in length, master bedroom with en suite bathroom, additional study/bedroom 4 and cloakroom/wc. Spiral staircase giving access to the first floor comprising: landing with large walk in eves storage cupboard, two further good size bedrooms and shower room. Externally there is a large paved driveway accessed via secure electric gates, double garage, extensive mature gardens with lawned area to the front and private terraced to the rear of the property. Viewing essential to fully appreciate. No chain.

Directions

M20 2QT



- Detached four bed two bath bungalow
- Prestigious location close to Didsbury village
- Large plot with further potential for rebuild/redevelopment
- Detached double garage & large extensive grounds
- Master bedroom with en suite bathroom
- 32ft glass conservatory to rear
- Excellent condition
- One of only a handful of bungalows in Didsbury

Postcode - M20 2QT

EPC Rating - D

Floor Area - 2419.00 sq ft

Local Authority - Manchester City Council

Council Tax - G



GROUND FLOOR
1758 sq.ft. (163.4 sq.m.) approx.



1ST FLOOR
661 sq.ft. (61.4 sq.m.) approx.

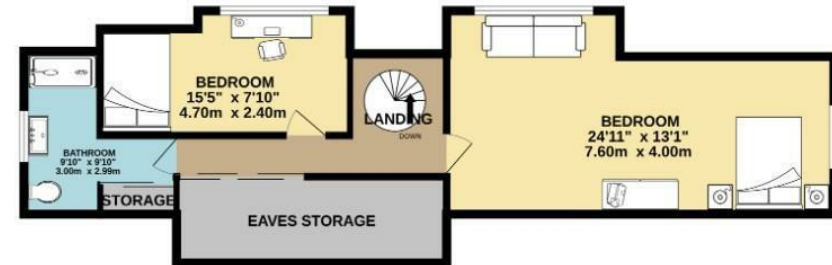

TOTAL FLOOR AREA : 2419 sq.ft. (224.8 sq.m.) approx.
Measurements are approximate. Not to scale. Illustrative purposes only
Made with Metropix ©2024



These particulars are believed to be accurate but they are not guaranteed and do not form a contract. Neither Jordan Fishwick nor the vendor or lessor accept any responsibility in respect of these particulars, which are not intended to be statements or representations of fact and any intending purchaser or lessee must satisfy himself by inspection or otherwise as to the correctness of each of the statements contained in these particulars. Any floorplans on this brochure are for illustrative purposes only and are not necessarily to scale.

Offices also at: Wilmslow, Macclesfield, Hale, Sale, Chorlton, Glossop, Manchester & Salford

757-759 Wilmslow Road, Didsbury Village, Manchester

0161 445 4480

didsbury@jordanfishwick.co.uk
www.jordanfishwick.co.uk