



Jordan fishwick

21 Willaston Close, Chorlton, M21 8BJ
Guide Price £360,000



The Property

A charming TWO BEDROOM MID MEWS property situated within a quiet CUL-DE-SAC JUST A STONES THROW FROM BEECH ROAD. This delightful property is offered for sale in move-in ready condition, having been tastefully updated by the current owners and will prove ideal for a young couple/ first time buyers or buy to let investors alike. The property benefits from both a DRIVEWAY providing off street parking to the front and a well maintained and landscaped garden to the rear. The well planned accommodation briefly comprises: entrance porch, spacious living room, modern fitted dining kitchen with integrated appliances. To the first floor there are two good sized bedrooms and a bathroom with fitted white suite and over bath shower. Gas central heating and double glazing are installed throughout. The property is only a short walk to all local amenities in Chorlton Village and Beech Road as well as the Metro, schools and local amenities. Viewing of this splendid home is highly recommended.

21 Willaston Close, Chorlton, Manchester, M21 8BJ

Guide Price £360,000



- An attractive modern mews property
- Chorlton Green cul-de-sac location
- Gas central heating & double glazing
- Lounge & fitted dining kitchen
- Two good sized bedrooms
- Gardens to front & rear
- Driveway providing off road car parking
- NO CHAIN
- Ideal for a couple or young family
- Offered in excellent order throughout



Energy Efficiency Rating		
	Current	Potential
Very energy efficient - lower running costs		
(92 plus) A		
(81-91) B		88
(69-80) C	69	
(55-68) D		
(39-54) E		
(21-38) F		
(1-20) G		
Not energy efficient - higher running costs		
England & Wales	EU Directive 2002/91/EC	



GROUND FLOOR
321 sq.ft. (29.8 sq.m.) approx.

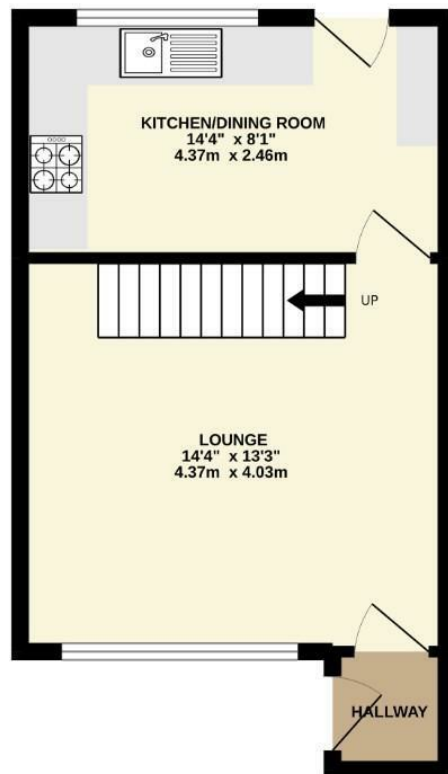

1ST FLOOR
306 sq.ft. (28.4 sq.m.) approx.

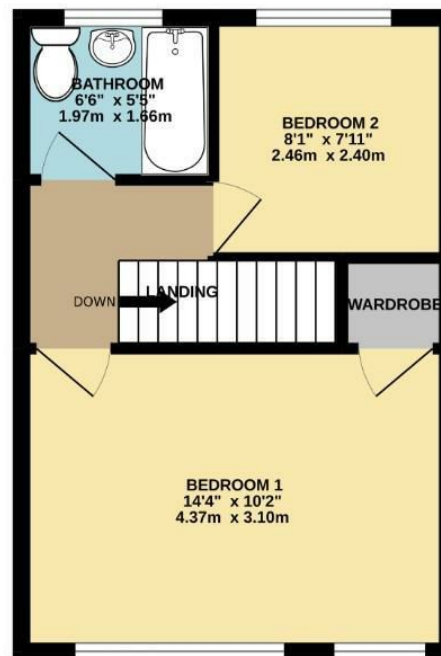

TOTAL FLOOR AREA: 627 sq.ft. (58.2 sq.m.) approx.
Measurements are approximate. Not to scale. Illustrative purposes only
Made with Metropix ©2022



These particulars are believed to be accurate but they are not guaranteed and do not form a contract. Neither Jordan Fishwick nor the vendor or lessor accept any responsibility in respect of these particulars, which are not intended to be statements or representations of fact and any intending purchaser or lessee must satisfy himself by inspection or otherwise as to the correctness of each of the statements contained in these particulars. Any floorplans on this brochure are for illustrative purposes only and are not necessarily to scale.

Offices at: Chorlton, Didsbury, Disley, Hale, Glossop, Macclesfield, Manchester Deansgate, Manchester Whitworth Street, New Mills, Sale, Wilmslow and Withington