



Jordan fishwick

49 Newport Road, M21 9WL
Guide Price £425,000



Newport Road Chorlton M21 9WL

Offers Over £425,000



The Property

A spacious and well presented mid terrace period property of character situated on a most popular road conveniently placed for Chorlton village, the Metrolink and local amenities. Comprises briefly: covered porch, entrance hall, lounge, separate dining room, fitted kitchen. To the first floor there are three well-proportioned bedrooms and a bathroom with a white suite with over bath shower. The property benefits from gas central heating and double glazing. There is a garden to the front of the property and an attractive SOUTH FACING garden to the rear. Viewing is highly recommended. NO CHAIN

- Three Bedroom Mid Terrace Victorian Property
- First Floor Bathroom
- Two Reception Rooms
- Fitted Kitchen
- No Onward Chain
- Short Walk to Metrolink
- South Facing Rear
- Close To Chorlton Village

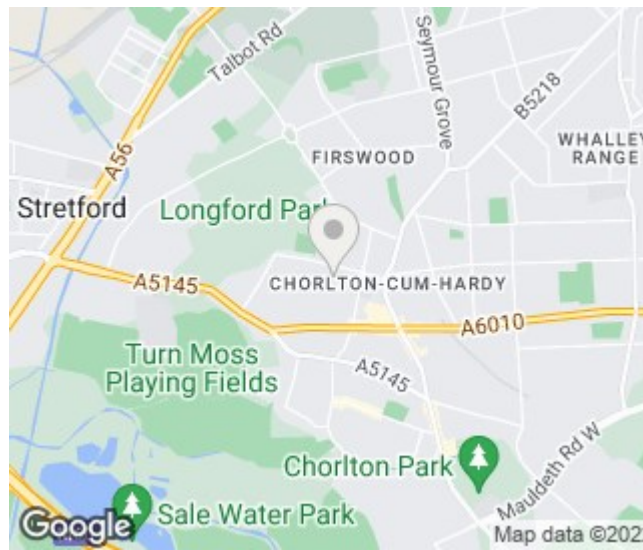

Energy Efficiency Rating		
	Current	Potential
Very energy efficient - lower running costs		
(92 plus) A		
(81-91) B		81
(69-80) C		
(55-68) D	56	
(39-54) E		
(21-38) F		
(1-20) G		
Not energy efficient - higher running costs		
England & Wales	EU Directive 2002/91/EC 	



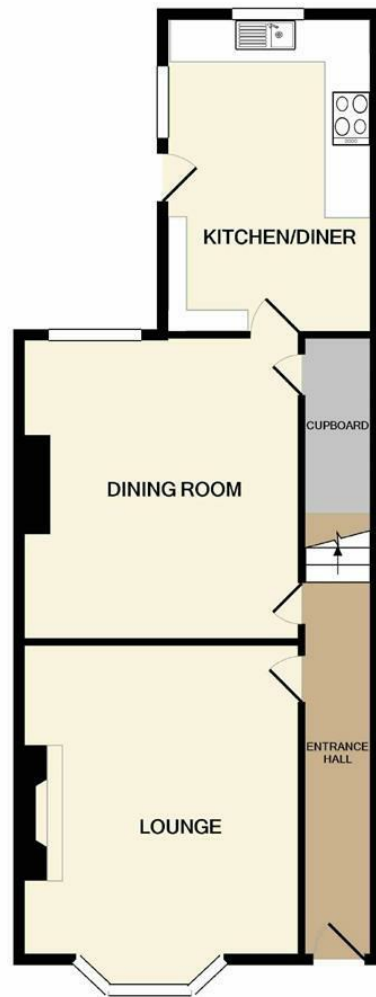

GROUND FLOOR



1ST FLOOR

Measurements are approximate. Not to scale. Illustrative purposes only
 Made with Metropix ©2021



These particulars are believed to be accurate but they are not guaranteed and do not form a contract. Neither Jordan Fishwick nor the vendor or lessor accept any responsibility in respect of these particulars, which are not intended to be statements or representations of fact and any intending purchaser or lessee must satisfy himself by inspection or otherwise as to the correctness of each of the statements contained in these particulars. Any floorplans on this brochure are for illustrative purposes only and are not necessarily to scale.

Offices at: Chorlton, Didsbury, Disley, Hale, Glossop, Macclesfield, Manchester Deansgate, Manchester Whitworth Street, New Mills, Sale, Wilmslow and Withington