



Flat 11 Stamford Court, Stamford Road, Manchester, M13 0SN

Jordan Fishwick are pleased to offer for sale this TWO BEDROOM, TWO BATHROOM flat located on Stamford Road, just a stones throw away from Longsight high street. The apartment is located on the top floor and offers the lucky buyer the chance to make the place their own given a full refurb is required. The flat briefly comprises: porch, hallway, living/dining room, kitchen with storage and airing cupboard, two double bedrooms, master with en-suite and family bathroom. The building has a small communal garden and secure parking. (STAIRS ONLY, NO LIFT). NO ONWARD CHAIN.

Price £130,000

Viewing arrangements

Viewing strictly by appointment through the agent
245 Deansgate, Manchester, M3 4EN 0161 833 9499 opt 3

Entrance Hall

Laminate flooring. Ceiling light. Storage heater.

Living/Dining Room

16'9" x 12'7"

Carpet. Ceiling light. Storage heater.

Kitchen

13'2" x 5'5"

Range of wall and base units with worktops over. Sink with mixer tap. Space for fridge/freezer and cooker. Ceiling light. Pantry cupboard plus airing cupboard.

Master Bedroom

14'3" x 9'5"

Carpet. Ceiling light. Storage heater. Fitted wardrobe.

En-suite

Low level W/C. Sink with 2 tap holes. Shower cubical with electric shower.

Bedroom Two

12'9" x 9'6"

Carpet. Ceiling light. Storage heater. Fitted wardrobe. TV point.

Bathroom

Low level W/C. Sink with 2 tap holes. Bath with electric shower. Velux window.

Externally

Stairs to all floors. Communal garden. Secure parking (unallocated).

Additional Information

Lease - 125 years from 2006

Service charges - £82.68 per quarter

Ground rent - £10 per annum

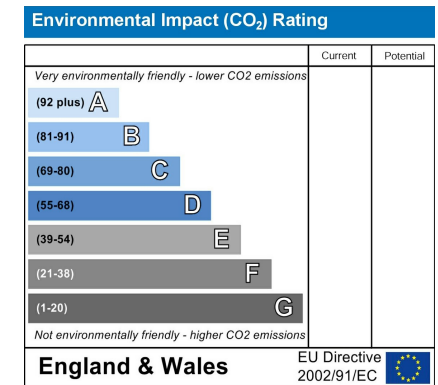
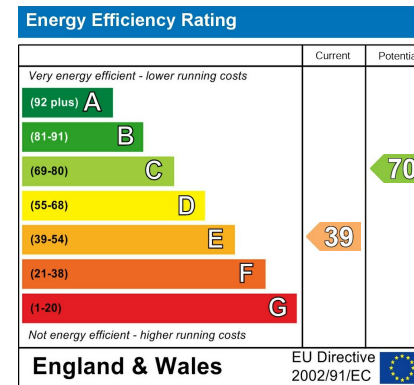



2ND FLOOR

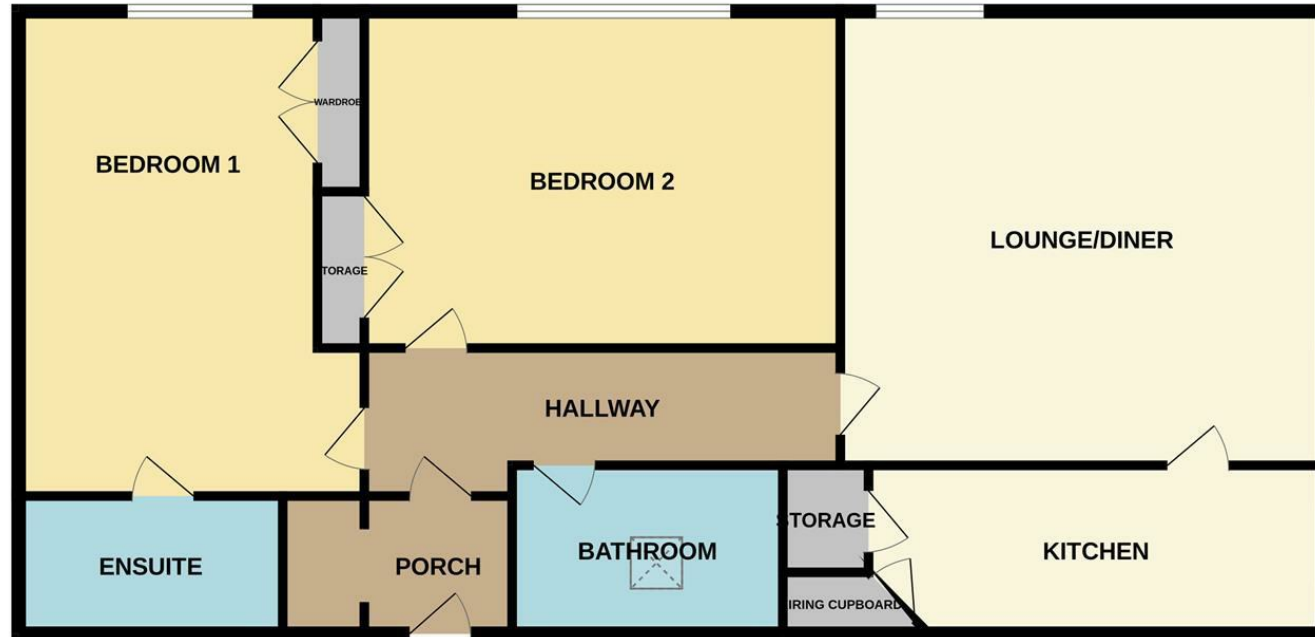

Measurements are approximate. Not to scale. Illustrative purposes only
Made with Metropix ©2024



These particulars are believed to be accurate but they are not guaranteed and do not form a contract. Neither Jordan Fishwick nor the vendor or lessor accept any responsibility in respect of these particulars, which are not intended to be statements or representations of fact and any intending purchaser or lessee must satisfy himself by inspection or otherwise as to the correctness of each of the statements contained in these particulars. Any floorplans on this brochure are for illustrative purposes only and are not necessarily to scale.

Offices at: Chorlton, Didsbury, Disley, Hale, Glossop, Macclesfield, Manchester Deansgate, Manchester Whitworth Street, New Mills, Sale, Wilmslow and Withington

245 Deansgate, Manchester, M3 4EN

0161 833 9499 opt 3

manchester@jordanfishwick.co.uk

www.jordanfishwick.co.uk

