



jordan fishwick

Redhouse Lane Disley Stockport



Redhouse Lane Disley Stockport SK12 2HP

£229,950



The Property

Within 1/2 a mile of Disley Village and railway station, a charming two bedroom terraced property. Backing onto a paddock, enjoying open forward views towards Hague Bar and in a most sought after location. Pvc double glazing, gas central heating with new boiler and comprising: living room, fitted kitchen, two good sized first floor bedrooms (smallest 11'7 x 7'3) and a bathroom with white suite. Rear patio open to a delightful, large communal garden. Ideal for the first time buyer or buy to let investor. Close to the Peak Forest Canal, No Chain and Viewing highly recommended.



- Superb Location
- Well Presented
- Open Views and Backing onto Fields
- Pvc Double Glazing and Gas Central Heating
- Ideal for the First Time Buyer or Buy to Let Investor
- Paved Patio Area and Well Maintained Communal Garden
- Two Good Size Bedrooms

Postcode SK12 2HP

EPC Rating C

Local Authority Cheshire East

Council Tax B

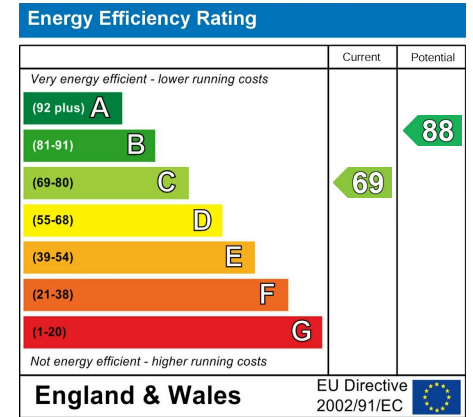

GROUND FLOOR

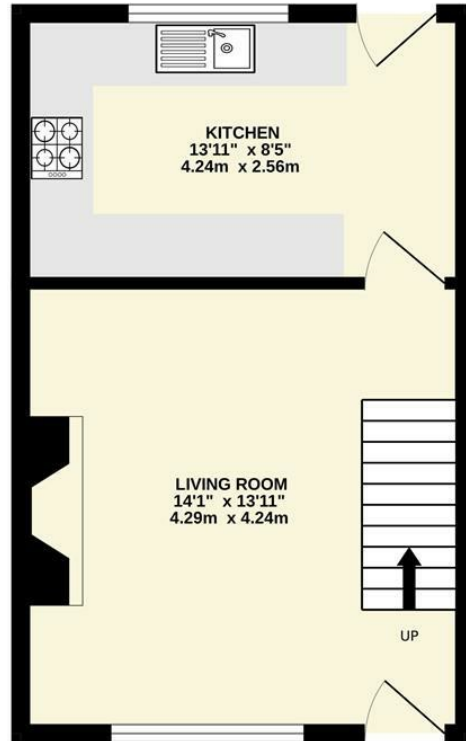

1ST FLOOR

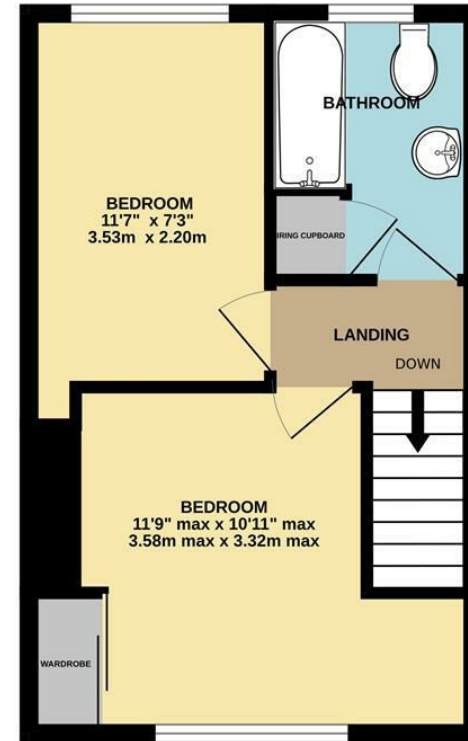

Whilst every attempt has been made to ensure the accuracy of the floorplan contained here, measurements of doors, windows, rooms and any other items are approximate and no responsibility is taken for any error, omission or mis-statement. This plan is for illustrative purposes only and should be used as such by any prospective purchaser. The services, systems and appliances shown have not been tested and no guarantee as to their operability or efficiency can be given.
Made with Metropix ©2024



These particulars are believed to be accurate but they are not guaranteed and do not form a contract. Neither Jordan Fishwick nor the vendor or lessor accept any responsibility in respect of these particulars, which are not intended to be statements or representations of fact and any intending purchaser or lessee must satisfy himself by inspection or otherwise as to the correctness of each of the statements contained in these particulars. Any floorplans on this brochure are for illustrative purposes only and are not necessarily to scale.

Offices at: Chorlton, Didsbury, Disley, Hale, Glossop, Macclesfield, Manchester Deansgate, Manchester Whitworth Street, New Mills, Sale, Wilmslow and Withington

14 Market Street, Disley, Cheshire, SK12 2AA

01663 76 78 78

disley@jordanfishwick.co.uk

www.jordanfishwick.co.uk