



Jordan fishwick

Manchester Road
Chorlton



Manchester Road Chorlton M21 9JG

£825 Per Calendar Month



The Property

***AVAILABLE NOW *** A bright and spacious studio apartment in a converted period property with separate large newly fitted kitchen with new oven, entrance hall, bathroom with three piece suite including electric shower over bath and a spacious lounge/bedroom. Positioned in the heart of Chorlton a short walk to the ever popular Beech Road & Chorlton Green offering all amenities with a superb choice of bars and restaurants. Benefits include gas fired central heating. Double glazed throughout with private parking to the rear of the property. The accommodation comprises briefly: entrance hall, good sized lounge/bedroom, Kitchen, bathroom with a three piece white suite and over bath shower. Property is offered as unfurnished.

***** To arrange a viewing call
0161 393 7539 *****

Directions

- Available Now
- Large open plan studio apartment
- Separate large newly fitted kitchen
- Off road parking
- large bathroom
- Chorlton Green location
- Council Tax Band A

Postcode - M21 9JG

EPC Rating - C

Floor Area - sq ft

Local Authority - Manchester

Council Tax - A

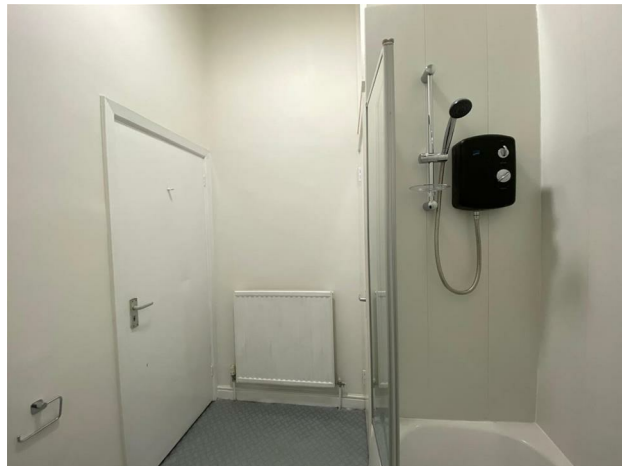

GROUND FLOOR
380 sq.ft. (35.3 sq.m.) approx.

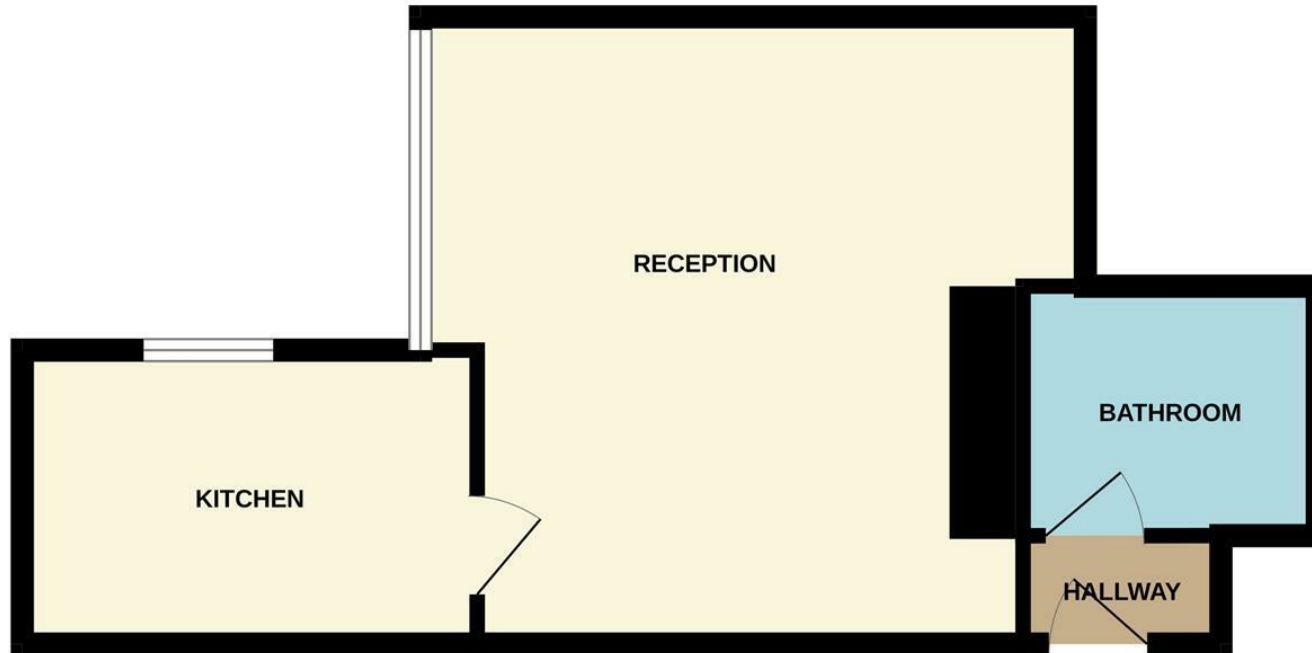

TOTAL FLOOR AREA : 380 sq.ft. (35.3 sq.m.) approx.

Whilst every attempt has been made to ensure the accuracy of the floorplan contained here, measurements of doors, windows, rooms and any other items are approximate and no responsibility is taken for any error, omission or mis-statement. This plan is for illustrative purposes only and should be used as such by any prospective purchaser. The services, systems and appliances shown have not been tested and no guarantee as to their operability or efficiency can be given.
Made with Metropix ©2024



These particulars are believed to be accurate but they are not guaranteed and do not form a contract. Neither Jordan Fishwick nor the vendor or lessor accept any responsibility in respect of these particulars, which are not intended to be statements or representations of fact and any intending purchaser or lessee must satisfy himself by inspection or otherwise as to the correctness of each of the statements contained in these particulars. Any floorplans on this brochure are for illustrative purposes only and are not necessarily to scale.

Offices at: Offices at Chorlton, Didsbury, Disley, Hale, Glossop, Macclesfield, Manchester Deansgate, Manchester Whitworth Street, New Mills, Sale, Wilmslow and Withington

410-412 Barlow Moor Road, Chorlton, Manchester, M21
8AD

www.jordanfishwick.co.uk