



jordan fishwick

Chadkirk Cottages, Vale Road Romiley

Chadkirk Cottages, Vale Road Romiley Stockport SK6 3LE

£230,000



The Property

Situated in a lovely semi rural location close to the River Goyt and Chadkirk Estate Country Park, a brick built mid terraced cottage. Potential to alter and improve together with No Chain. Pvc double glazing, gas central heating and comprising: living room, dining kitchen, two first floor bedrooms and a bathroom with white suite. Enclosed paved garden with brick store. Convenient yet quiet position. *** PHOTOS COMING SOON - VIEWINGS TO COMMENCE 25th MARCH ONWARDS***



- Convenient and Quiet Location
- Brick Built Mid Terrace
- Two Bedrooms
- No Chain
- Close to Chadkirk Estate Country Park
- Pvc Double Glazing
- Gas Central Heating
- Paved Garden with Store

Postcode SK6 3LE

EPC Rating D

Local Authority Stockport

Council Tax C

Energy Efficiency Rating		Current	Potential
Very energy efficient - lower running costs			
(92 plus) A			
(81-91) B			85
(69-80) C		65	
(55-68) D			
(39-54) E			
(21-38) F			
(1-20) G			
Not energy efficient - higher running costs			
England & Wales		EU Directive 2002/91/EC 	



GROUND FLOOR

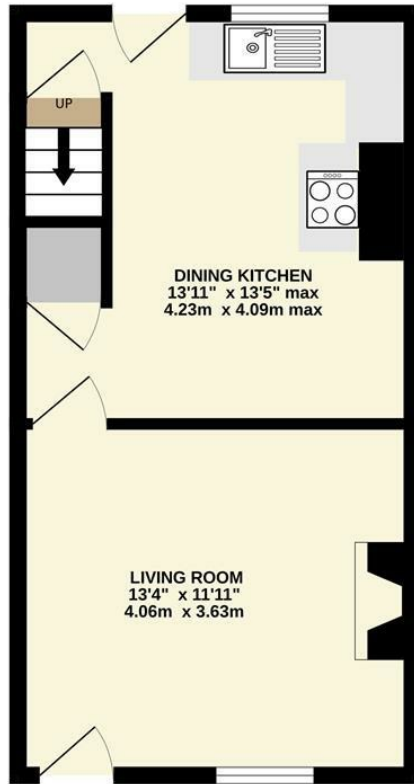

1ST FLOOR

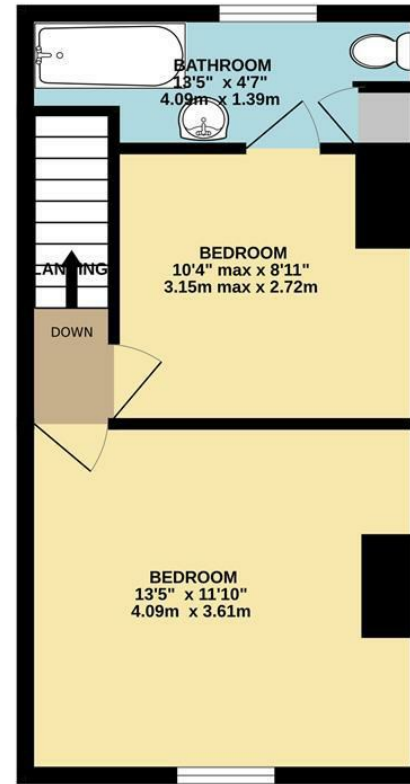

Whilst every attempt has been made to ensure the accuracy of the floorplan contained here, measurements of doors, windows, rooms and any other items are approximate and no responsibility is taken for any error, omission or mis-statement. This plan is for illustrative purposes only and should be used as such by any prospective purchaser. The services, systems and appliances shown have not been tested and no guarantee as to their operability or efficiency can be given.
Made with Metopix ©2024



These particulars are believed to be accurate but they are not guaranteed and do not form a contract. Neither Jordan Fishwick nor the vendor or lessor accept any responsibility in respect of these particulars, which are not intended to be statements or representations of fact and any intending purchaser or lessee must satisfy himself by inspection or otherwise as to the correctness of each of the statements contained in these particulars. Any floorplans on this brochure are for illustrative purposes only and are not necessarily to scale.

Offices at: Chorlton, Didsbury, Disley, Hale, Glossop, Macclesfield, Manchester Deansgate, Manchester Whitworth Street, New Mills, Sale, Wilmslow and Withington

14 Market Street, Disley, Cheshire, SK12 2AA

01663 76 78 78

disley@jordanfishwick.co.uk

www.jordanfishwick.co.uk