



*jordan fishwick*

WITHINGTON  
Farrington Avenue



# Farrington Avenue, Withington, M20 1ER

£240,000



## The Property

A traditional semi detached property, **NEEDING SOME UPDATING**, situated in a popular residential area off Burton road with easy access to West Didsbury, offering an excellent range of amenities including Metro station, popular bars and restaurants. With spacious and light accommodation for a couple or growing family. The accommodation comprises: Entrance hall, lounge, kitchen and downstairs cloakroom/wc. To the first floor there are three good size bedrooms and a bathroom with white suite and chrome fittings. To the front of the property there is residents parking, whilst to the rear there is a garden. Double glazing and gas central heating complete the specification Viewing recommended. No chain.

## Directions

M20 1ER



- Three bedroom semi detached property
- In need of some updating
- Cul de sac location close to Withington village & West Didsbury
- Garden to rear
- Downstairs wc
- No chain
- Residents parking to the front

Postcode - M20 1ER

EPC Rating - E

Floor Area - 815.00 sq ft

Local Authority - Manchester City Council

Council Tax - A



GROUND FLOOR  
407 sq.ft. (37.9 sq.m.) approx.

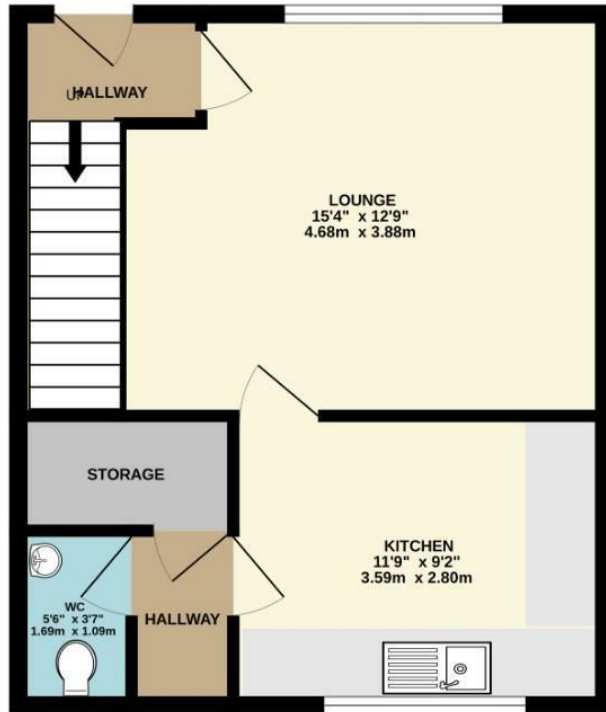

1ST FLOOR  
407 sq.ft. (37.9 sq.m.) approx.

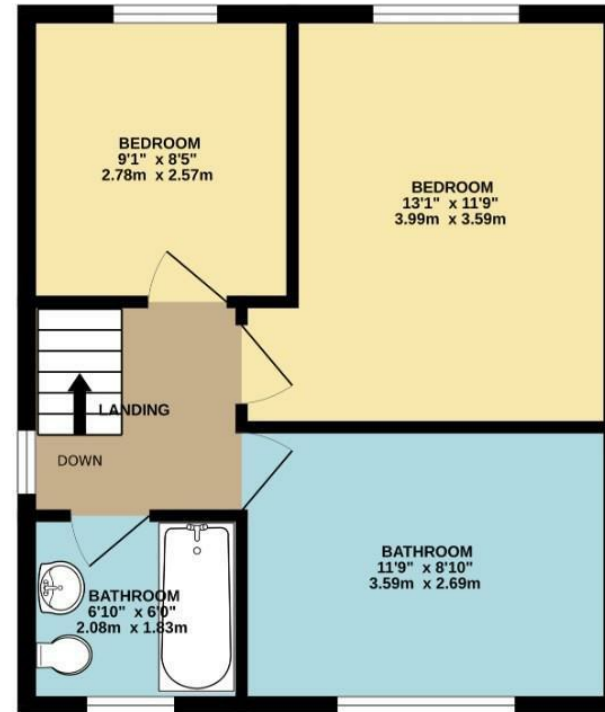

TOTAL FLOOR AREA : 815 sq.ft. (75.7 sq.m.) approx.  
Measurements are approximate. Not to scale. Illustrative purposes only  
Made with Metropix ©2023



These particulars are believed to be accurate but they are not guaranteed and do not form a contract. Neither Jordan Fishwick nor the vendor or lessor accept any responsibility in respect of these particulars, which are not intended to be statements or representations of fact and any intending purchaser or lessee must satisfy himself by inspection or otherwise as to the correctness of each of the statements contained in these particulars. Any floorplans on this brochure are for illustrative purposes only and are not necessarily to scale.

Offices also at: Wilmslow, Macclesfield, Hale, Sale, Chorlton, Glossop, Manchester & Salford

757-759 Wilmslow Road, Didsbury Village, Manchester

0161 445 4480

didsbury@jordanfishwick.co.uk  
www.jordanfishwick.co.uk