



Jordan fishwick

Buxton Road Furness Vale High Peak

Buxton Road Furness Vale High Peak SK23 7PQ

£237,500



The Property

Arranged over four floors in popular Furness Vale, a deceptively spacious stone built end of terrace. Convenient position for the railway station and boasting off road parking and low maintenance rear garden, this immaculately presented property is guaranteed to impress. Pvc double glazing, gas central heating and comprising: entrance vestibule, living room, dining kitchen, two first floor double bedrooms, bathroom, second floor attic room and a lower ground floor basement/utility. A real gem of a property. Viewing highly recommended.



- Two Double Bedrooms Plus Large Loft Room
- Close to Furness Vale Railway Station
- Arranged Over Four Floors
- Stone Built End Terrace
- Off Road Parking
- Low Maintenance Garden
- Fine Rear Views
- Immaculately Presented

Postcode SK23 7PQ

EPC Rating D

Local Authority High Peak

Council Tax B

Energy Efficiency Rating		Current	Potential
Very energy efficient - lower running costs			
(92 plus) A			
(81-91) B			79
(69-80) C			
(55-68) D		57	
(39-54) E			
(21-38) F			
(1-20) G			
Not energy efficient - higher running costs			
England & Wales		EU Directive 2002/91/EC 	



BASEMENT

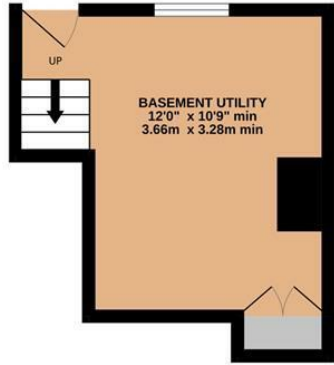

GROUND FLOOR

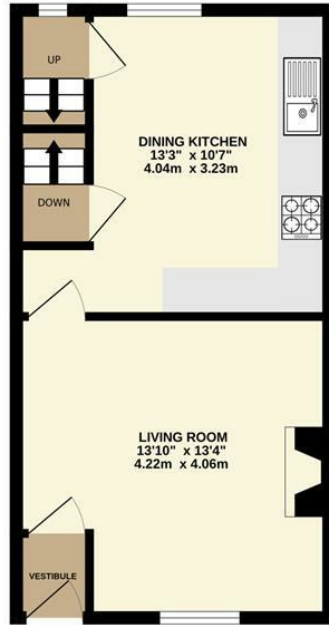

1ST FLOOR



2ND FLOOR

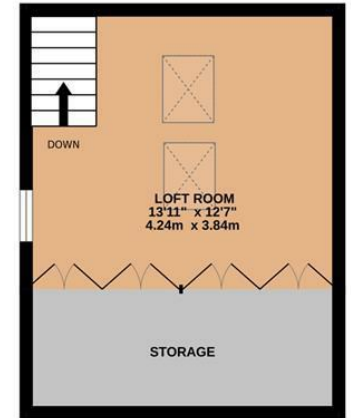

Whilst every attempt has been made to ensure the accuracy of the floorplan contained here, measurements of doors, windows, rooms and any other items are approximate and no responsibility is taken for any error, omission or mis-statement. This plan is for illustrative purposes only and should be used as such by any prospective purchaser. The services, systems and appliances shown have not been tested and no guarantee as to their operability or efficiency can be given.
Made with Metropix ©2024



These particulars are believed to be accurate but they are not guaranteed and do not form a contract. Neither Jordan Fishwick nor the vendor or lessor accept any responsibility in respect of these particulars, which are not intended to be statements or representations of fact and any intending purchaser or lessee must satisfy himself by inspection or otherwise as to the correctness of each of the statements contained in these particulars. Any floorplans on this brochure are for illustrative purposes only and are not necessarily to scale.

Offices at: Chorlton, Didsbury, Disley, Hale, Glossop, Macclesfield, Manchester Deansgate, Manchester Whitworth Street, New Mills, Sale, Wilmslow and Withington

14 Market Street, Disley, Cheshire, SK12 2AA

01663 76 78 78

disley@jordanfishwick.co.uk

www.jordanfishwick.co.uk