



jordan fishwick

Apt 6 Brook House, 64 Ellesmere Street,
£935 Per Calendar Month



Brook House Castlefield M15 4QS

£935 Per Calendar Month



The Property

Available Early May. This ground floor furnished one bedroom apartment has entrance hall with storage cupboard, spacious living/kitchen which comes with fridge/freezer, oven, hob and extractor, breakfast bar and laminate flooring. The large bedroom is very generous. Three piece bathroom suite with shower attachment. Wet electric heating and double glazing. EPC Rating B. Tax Band C. No Parking. On Site Caretaker.

VIDEO/ PHOTO OFFERS NOT ACCEPTED - PLEASE BOOK AN IN PERSON VIEWING

- Available Early May
- Ground Floor One Bedroom Apartment
- Large Bedroom
- No Parking
- Castlefield Location
- Tax Band C
- Close to City Centre
- EPC Rating B



Energy Efficiency Rating		
	Current	Potential
Very energy efficient - lower running costs		
(92 plus) A		
(81-91) B	84	84
(69-80) C		
(55-68) D		
(39-54) E		
(21-38) F		
(1-20) G		
Not energy efficient - higher running costs		
England & Wales	EU Directive 2002/91/EC 	



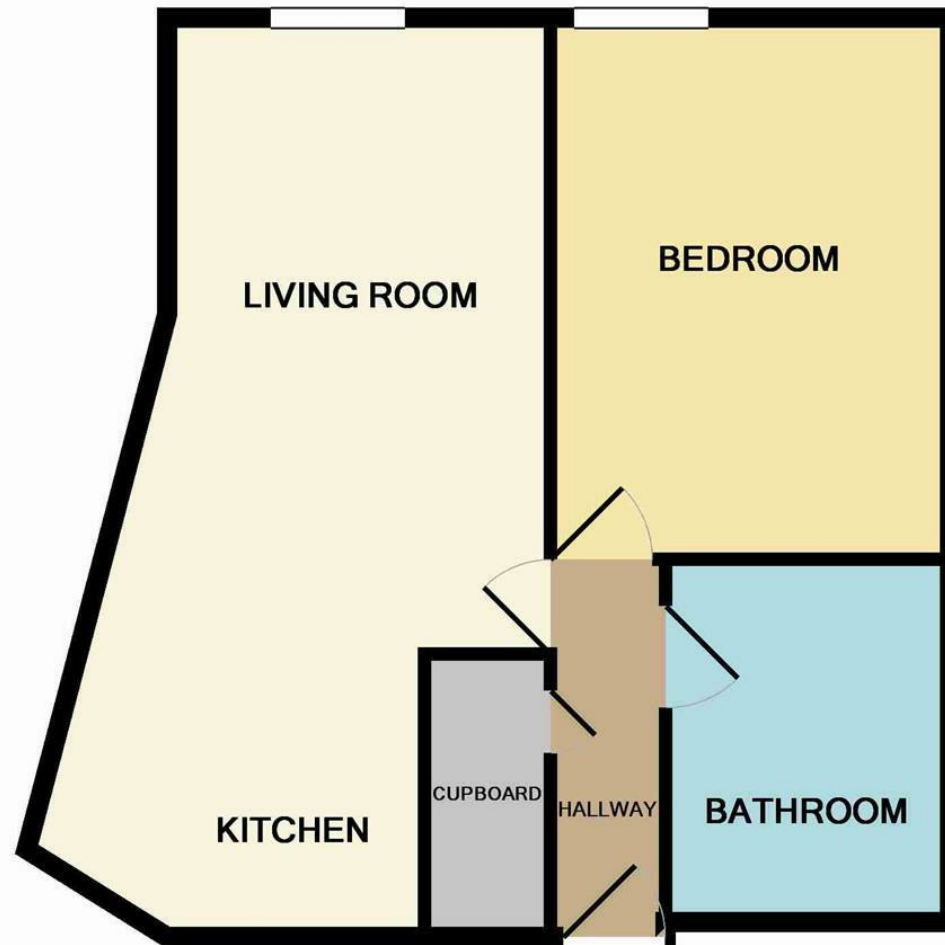

Measurements are approximate. Not to scale. Illustrative purposes only
Made with Metropix ©2014