



*jordan fishwick*

Apt 503 Emmeline Tower, Dalton Street,  
£1,100 Per Calendar Month





## Emmeline Tower Manchester. M40 7EB

£1,100 Per Calendar Month

### The Property

Available Early April. Jordan Fishwick are delighted to offer this fifth floor, two DOUBLE bedroom apartment in this popular Urban Splash development, located just a short walk from Arndale Centre, Northern Quarter and Shudehill. Featuring secure entry systems and GATED PARKING, the apartment briefly comprises of open plan living/ kitchen space benefits from a corner aspect and storage, two double bedrooms and a stylish bathroom. Furnished. Council Tax Band A. 716 sq ft. Council Tax Band A. EPC rating D.

**\*VIDEO/ PHOTO OFFERS ARE NOT ACCEPTED - PLEASE CALL TO BOOK A VIEWING\***





- LET AGREED
- 5th Floor Apartment
- Two Double Bedrooms
- Fully Furnished
- Close to Transport Links
- Gated Parking
- EPC rating D
- Council Tax Band A
- Close to City Centre



Energy Efficiency Rating		
	Current	Potential
Very energy efficient - lower running costs		
(92 plus) <b>A</b>		
(81-91) <b>B</b>		
(69-80) <b>C</b>		<b>74</b>
(55-68) <b>D</b>	<b>62</b>	
(39-54) <b>E</b>		
(21-38) <b>F</b>		
(1-20) <b>G</b>		
Not energy efficient - higher running costs		
<b>England &amp; Wales</b>	EU Directive 2002/91/EC	



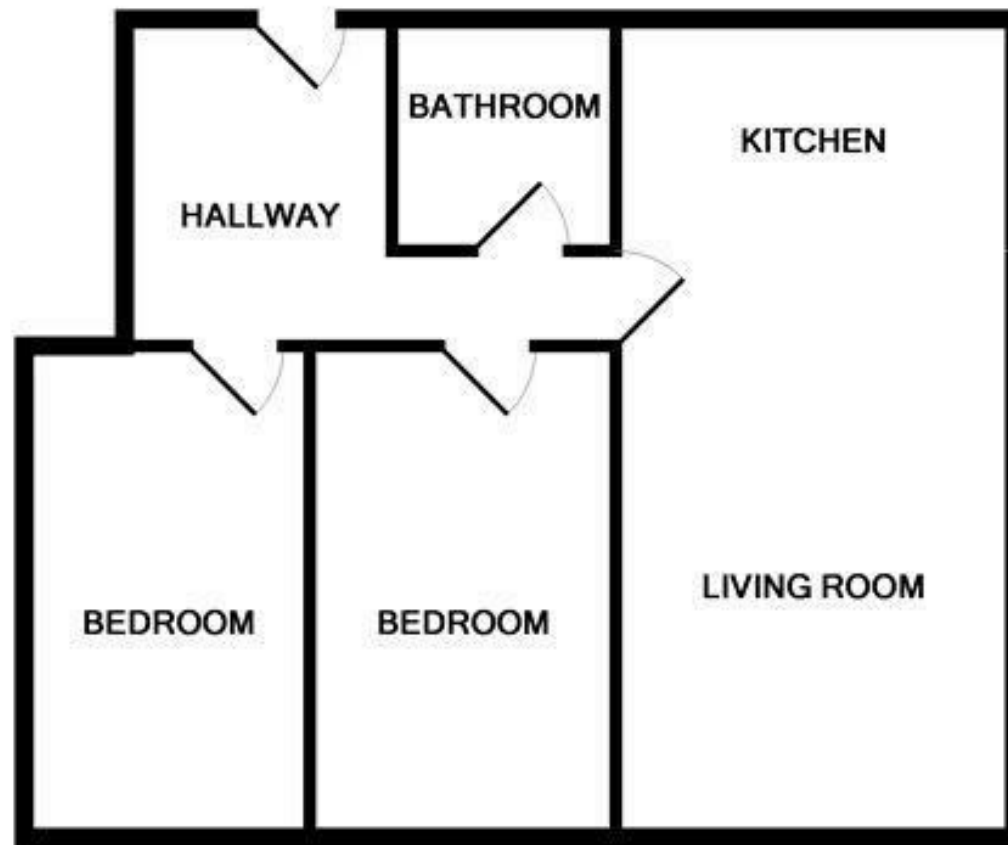

Whilst every attempt has been made to ensure the accuracy of the floor plan contained here, measurements of doors, windows, rooms and any other items are approximate and no responsibility is taken for any error, omission, or mis-statement. This plan is for illustrative purposes only and should be used as such by any prospective purchaser. The services, systems and appliances shown have not been tested and no guarantee as to their operability or efficiency can be given

Made with Metropix ©2008