



jordan fishwick

Chapel Street Hayfield High Peak



Chapel Street Hayfield High Peak SK22 2JJ

Price £235,000



The Property

Immaculately presented and located in the popular Village of Hayfield, a stunning stone built, two double bedroom terraced cottage. Close to the Sett Valley Trail this delightful cottage boasts an inglenook fireplace wood burning stove, stripped beams and is decorated to a high standard. Comprising: living room, modern dining kitchen, two double first floor bedrooms and bathroom. Enclosed rear garden with stone paving and raised beds, gated access to a larger communal garden with stone storage shed. Viewing highly recommended and no onward chain.



- Beautifully Presented on No Onward Chain
- Two Double Bedrooms
- Popular Hayfield Location
- Inglenook Fireplace with Wood Burning Stove
- Modern Dining Kitchen
- Enclosed Private Garden
- Plantation shutters
- Modern Bathroom Suite

Postcode SK22 2JJ

EPC Rating C

Local Authority High Peak

Council Tax B

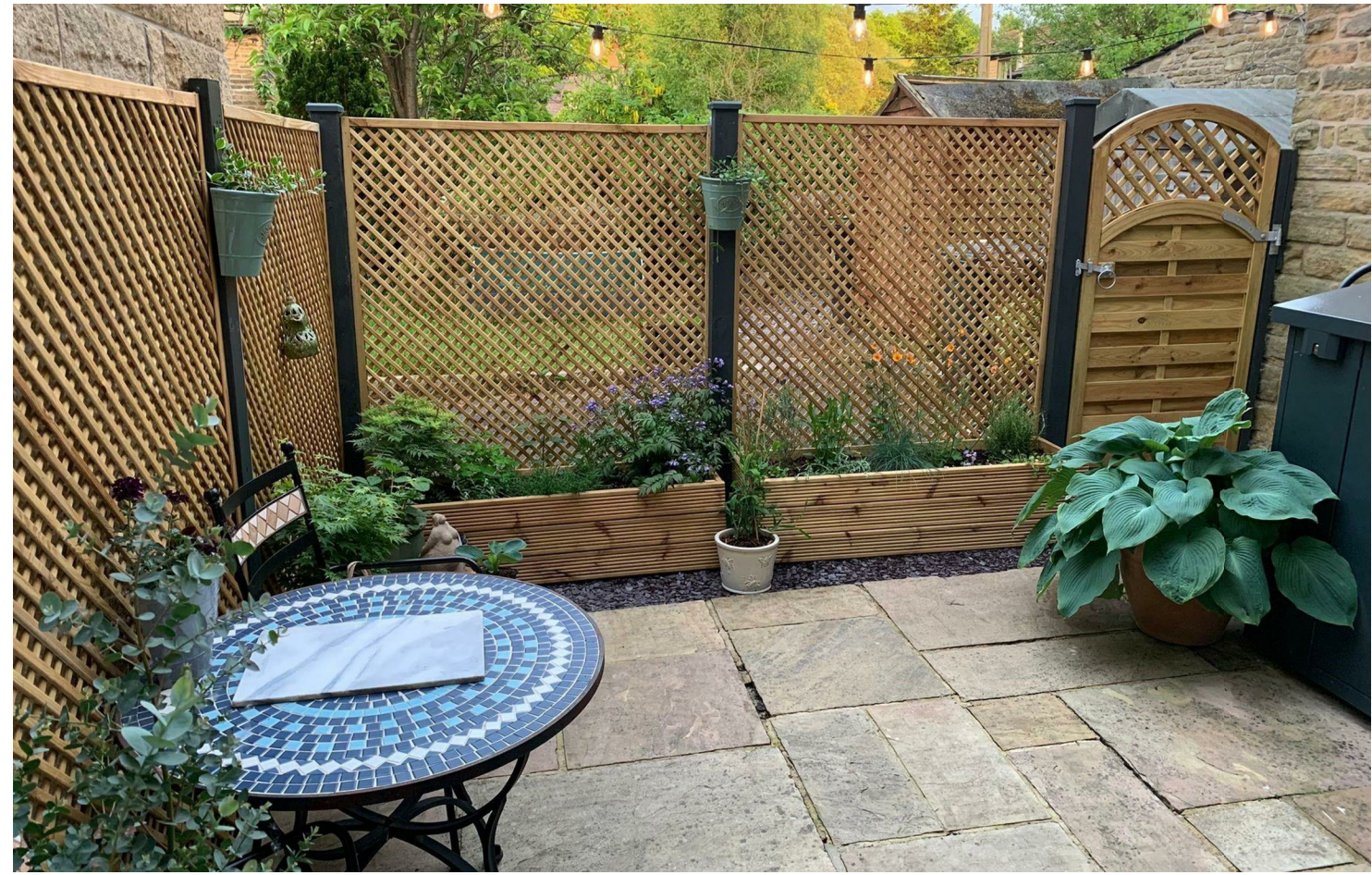
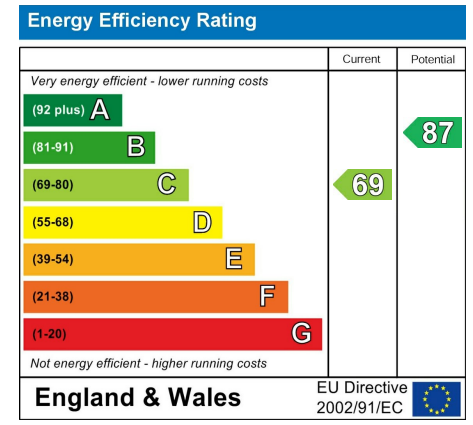

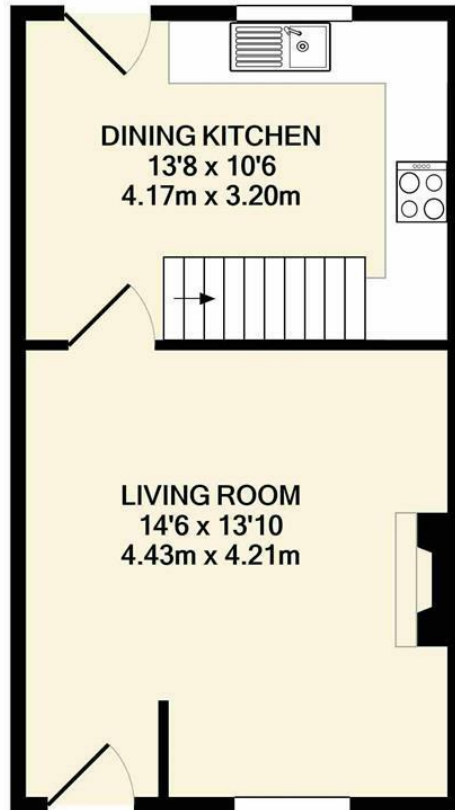

GROUND FLOOR

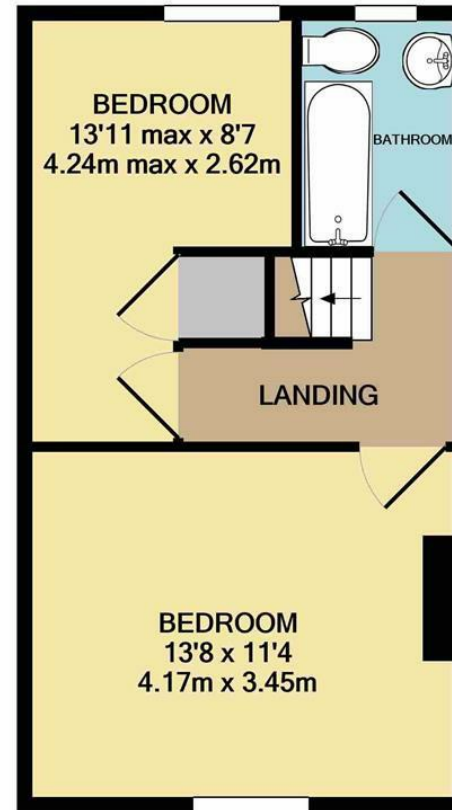

1ST FLOOR

Whilst every attempt has been made to ensure the accuracy of the floor plan contained here, measurements of doors, windows, rooms and any other items are approximate and no responsibility is taken for any error, omission, or mis-statement. This plan is for illustrative purposes only and should be used as such by any prospective purchaser. The services, systems and appliances shown have not been tested and no guarantee as to their operability or efficiency can be given
Made with Metropix ©2022



These particulars are believed to be accurate but they are not guaranteed and do not form a contract. Neither Jordan Fishwick nor the vendor or lessor accept any responsibility in respect of these particulars, which are not intended to be statements or representations of fact and any intending purchaser or lessee must satisfy himself by inspection or otherwise as to the correctness of each of the statements contained in these particulars. Any floorplans on this brochure are for illustrative purposes only and are not necessarily to scale.

Offices at: Chorlton, Didsbury, Disley, Hale, Glossop, Macclesfield, Manchester Deansgate, Manchester Whitworth Street, New Mills, Sale, Wilmslow and Withington

2 Union Road, New Mills, High Peak, Derbyshire, SK22 3ES

newmillsforward@jordanfishwick.co.uk

www.jordanfishwick.co.uk